

CA 89- roof

12/88 (old parcel #) new parcel # 7/89 P.S. (C)

STATE OF FLORIDA
DEPARTMENT OF STATE
Division of Archives, History
and Records Management
DS-HSP-3AAA Rev. 3-79

FLORIDA MASTER SITE FILE Site Inventory Form

FDAHRM 802 ==
1009 ==
820 ==
905 ==

Site Name MacKay, Alfred House 830 == Site No. (53252) 28353-004-00
Address of Site: 1027 S.E. 5th St. Survey Date 8303
Instruction for locating 1027 S.E 5th St.
Ocala, Fla. 32671 813 ==
Location: Dunns Highland Park Ad, E. 141' of Lot D & S. 33' of the 868 ==
subdivision name block no. lot no.
County: Marion 808 ==
Owner of Site: Name: ~~Drake, Dalton~~ WILKERSON, JAMES ;
Address: 1027 S.E. 5th St. 902 ==
Ocala, Fla. 32671 832 ==
Type of Ownership Private 848 == Recording Date _____
Recorder: _____
Name & Title: _____
Address: _____ 818 ==

Condition of Site: Integrity of Site: Original Use Residence 838 ==
Check One Check One or More Present Use Residence 850 ==
 Excellent 863 == Altered 858 ==
 Good 863 == Unaltered 858 ==
 Fair 863 == Original Site 858 ==
 Deteriorated 863 == Restored () (Date: X) 858 ==
 Moved () (Date: X) 858 ==
Building 916 ==

NR Classification Category: _____
Threats to Site: Check One or More
 Zoning (X) 878 == Transportation (X) 878 ==
 Development (X) 878 == Fill (X) 878 ==
 Deterioration (X) 878 == Dredge (X) 878 ==
 Borrowing (X) 878 ==
 Other (See Remarks Below): 878 ==
Areas of Significance: Architecture 910 ==

Significance:
This large stucco residence is an excellent example of Mediterranean Revival in this area. It is in Dunns Highland Park Ad platted in 1886 and first appears on the Sanborn Map of 1930. Alfred MacKay with his three brothers established George MacKay & Co. in the 1890's. It was Ocala's largest mercantile-hardware store including a complete undertaking and embalming department.
1027 S.E. 5th
(91, 81) 11/14/88
911 ==

Following: Begin at point 5' E. of SE Cor. of Lot 1 Buckalew Park; thence S. 40'; thence W. 162.5' to POB 141' W. of E. Bdy. of Lot D as extended N. Highlands Park; thence N. 40' E. 162.5' to POB.

ARCHITECT _____ 872 = =
 BUILDER _____ 874 = =
 STYLE AND/OR PERIOD Mediterranean Revival 964 = =
 PLAN TYPE "T" shape 966 = =
 EXTERIOR FABRIC(S) Stucco rusticated 854 = =
 STRUCTURAL SYSTEM(S) Masonry 856 = =
 PORCHES _____ 942 = =
 FOUNDATION: Continuous masonry 942 = =
 ROOF TYPE: Hip 942 = =
 SECONDARY ROOF STRUCTURE(S): _____ 942 = =
 CHIMNEY LOCATION: End exterior 942 = =
 WINDOW TYPE: 6/6 & 6/1 DSH 942 = =
 CHIMNEY: Masonry 882 = =
 ROOF SURFACING: Spanish tile 882 = =
 ORNAMENT EXTERIOR: Columns set into wall 882 = =
 NO. OF CHIMNEYS One 952 = = NO. OF STORIES Two 950 = =
 NO. OF DORMERS _____ 954 = =
 Map Reference (incl. scale & date) _____ 809 = =
 Latitude and Longitude: _____ 800 = =
 Site Size (Approx. Acreage of Property): _____ 833 = =

S.E. 10th Ave.

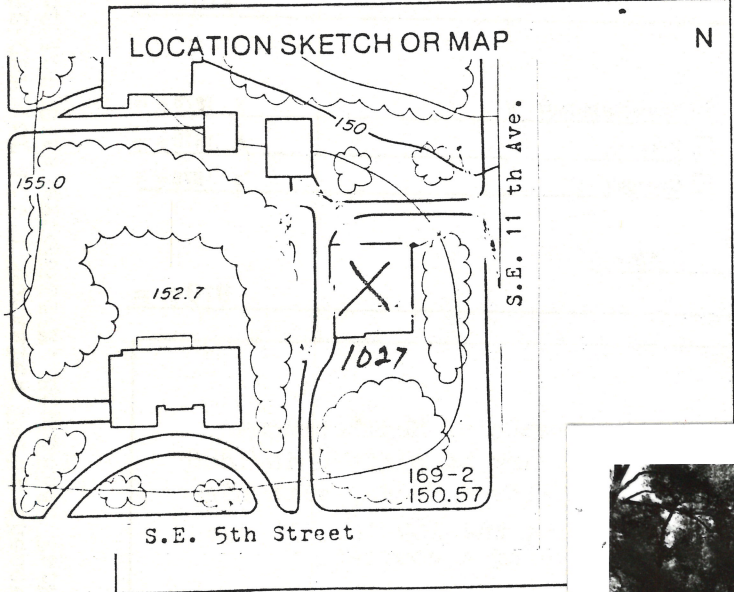

Township	Range	Section	
15S	22E	SE1/4 17	812 = =

UTM Coordinates: _____ 890 = =

Zone Easting Northing

Photographic Records Numbers
83N41#7(18,19)

Contact Print

