

MINIMUM REQUIRED VISIBILITY STANDARD FOR MAKING PRINTS & COPIES

0%
17%
34%
51%
68%
85%
100%

- WATER / SEWER DATA: (per Chapter 62F-6 F.A.C.)**
- AVERAGE DAILY WATER DEMAND: (59 APARTMENTS AND OFFICE) 9,288 GALLONS PER DAY. (POTABLE)
 - AVERAGE DAILY SEWER DEMAND: 7,594 GALLONS PER DAY
 - AVERAGE DAILY IRRIGATION DEMAND: 370 GALLONS PER DAY
 - AVERAGE DAILY REUSE WATER DEMAND: 0 (NOT USED)

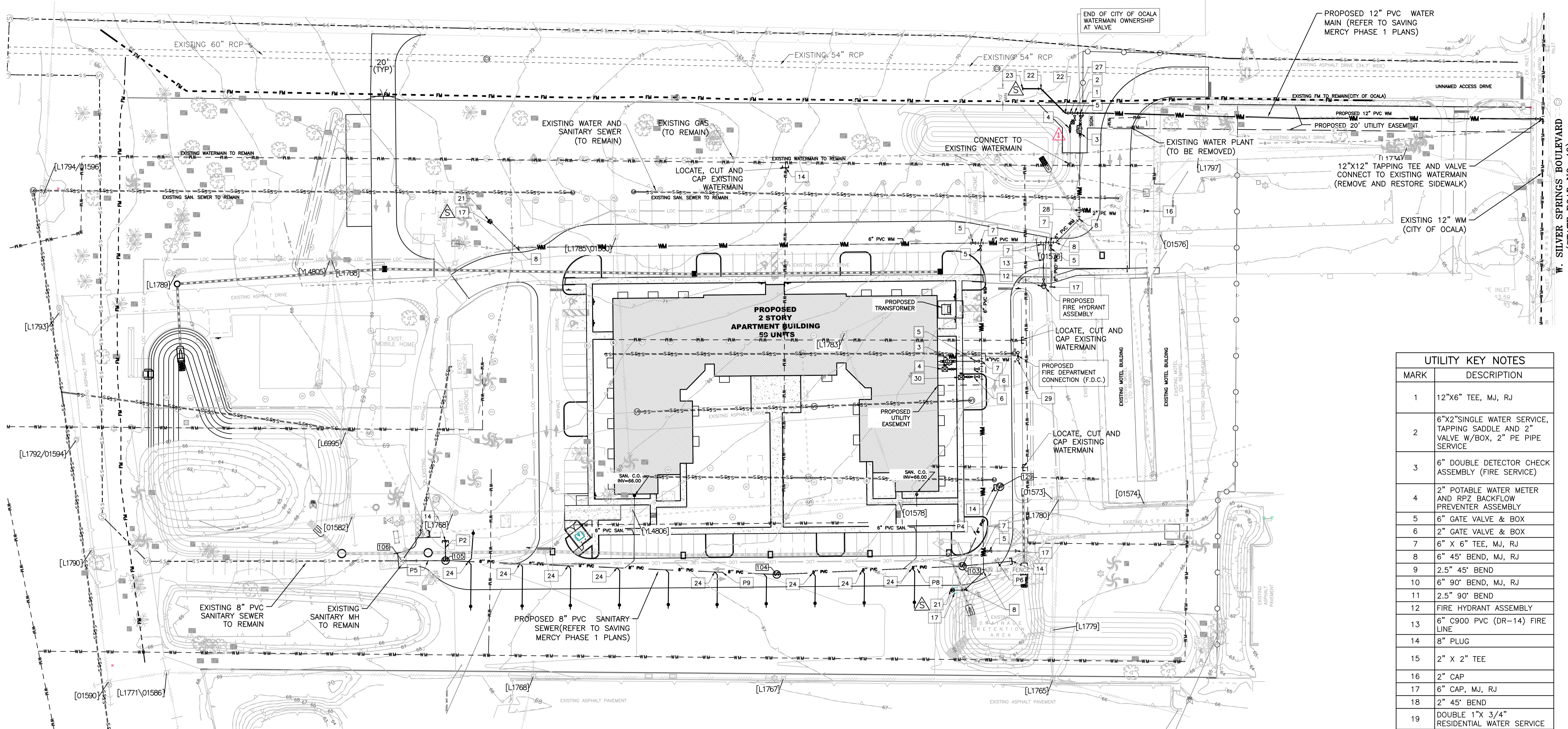
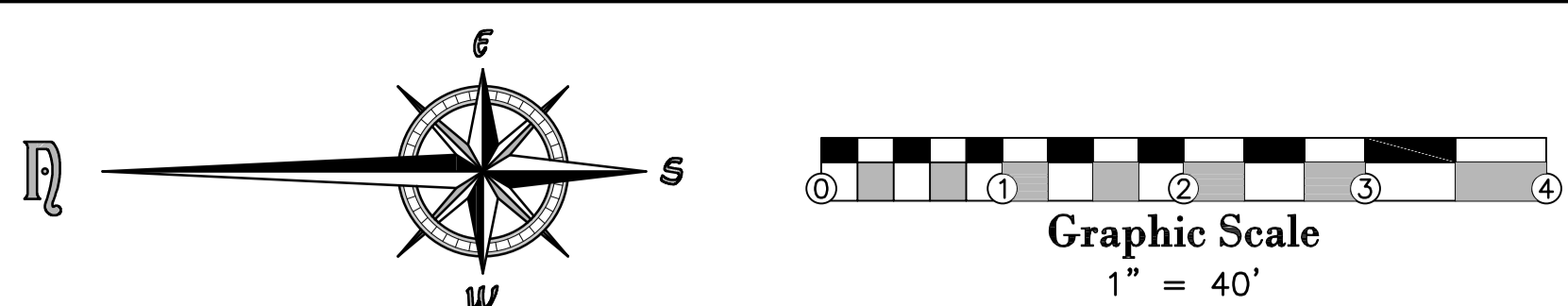

UTILITY KEY NOTES

MARK	DESCRIPTION
1	12"x6" TEE, MJ, RJ
2	6"x2" SINGLE WATER SERVICE, TAPPING SADDLE AND 2" VALVE W/BOX, 2" PE PIPE SERVICE
3	6" DOUBLE DETECTOR CHECK ASSEMBLY (FIRE SERVICE)
4	2" POTABLE WATER METER AND RPZ BACKFLOW PREVENTER ASSEMBLY
5	6" GATE VALVE & BOX
6	2" GATE VALVE & BOX
7	6" X 6" TEE, MJ, RJ
8	6" 45' BEND, MJ, RJ
9	2.5" 45' BEND
10	6" 90' BEND, MJ, RJ
11	2.5" 90' BEND
12	FIRE HYDRANT ASSEMBLY
13	6" C900 PVC (DR-14) FIRE LINE
14	8" PLUG
15	2" X 2" TEE
16	2" CAP
17	6" CAP, MJ, RJ
18	2" 45' BEND
19	DOUBLE 1" X 3/4" RESIDENTIAL WATER SERVICE
20	2" X 2" TEE
21	2" BLOW-OFF ASSEMBLY
22	12" 45' BEND, MJ, RJ
23	12" CAP, MJ, RJ
24	TYPICAL 4" PVC SEWER LATERAL
25	OPEN CUT EXISTING DRIVE & REPAIR AFTER CONSTRUCTION
26	SINGLE 1" X 3/4" RESIDENTIAL WATER SERVICE
27	12" GATE VALVE & BOX, MJ, RJ
28	6" X 2" TEE, 2" GATE VALVE & BOX, 2" PE PIPE W/CAP
29	6" DIA BOLLARD
30	6"x2" SINGLE IRRIGATION WATER SERVICE, TAPPING SADDLE AND 2" VALVE W/BOX, 2" PE PIPE SERVICE

- GENERAL NOTES:**
- EXISTING WATER MAIN AND SEWER LATERAL UTILITY DEPTH AND LOCATION SHALL BE FIELD VERIFIED PRIOR TO ANY DEMOLITION OR SITE WORK BEGINNING. EXISTING UTILITY CONNECTION DEPTH AND LOCATION INFORMATION SHALL BE PROVIDED TO THE ENGINEER AND ARCHITECT.
 - EXISTING WATER MAIN AND SEWER LATERAL UTILITY LOCATIONS AND ELEVATIONS SHALL BE FIELD VERIFIED PRIOR TO UTILITY SHOP DRAWING SUBMITTAL AND UTILITY STRUCTURE ORDER OR PLACEMENT.
 - EXISTING UNDERGROUND UTILITIES SHOWN ARE NOT SURVEY VERIFIED AND DRAWN ACCORDING TO BEST AVAILABLE HISTORICAL RECORDS.
 - AT PROPOSED STORM AND UTILITY CROSSINGS, WATERMAIN AND FIRE MAIN SHALL BE INSTALLED WITH MINIMUM 12" VERTICAL SEPARATION BELOW EXISTING UTILITY.
 - EXISTING UTILITIES ON SITE TO REMAIN EXCEPT WHERE SPECIFICALLY NOTED OR SHOWN TO BE REMOVED ON DEMOLITION PLAN.
 - ALL ON-SITE UTILITIES SHALL BE PRIVATELY MAINTAINED. CITY OF OCALA WILL ONLY MAINTAIN THE 12" WATERMAIN EXTENSION TO DDC ASSEMBLY.
 - ALL NEW BACKFLOW PREVENTORS SHALL BE INSTALLED BY THE CONTRACTOR AND MAINTAINED BY THE OWNER. BACKFLOW PREVENTOR ASSEMBLY SHALL BE INSTALLED AT A MINIMUM OF 18 INCHES FROM FINAL GRADE TO BOTTOM OF THE BACKFLOW PREVENTOR.
 - CONTRACTOR SHALL INSTALL ALL WATER SERVICES, METERS, AND ASSOCIATED APPURTENANCES

- ANY WATER MAIN OR SERVICE 2" OR ABOVE IN SIZE ARE TO HAVE GATE VALVES INSTALLED. ANY 2" OR LARGER VALVE SHALL HAVE A VALVE TIE SHEET SUPPLIED WITH ASBUILT DRAWING.
- ALL NEWLY INSTALLED FIRE HYDRANTS ARE TO BE FACTORY-PAINTED RED. THE FIRE HYDRANT CAPS AND BONNET SHALL BE PAINTED THE ISO COLOR BASED ON THE FIRE FLOW TEST RESULTS AND WILL BE REQUIRED PRIOR TO C.O.

PERMIT NOTE:
ALL FDEP PERMITS NEED TO BE OBTAINED PRIOR TO ANY CONSTRUCTION AND AN FDEP CLEARANCE IS REQUIRED PRIOR TO C.O.

WATER SYSTEM:
CONSTRUCT ALL POTABLE WATER MAINS AND SERVICES, UP TO THE POINT OF METERING TO CITY STANDARDS. INSPECTION WILL BE PERFORMED BY THE CITY WATER AND SEWER DEPARTMENT.

SANITARY MANHOLES

POINT	DESCRIPTION
103	SMH - 4 GRATE/RIM = 66.18 S. INV. IN 8" PVC = 60.62 S.E. INV. IN 8" PVC = 60.62 N. INV. OUT 8" PVC = 60.52
104	SMH - 3 GRATE/RIM = 66.98 S. INV. IN 8" PVC = 59.77 N. INV. OUT 8" PVC = 59.67
105	SMH - 2 GRATE/RIM = 68.63 S. INV. IN 8" PVC = 58.34 E. INV. IN 8" PVC = 58.44 N. INV. OUT 8" PVC = 58.24 EX. OCALA SMH - 1, ADJUST RIM GRATE/RIM = 69.07
106	SMH - 1 GRATE/RIM = 69.07 S. INV. IN 8" PVC = 57.96 (NEW) S.E. INV. IN 8" PVC = 57.96 (EXISTING) N. INV. OUT 8" PVC = 57.86 (EXISTING)
129	DOG HOUSE SMH - 6 GRATE/RIM = 66.05 FLOW LINE 8" CLAY = 61.10 (S TO REMAIN, PLUG N) S.W. INV. OUT 8" PVC = 61.00 (NEW)

SANITARY PIPE TABLE

PIPE	DESCRIPTION
P2	16.00 LF 8" PVC @ 0.50%
P4	70.00 LF 8" PVC @ 0.77%
P5	33.52 LF 8" PVC @ 1.00%
P6	40.00 LF 8" PVC @ 0.78%
P8	149.37 LF 8" PVC @ 0.50%
P9	266.39 LF 8" PVC @ 0.50%

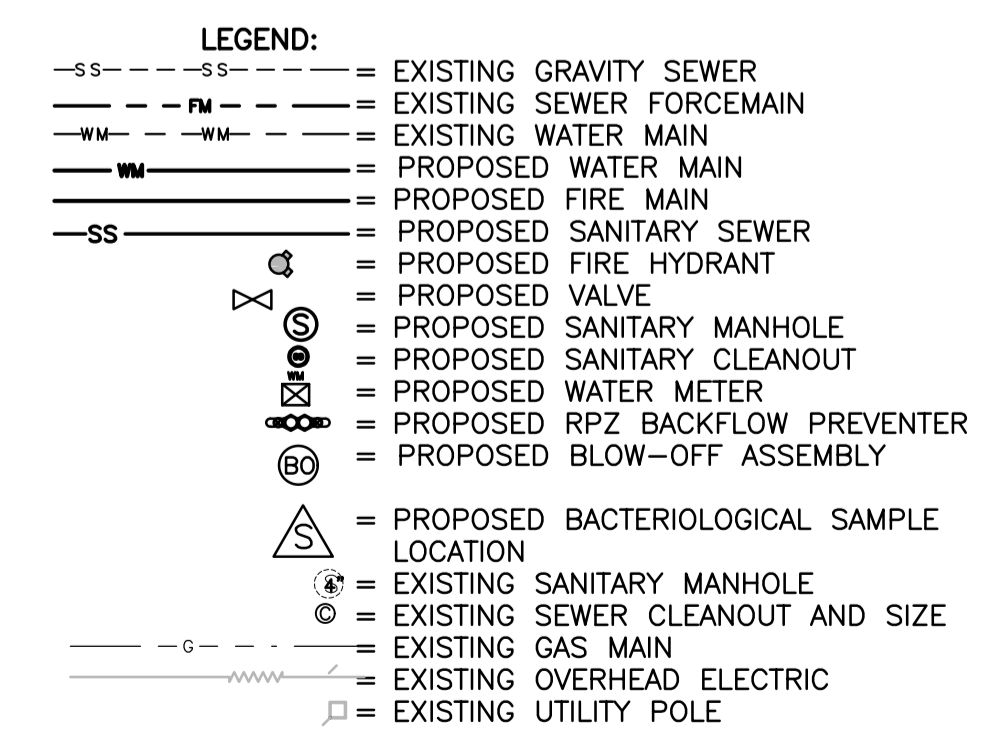

**MERCY VILLAGE APARTMENTS
OCALA, FLORIDA**

SECTION 14, TOWNSHIP 15 SOUTH, RANGE 21 EAST, MARION COUNTY, FLORIDA
DATE: 1/19/24
NO. 1
REVISIONS:
ADD IRRIGATION DEMAND AND WATER TIE-IN TO MATCH PH 1

926 S.E. 7th Street
Ocala, Florida 34471
(352) 861-7789 voice
ARDURRA
COLLABORATE INNOVATE CREATE
REGISTRATION NUMBERS:
ENGINEERING NO. 2653 SURVEYING & MAPPING LB NO. 290
FILE NO.: 426.05.01
JOB NO.: 426.05
SHEET: C-11 OF 11

File No.
426.05.01
Job No.
426.05
C-11 of 17

UTILITY PLAN

DATE
CHUCK A. PIGEON
REGISTERED PROFESSIONAL ENGINEER #37338
STATE OF FLORIDA