

FLORIDA MASTER SITE FILE
Site Inventory Form

12/88
(old parcel #)
need parcel # 7/89
FDARHM 802 ==
1009 ==
Site No. 52-51739 2820-010-006
820 ==
Survey Date 1981 905 ==

Site Name _____ 830 ==
Address of Site: 324 S. E. Alvarez Ave.
Instruction for locating Northwest corner of SE 4th St. and SE Alvarez Ave.
Location: Caldwells AD Ocala SE 1/4 & S 9 Ft of E 56 Ft of NE 1/4
County: Marion
Owner of Site: Name: Stout, Jacob D & Lennis REESE, ROBERT + RUDI
Address: 324 SE Alvarez Ave. 324 SE ALVAREZ AVE
Ocala, FL 32670 Ocala, FL 32671
Type of Ownership Private 848 == Recording Date _____ 832 ==

Recorder:
Name & Title: Withlacoochee Regional Planning Council, Joyce Cusick, Assoc.
Address: 1241 S.W. 10th St. Ocala, FL 32670 Planner
818 ==
838 ==

Condition of Site: Integrity of Site: Original Use Residence 850 ==
Check One Check One or More
 Excellent 863 == Altered 858 ==
 Good 863 == Unaltered 858 ==
 Fair 863 == Original Site 858 ==
 Deteriorated 863 == Restored () (Date:) 858 ==
 Moved () (Date:) 858 ==
Present Use Residence 850 ==
Dates: Beginning CA: 1930 844 ==
Culture/Phase American 840 ==
Period _____ 845 ==

NR Classification Category: _____ 916 ==

Threats to Site:
Check One or More
 Zoning () _____ () 878 == Transportation () _____ () 878 ==
 Development () _____ () 878 == Fill () _____ () 878 ==
 Deterioration () _____ () 878 == Dredge () _____ () 878 ==
 Borrowing () _____ () 878 ==
 Other (See Remarks Below): _____ 878 ==

Areas of Significance: Architecture 910 ==

Significance:
An example of a vernacular style house exhibiting Mediterranean architectural influences. The house is in scale and character with its surroundings, a residential Victorian neighborhood which has evolved from the 1880's through the early 1900's.
911 ==

ARCHITECT 872 ==
 BUILDER 874 ==
 STYLE AND/OR PERIOD vernacular Mediterranean Infl. 964 ==
 PLAN TYPE central 966 ==
 EXTERIOR FABRIC(S) stucco grey 854 ==
 STRUCTURAL SYSTEM(S) wood frame 856 ==
 PORCHES front
 FOUNDATION: continuous 942 ==
 ROOF TYPE: hip 942 ==
 SECONDARY ROOF STRUCTURE(S): shed/balcony over porch 942 ==
 CHIMNEY LOCATION: none 942 ==
 WINDOW TYPE: double hung small pane 942 ==
 CHIMNEY: none 882 ==
 ROOF SURFACING: asbestos tile 882 ==
 ORNAMENT EXTERIOR: --- 882 ==
 NO. OF CHIMNEYS --- 950 ==
 NO. OF DORMERS 1 954 ==
 Map Reference (incl. scale & date) USGS Ocala West - #447 - 7.5 Min. - 1964
 Latitude and Longitude: 809 ==
 Site Size (Approx. Acreage of Property): 800 ==
 833 ==

Township	17
Range	15
Section	22

#51739

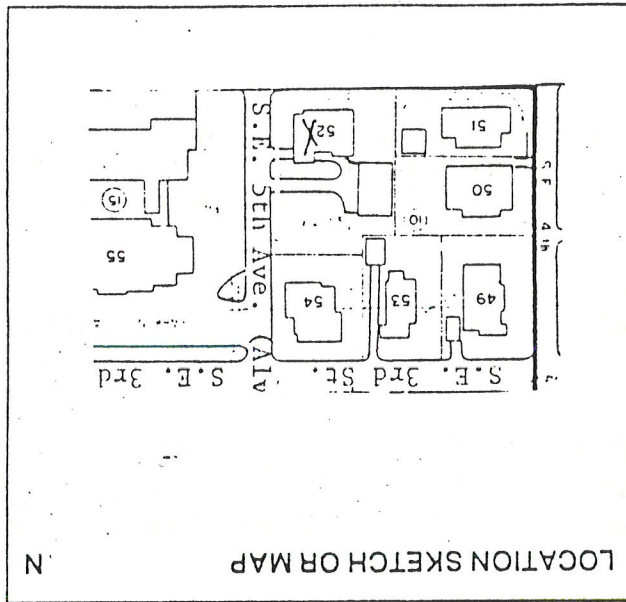

Photographic Records Numbers
81N70#8 (3, 4)

84N512 #24(13)
Contact Print



ONE OF TWO STRUCTURES ✓12/88
AT 304 SE ALVAREZ AVE

(old parcel#) (C)
new parcel# 7189

STATE OF FLORIDA
DEPARTMENT OF STATE
Division of Archives, History
and Records Management
DS-HSP-3AAA Rev. 3-79

FLORIDA MASTER SITE FILE
Site Inventory Form

FDAHRM 802 ==
1009 ==
Site No. 54(51740) 2820-D10-003
Survey Date 820 ==
905 ==

Site Name Hartshorn, Hannah House 830 ==
Address of Site: 304 SE Alvarez Avenue
Instruction for locating southwest corner of SE 3rd St and SE Alvarez Ave 813 ==

Location: Caldwells AD Ocala Com at NE Cor Lot 10 Thence W 70 Ft S 868 ==
subdivision name block no. lot no.

County: Marion - 104 Ft E 14 Ft N 9 Ft E 56 Ft N 95 Ft 808 ==

Owner of Site: Name: Stout, Jacob D. & Lennis REESE, ROBERT + RUTH ;
Address: 324 SE Alvarez Avenue 324 SE ALVAREZ AVE
Ocala, FL 32670 Ocala, FL - 32671 902 ==
832 ==

Type of Ownership Private 848 == Recording Date

Recorder:
Name & Title: Withlacoochee Regional Planning Council, Joyce Cusick, Assoc
Address: 1241 SW 10th St. Planner 818 ==
Ocala, FL 32670 838 ==

Condition of Site: Integrity of Site: Original Use Residence 850 ==

Check One Check One or More Present Use Residence 850 ==
 Excellent 863 == Altered 858 ==
 Good 863 == Unaltered 858 ==
 Fair 863 == Original Site 858 ==
 Deteriorated 863 == Restored () (Date: X) 858 ==
 Moved () (Date: X) 858 ==
Dates: Beginning ca +1895 844 ==
Culture/Phase American 840 ==
Period 845 ==

NR Classification Category: 916 ==

Threats to Site:
Check One or More
 Zoning (X) 878 == Transportation (X) 878 ==
 Development (X) 878 == Fill (X) 878 ==
 Deterioration (X) 878 == Dredge (X) 878 ==
 Borrowing (X) 878 ==
 Other (See Remarks Below): 878 ==

Areas of Significance: Architecture 910 ==

Significance:

Secondary building on property. Please refer to Master Site File Inventory of the primary residence for additional information.



1 ==

2-92
Vol 2

