

CA. 91 - re-roof approved via memo to  
OWPAB from Planning staff

✓ 1/2/88  
(old parcel #)  
new parcel # 7/89

(A)

PS

STATE OF FLORIDA  
DEPARTMENT OF STATE  
Division of Archives, History  
and Records Management  
DS-HSP 3AAA Rev. 3-79

# FLORIDA MASTER SITE FILE Site Inventory Form

FDAHRM 802 ==  
1009 ==  
Site No. 15- (51929) 2820-000-009  
830 == Survey Date 1981 820 ==  
905 ==

Site Name Bltch, S. H. House  
Address of Site: 703 SE Ft. King  
Instruction for locating Fifth house west of SE Wenona Ave on north side of SE  
Ft. King Ave.

Location: Caldwells AD Ocala Com 290 Ft W of SW Cor Lot 40 Thence

County: Marion - W 70 Ft N 115 1/2 Ft E 70 Ft S 115 1/2 Ft

Owner of Site: Name: Ritter, G Don & Shirley

Address: PO Box 1161  
Ocala, FL 32678

Type of Ownership Private Recording Date

Recorder:

Name & Title: Withlacoochee Regional Planning Council, Joyce Cusick, Assoc.

Address: 1241 S.W. 10th St. Planner  
Ocala, FL 32670

Condition of Site: Integrity of Site: Original Use Residence

Check One

Check One or More

☒ Excellent 863 == ☒ Altered 858 ==  
☐ Good 863 == ☐ Unaltered 858 ==  
☐ Fair 863 == ☐ Original Site 858 ==  
☐ Deteriorated 863 == ☐ Restored ( ) (Date: ) 858 ==  
☐ Moved ( ) (Date: ) 858 ==

Present Use Professional 850 ==  
Dates: Beginning CA: 1912 844 ==  
Culture/Phase American 840 ==  
Period 845 ==

NR Classification Category: 916 ==

Threats to Site:

Check One or More

☐ Zoning ( ) 878 == ☐ Transportation ( ) 878 ==  
☒ Development ( ) 878 == ☐ Fill ( ) 878 ==  
☐ Deterioration ( ) 878 == ☐ Dredge ( ) 878 ==  
☐ Borrowing ( ) 878 ==  
☐ Other (See Remarks Below): 878 ==

Areas of Significance: Architecture 910 ==

## Significance:

An example of a frame vernacular style house. It was the residence of S. H. Blitch who was the manager of the Commercial Bank CA 1911-12. The house is in scale and character with its surroundings, a residential Victorian neighborhood which has evolved from the 1880's through the early 1900's.

911 ==



ARCHITECT \_\_\_\_\_ 872 ==  
 BUILDER \_\_\_\_\_ 874 ==  
 STYLE AND/OR PERIOD frame vernacular 964 ==  
 PLAN TYPE central 966 ==  
 EXTERIOR FABRIC(S) stucco 854 ==  
 STRUCTURAL SYSTEM(S) wood frame 856 ==  
 PORCHES east side enclosed  
 \_\_\_\_\_ 942 ==  
 FOUNDATION: continuous footing 942 ==  
 ROOF TYPE: gable 942 ==  
 SECONDARY ROOF STRUCTURE(S): shed 942 ==  
 CHIMNEY LOCATION: off ridge 942 ==  
 WINDOW TYPE: corner casement 942 ==  
 CHIMNEY: tin 882 ==  
 ROOF SURFACING: asphalt tile 882 ==  
 ORNAMENT EXTERIOR: fieldstone 882 ==  
 NO. OF CHIMNEYS 1 952 == NO. OF STORIES 1 950 ==  
 NO. OF DORMERS --- 954 ==  
 Map Reference (incl. scale & date) USGS Ocala West - #447 - 7.5 Min. - 1964  
 \_\_\_\_\_ 809 ==  
 Latitude and Longitude: \_\_\_\_\_ 800 ==  
 \_\_\_\_\_  
 Site Size (Approx. Acreage of Property): \_\_\_\_\_ 833 ==

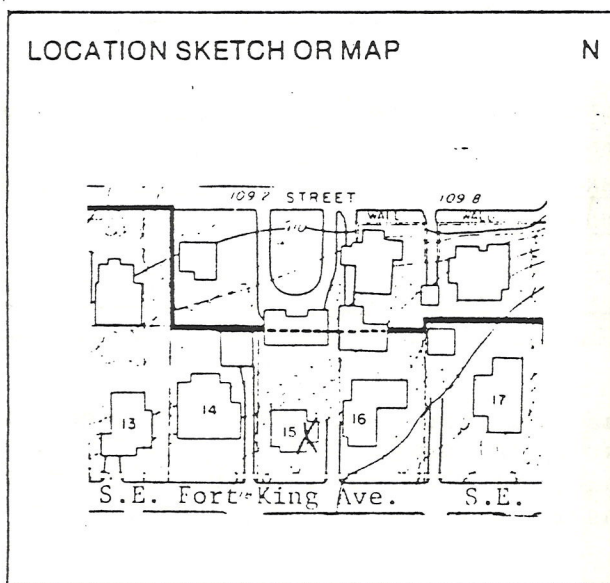

Photographic Records Numbers \_\_\_\_\_

81N70#11 (14,17)

84N312 #21 (15)  
Contact Print

Township	Range	Section
---	---	---

