

FLORIDA MASTER SITE FILE
Site Inventory Form

✓ 12/88 (old parcel #) new parcel # 7189
C
FDAH RM 802 = =
49 (51742) 1009 = =
2820-010-001

Site Name Massey, Como D. House 830 = =
Address of Site: 406 S.E. 3rd St.
Instruction for locating SE corner Watula and SE 3rd St.

Location: Caldwells AD Ocala Com at NW Cor Lot 10 Thence S 104 Ft E 813 = =
subdivision name block no. lot no. 868 = =

County: Marion - 70 Ft N 104 Ft W 70 Ft to POB ROBERT + COLLIERMINA 808 = =

Owner of Site: Name: Nelson, Clyde & Mary HERIOT, ANNA & DAVID LINDSTROM

Address: Rt 5, Box 443 406 SE 3RD ST 902 = =

Hendersonville, NC 28739 OCALA, FL 32671 832 = =

Type of Ownership Private 848 = = Recording Date

Recorder: Name & Title: Withlacoochee Regional Planning Council, Joyce Cusick, Assoc.

Address: 1241 S.W. 10th St. Planner 818 = =

Ocala, FL 32670 838 = =

Condition of Site: Integrity of Site: Original Use residence

Check One: Check One or More
☒ Excellent 863 = = ☐ Altered 858 = =
☐ Good 863 = = ☒ Unaltered 858 = =
☐ Fair 863 = = ☐ Original Site 858 = =
☐ Deteriorated 863 = = ☐ Restored () (Date:) 858 = =
☐ Moved () (Date:) 858 = =

Present Use residence 850 = =
Dates: Beginning ca: 1895 844 = =
Culture/Phase American 840 = =
Period 845 = =

NR Classification Category: 916 = =

Threats to Site:

Check One or More
☐ Zoning () 878 = = ☐ Transportation () 878 = =
☒ Development () 878 = = ☐ Fill () 878 = =
☐ Deterioration () 878 = = ☐ Dredge () 878 = =
☐ Borrowing () 878 = =
☐ Other (See Remarks Below): 878 = =

Areas of Significance: architecture 910 = =

Significance:

An example of a Victorian frame vernacular style house exhibiting classical architectural influences. It was the residence of Como D. Massey who was the receiving teller at the First Nation Bank in the 1890's. The house is in scale and character with its surroundings, a residential Victorian neighborhood which has evolved from the 1880's through the early 1900's.

911 = =

ARCHITECT _____ 872 ==
 BUILDER _____ 874 ==
 STYLE AND/OR PERIOD frame vernacular Victorian/classic influence 964 ==
 PLAN TYPE asymmetrical 966 ==
 EXTERIOR FABRIC(S) wood siding beveled 854 ==
 STRUCTURAL SYSTEM(S) wood frame 856 ==
 PORCHES front and west side-Pediment columns with carpenter style brackets
 _____ 942 ==
 FOUNDATION: brick piers 942 ==
 ROOF TYPE: gable 942 ==
 SECONDARY ROOF STRUCTURE(S): gable 942 ==
 CHIMNEY LOCATION: on ridge 942 ==
 WINDOW TYPE: double hung 942 ==
 CHIMNEY: brick 882 ==
 ROOF SURFACING: asbestos slate 882 ==
 ORNAMENT EXTERIOR: shutter 882 ==
 NO. OF CHIMNEYS 1 952 == NO. OF STORIES 2 950 ==
 NO. OF DORMERS _____ 954 ==
 Map Reference (incl. scale & date) USGS Ocala West - #447 - 7.5 Min. - 1964
 _____ 809 ==
 Latitude and Longitude: _____ 800 ==

 Site Size (Approx. Acreage of Property): _____ 833 ==

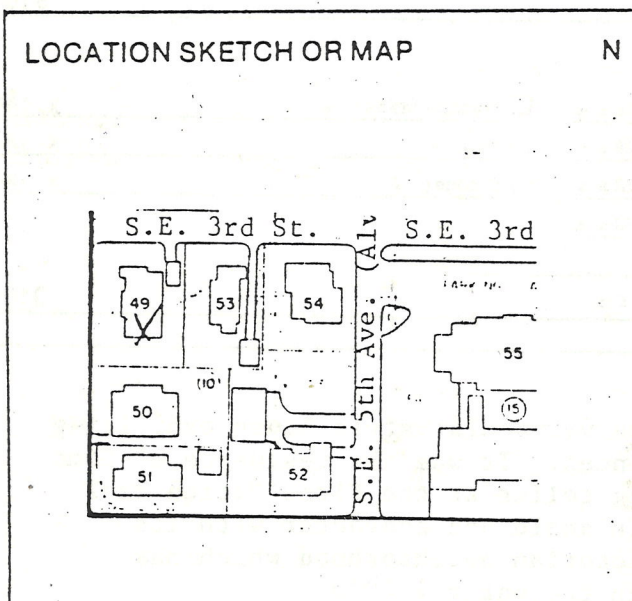

Photographic Records Numbers _____
 81N70#6(7,8)

84N312 # 22 (22)
 Contact Print

Township	Range	Section
UT		

UT

Zor

