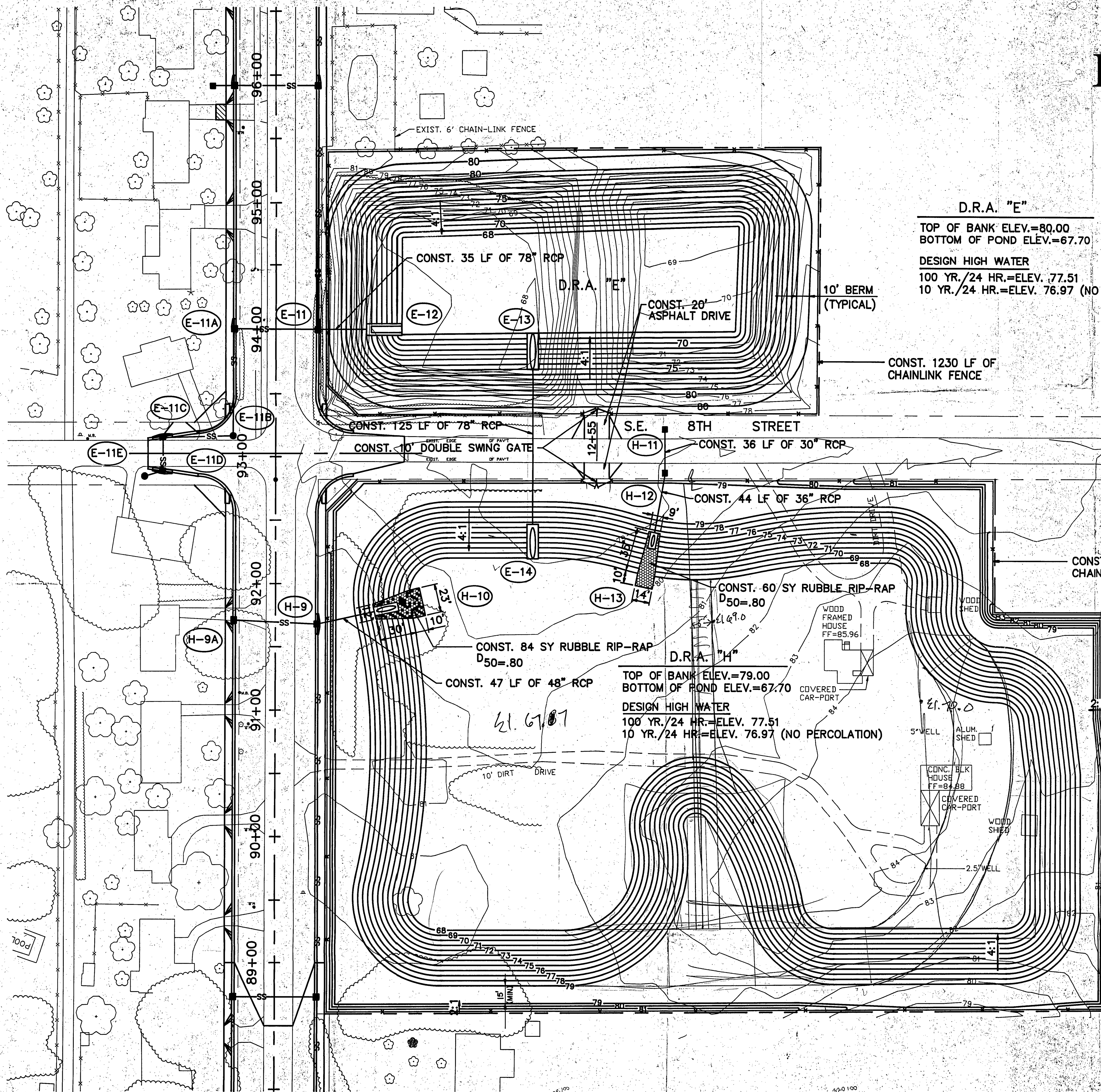
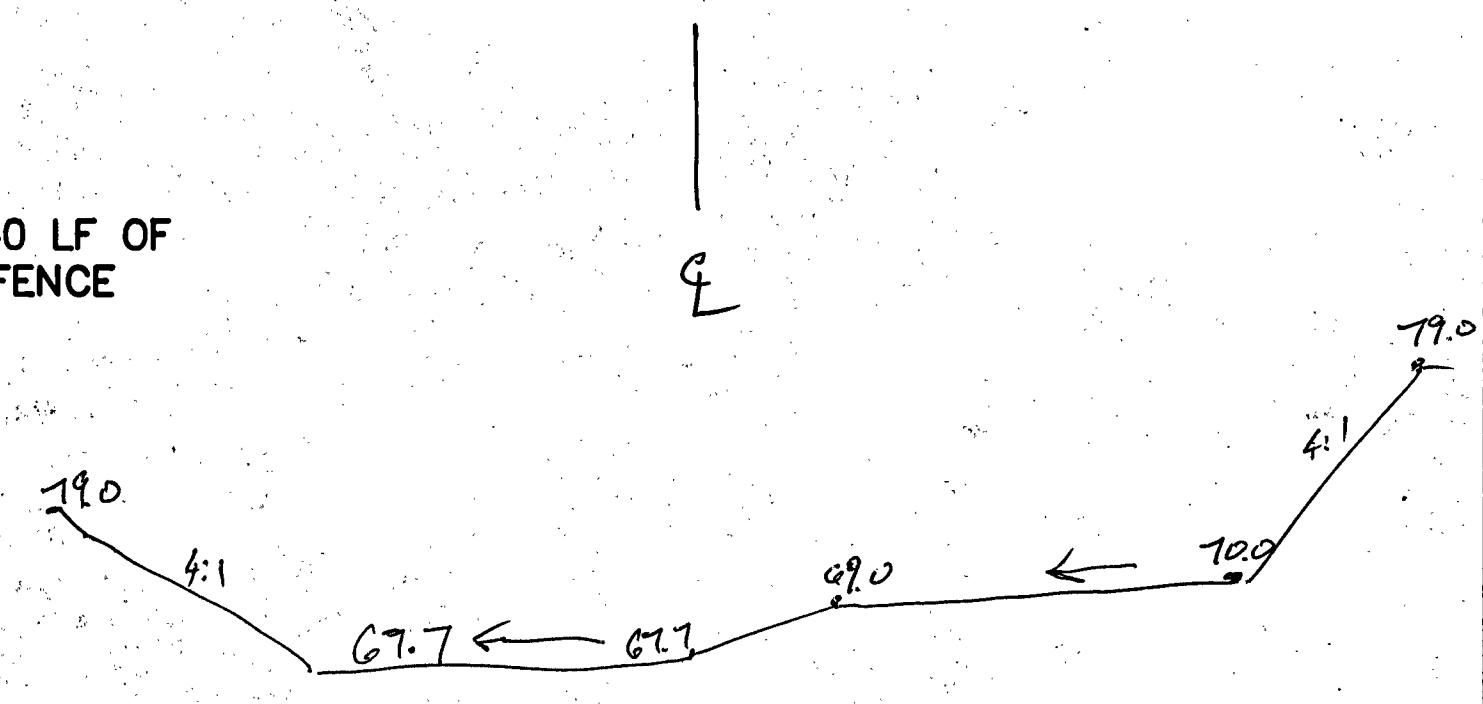

Exhibit A



D.R.A. "E"
 TOP OF BANK ELEV.=80.00
 BOTTOM OF POND ELEV.=67.70
 DESIGN HIGH WATER
 100 YR./24 HR.=ELEV. 77.51
 10 YR./24 HR.=ELEV. 76.97 (NO PERCOLATION)

D.R.A. "H"
 TOP OF BANK ELEV.=79.00
 BOTTOM OF POND ELEV.=67.70
 DESIGN HIGH WATER
 100 YR./24 HR.=ELEV. 77.51
 10 YR./24 HR.=ELEV. 76.97 (NO PERCOLATION)



- NOTES:**
1. ALL EXIST. FENCE WITHIN RETENTION AREAS TO BE REMOVED.
 2. ALL EXIST. WELLS SHALL BE ABANDONED IN ACCORDANCE WITH F.A.C. CHAPTER 40 C-3.
 3. SOD ALL SLOPES OF D.R.A. SEED AND MULCH ALL OTHER AREAS WITHIN THE D.R.A. EXCLUDING BOTTOM.

DATE	REVISIONS	MADE BY	DESIGNED RSL/KCK	DRAWN ABP	CHECKED RSC	APPROVED JTB	SMITH & GILLESPIE ENGINEERS, INC. JACKSONVILLE, FLORIDA	36TH AVENUE WIDENING AND RECONSTRUCTION OCALA, FLORIDA	DRAINAGE RETENTION AREA "E" AND "H" GRADING PLAN	SCALE 1"=40'	DATE JUNE 1990	FILE NO.	DRWG. NO. 88
8806-01-01													

RF-2C