

FLORIDA MASTER SITE FILE  
Site Inventory Form

FDAHRM 802 = =

Site No. (51842) 2820-032-001  
Survey Date 8303 820 = =  
830 = = 905 = =

Site Name \_\_\_\_\_  
Address of Site: 605 S.E. Sanchez Ave.

Instruction for locating 605 S.E. Sanchez Ave.  
Ocala, Fla. 32671 813 = =

Location: Caldwells Ad Ocala N. 103' of W. 100' Lot 32 868 = =  
subdivision name block no. lot no.

County: Marion 808 = =

Owner of Site: Name: Monnacy, Edgar & c.s. KUENDIG, DAVID & MARY ;

Address: 1500 N.E. 15th Ave. 7846 NW 136th TERRACE  
Ocala, Fla. 32670 OCALA, FL. 32675 902 = =

Type of Ownership Private 848 = = Recording Date 832 = =

Recorder: \_\_\_\_\_

Name & Title: Tate, Susan (Preservation Architect) ;

Address: University of Florida - College of Architecture  
Gainesville, Fla. 32611 818 = =

Condition of Site: Integrity of Site: Original Use Residence 838 = =

Check One		Check One or More		Present Use <u>Residence</u> 850 = =	
<input type="checkbox"/> Excellent 863 = =	<input checked="" type="checkbox"/> Altered 858 = =	<input type="checkbox"/> Unaltered 858 = =	<input checked="" type="checkbox"/> Original Site 858 = =	Dates: Beginning <u>C+ 1895</u> 844 = =	
<input checked="" type="checkbox"/> Good 863 = =	<input type="checkbox"/> Restored ( ) (Date: <u>X</u> ) 858 = =	<input type="checkbox"/> Moved ( ) (Date: <u>X</u> ) 858 = =		Culture/Phase <u>American</u> 840 = =	
<input type="checkbox"/> Fair 863 = =				Period <u>19th Century</u> 845 = =	
<input type="checkbox"/> Deteriorated 863 = =					

NR Classification Category: Building 916 = =

Threats to Site: \_\_\_\_\_

Check One or More			
<input checked="" type="checkbox"/> Zoning ( <u>X</u> ) 878 = =	<input type="checkbox"/> Transportation ( <u>X</u> ) 878 = =	<input type="checkbox"/> Fill ( <u>X</u> ) 878 = =	<input type="checkbox"/> Dredge ( <u>X</u> ) 878 = =
<input type="checkbox"/> Development ( <u>X</u> ) 878 = =			
<input type="checkbox"/> Deterioration ( <u>X</u> ) 878 = =			
<input type="checkbox"/> Borrowing ( <u>X</u> ) 878 = =			
<input type="checkbox"/> Other (See Remarks Below): _____ 878 = =			

Areas of Significance: Architecture 910 = =

Significance:

Although altered at the entry level, this wood frame structure is noteworthy for ornamental shingles, turned pendants, incised gable ornament and fluted columns.  
It is in Caldwell's Ad Ocala platted in 1880 and first appears on the Sanborn Map of 1895.

911 = =

ARCHITECT \_\_\_\_\_ 872 ==  
 BUILDER \_\_\_\_\_  
 STYLE AND/OR PERIOD Frame vernacular/Queen Anne Revival influence 964 ==  
 PLAN TYPE Irregular 966 ==  
 EXTERIOR FABRIC(S) Novelty siding (new siding at entry) 854 ==  
 STRUCTURAL SYSTEM(S) \_\_\_\_\_ 856 ==  
 PORCHES Front (wrapping to North) \_\_\_\_\_ 942 ==  
 FOUNDATION: Brick pier 942 ==  
 ROOF TYPE: Intersecting gable 942 ==  
 SECONDARY ROOF STRUCTURE(S): Possible alteration at NW corner 942 ==  
 CHIMNEY LOCATION: Center ridge 942 ==  
 WINDOW TYPE: 2/2 DHS 942 ==  
 CHIMNEY: Brick 882 ==  
 ROOF SURFACING: Asphalt shingles 882 ==  
 ORNAMENT EXTERIOR: Fluted columns, ornamental shingles 882 ==  
 NO. OF CHIMNEYS One 952 == NO. OF STORIES Two 950 ==  
 NO. OF DORMERS \_\_\_\_\_ 954 ==  
 Map Reference (incl. scale & date) \_\_\_\_\_ 809 ==  
 Latitude and Longitude: \_\_\_\_\_ 800 ==  
 Site Size (Approx. Acreage of Property): \_\_\_\_\_ 833 ==

# LOCATION SKETCH OR MAP

N

S.E. 6th Street

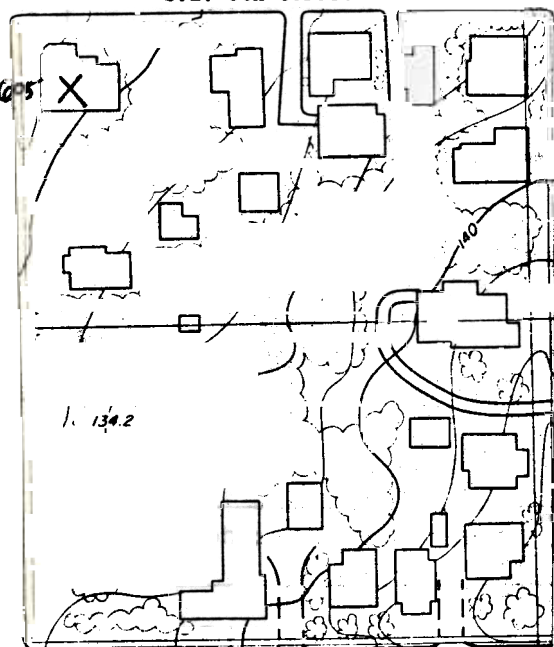

S.E. 8th Street

83 N 417 #2 (35,36)

Township	Range	Section
15S	22E	SW1/4 17

812 ==

UTM Coordinates:

Zone Easting Northing

890 ==

