



City of Ocala
 Growth Management Department
 201 S.E. 3rd Street, 2nd Floor
 352-629-8421 | www.ocalafl.org

Case File # 68
 COA 26 - 0025
 Meeting Date: 06/04/2026
 Product Approval # _____

Application for a Certificate of Appropriateness (COA)

As required by [Section 94-82\(g\)](#) of the City of Ocala Code of Ordinances, Ocala Historic Preservation Advisory Board (OHPAB) decisions on the COAs will be based on the [Secretary of the Interior's Standards for Rehabilitation and Guidelines for Rehabilitating Historic Buildings](#) the [Ocala Historic Preservation Design Guidelines](#), and the [Ocala Historic Preservation Code](#).

COA Application Procedure:

1. Arrange an informal pre-application conference with Planning staff.
2. Fill out and submit COA application and required material to Planning staff 30 days prior to OHPAB meeting. Please email application packets: historic@ocalafl.org.
3. Attend OHPAB meeting or send a representative with a letter of authorization.
4. Meetings are held the 1st Thursday of each month at 4:00 p.m.
5. Meeting Location: City Council Chambers, 2nd floor of City Hall (110 SE Watula Ave.)

If applicant fails to notify staff and does not attend the meeting, the application may be tabled for one month. If applicant fails to notify staff and does not attend the next monthly meeting, the application may be denied without prejudice.

There is no application fee; however, if work is performed without an approved COA, a fee of \$100 will be assessed.

Parcel #:	28362-039-01	Property Address:	906 E Fort King
Owner:	Jon & Stacey Harris	Owner Address:	906 E Fort King
Owner Phone #:	678 333 7852	Owner Email:	staceyharris11@gmail.com
Will there be an additional meeting representative? <input type="checkbox"/> Yes <input checked="" type="checkbox"/> No (If yes, representative will need a letter of authorization*)			
If yes, name of representative:			
Rep. Phone #:		Rep. Email:	

Project Type:	<input checked="" type="checkbox"/> Addition	<input type="checkbox"/> New Construction	<input type="checkbox"/> Site Work
	<input type="checkbox"/> Alteration	<input type="checkbox"/> Reroof	<input type="checkbox"/> Fence
	<input type="checkbox"/> Repair	<input type="checkbox"/> Relocation	<input type="checkbox"/> Other _____



City of Ocala
Growth Management Department
201 S.E. 3rd Street, 2nd Floor
352-629-8421 | www.ocalafl.org

Case File # 68
COA 26 0025
Meeting Date: 06/04/2026
Product Approval # _____

Describe, by list, specific changes you are requesting to do to your property. Include the types of materials to be used, as well as dimensions. A site plan must be provided for additions to buildings, new construction (including garages, sheds, other accessory buildings), fences and site work (including driveways, parking areas and other improvements). The site plan must show setbacks of the proposed new work items from property lines. Attach additional pages as necessary.

Construction of 2 open-air pergola structures on the existing residence.

1. a ground level pergola located on the east side of the home.
2. An upper-level pergola structure located on the existing elevated deck above carport.

See COA Pergola attachment for details.

Required additional materials for submission:

- Completed and signed COA application
- Detailed drawings and specifications for all new materials – windows, doors, siding, roofing materials, fencing etc.
- Site plan
- Copy of property deed or proof of ownership
- Authorization letter for non-property owner representative*
- For New Construction: a set of building plans, no larger than 11x17, for structural changes or new construction. This includes all four elevations with drawn to scale dimensions. *
- Please list any additional attachments:

Stacey Harris

Applicant Signature

4-1-26

Date

CERTIFICATE OF APPROPRIATENESS – PROJECT DESCRIPTION

Property Address: 906 East Fort King Street

Applicant: Jon and Stacey Harris

Project: Construction of Pergola Structures (Ground-Level and Upper Deck)

Project Overview

This application proposes the construction of two open-air pergola structures on the existing residence:

- A ground-level pergola located on the right (east) side of the home, constructed over an existing concrete patio (215”x120”)
- An upper-level pergola structure located on the existing elevated deck (Upper deck is 26’8”x45’6”. Pergola will be 26’8”x12’8” with an additional 6’x6’11” covered entryway into the house.)

The proposed work is designed to be compatible with the historic character of the property and surrounding district, consistent with the City of Ocala Historic Preservation Guidelines and the Secretary of the Interior’s Standards for Rehabilitation.

Design Intent & Compatibility

The pergolas have been designed to meet Ocala’s standard that new work shall be differentiated yet compatible with the historic structure in terms of scale, massing, materials, and architectural features.

- Reflects the scale, proportions, and rhythm of the existing structure
- Incorporates existing architectural elements including column forms, trim profiles, and siding exposure
- Maintains the visual continuity of the structure and district
- Designed as subordinate additions, clearly secondary to the primary historic resource

The intent is for the structures to appear historically appropriate while remaining identifiable as new, reversible additions.

Materials & Construction

All materials are selected to comply with Ocala guidelines requiring visual compatibility and durability:

- Roofing: Architectural asphalt shingles to match the existing roof in color, material, and profile
- Siding & Trim: Horizontal lap siding and trim to match existing dimension, exposure, and finish
- Columns: Columns will replicate existing columns by the concrete pad and in the carport area in proportion, spacing, and detailing (base and capital)
- Ceiling & Soffits: Painted wood compatible with existing porch finish
- Paint & Finish: All finishes will match the existing historic color palette

Ground-Level Pergola

- Located on an existing concrete pad, minimizing site disturbance
- Open-air structure with a light roof element providing shade
- Column placement reflects the existing architectural rhythm and spacing
- Designed as a compatible accessory structure that does not obscure or alter historic features

Upper-Level Pergola

- Constructed on the existing deck footprint, with no expansion of massing

- Provides shade and defines outdoor space while maintaining openness
- Reduces the visual scale of the deck in a manner consistent with historic proportions
- Roof form and detailing are designed to be compatible with existing rooflines without creating a false historical appearance

Impact on Historic Fabric

This project is consistent with Ocala's preservation principles:

- No removal or alteration of character-defining historic features
- Work is additive and reversible, preserving the integrity of the original structure
- New construction is clearly distinguishable upon close inspection while remaining visually compatible
- The project does not introduce inappropriate materials or alter the historic setting

Summary

The proposed pergolas meet the intent of the City of Ocala Historic Preservation Guidelines by ensuring that new construction is compatible, subordinate, and reversible, while preserving the historic character of the property. The design carefully balances modern functionality with historic sensitivity, ensuring the additions enhance the property without detracting from its architectural significance.

PARCEL #: 28362-039-01

JON & STACEY HARRIS
906 E FORT KING ST
OCALA FL 34471-2318

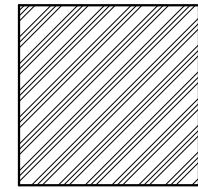

EXISTING BUILDING

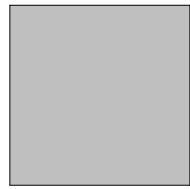

PROPOSED CONSTRUCTION

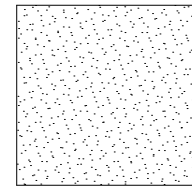

EXISTING HARDSCAPE

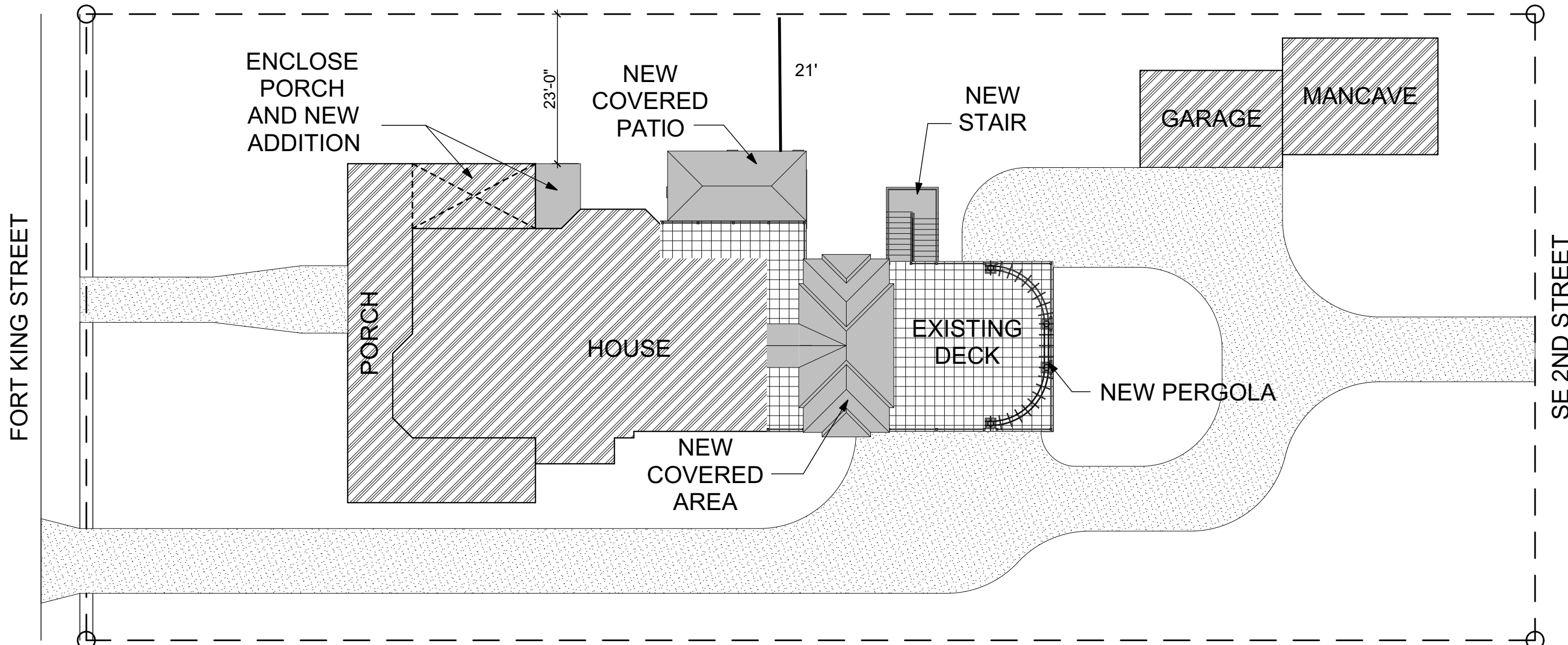

SITE PLAN
SCALE: 1/16"=1'-0"

LAWRENCE BRITT HULSELL, LLC
1515 E. SILVER SPRINGS BLVD. SUITE 100
SPRING LAKE, FL 32159
352-362-5004

STATE OF FLORIDA
LAWRENCE BRITT HULSELL
ARCHITECT
REGISTERED

REGISTRATION NUMBER BR 43776

© LAWRENCE & HULSELL LLC
2020

ALTERATIONS & ADDITIONS FOR:
JOHN & STACEY HARRIS
OCALA, FLORIDA

DATE: 05-05-2020
REVISION: XX-XX-XX

SHEET:
1
OF
10

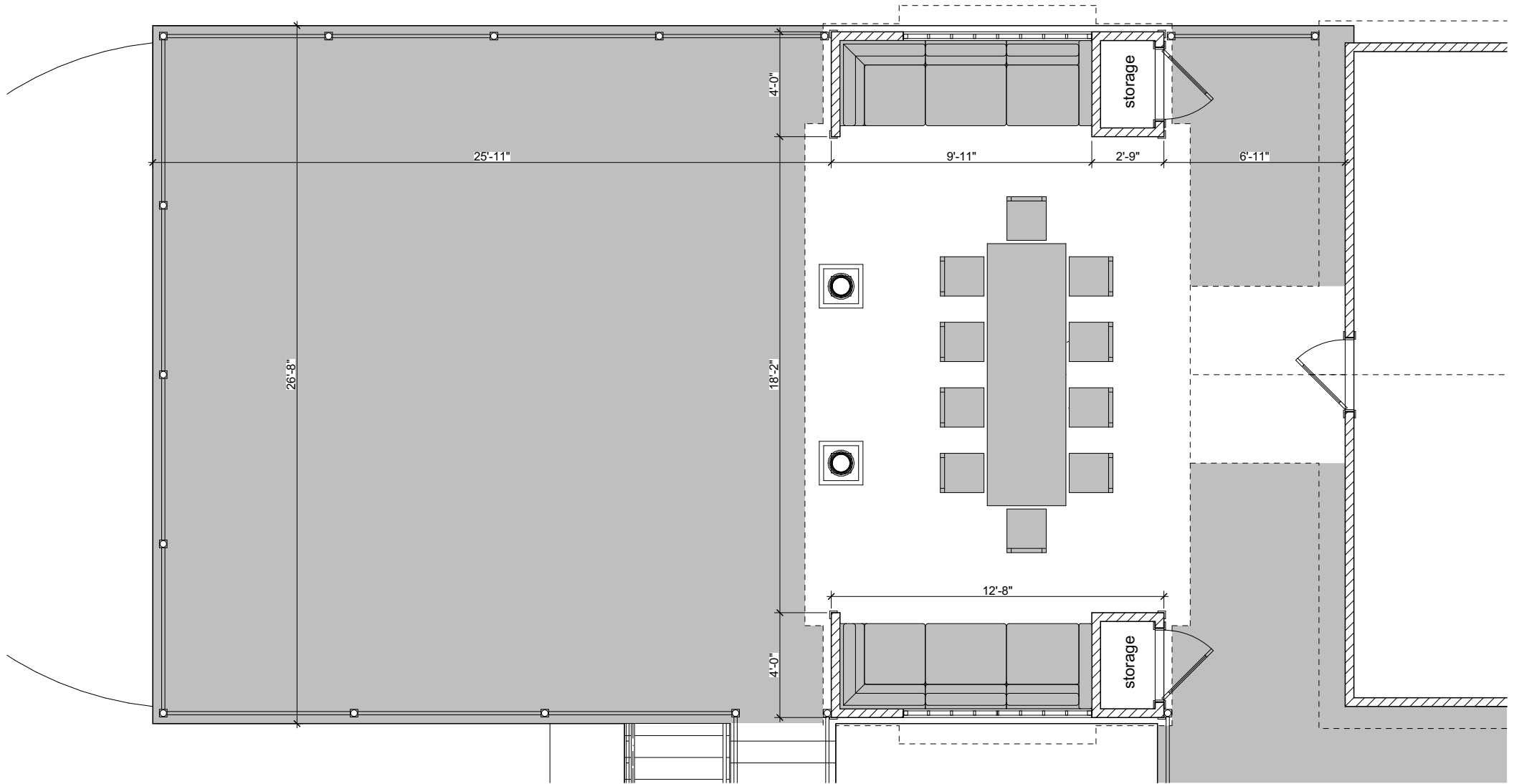

PROPOSED PERGOLA ADDITIONS

Ocala Historic District – Jon Harris



Ground-Level Pergola: Constructed over existing concrete pad. Columns replicate existing architectural rhythm and proportions. Roof and materials match main structure.



Upper Deck Pergola: Installed on existing deck footprint. Reduces visual scale and provides shade. Design aligns with historic proportions and rooflines.

These additions are compatible, subordinate, and reversible, consistent with City of Ocala Historic Preservation Guidelines.



TruDefinition®
DURATION®

Shingles with Patented SureNail® Technology

Tejas con tecnología patentada SureNail®



Driftwood®



DEEP DIMENSION OUTSTANDING PERFORMANCE

Duration® Shingles offer:

- The high-performance of SureNail® Technology
- A TruDefinition® Color Platform
- A Limited Lifetime Warranty*† for as long as you own your home
- The protection of a 130-MPH* wind warranty
- StreakGuard® Protection with a 25-year Algae Resistance Limited Warranty^{3/5}
- Rated Class 3 for Impact Resistance⁶ and may qualify for a homeowner insurance discount⁷

UNA NUEVA DIMENSIÓN DESEMPEÑO SOBRESALIENTE

Las tejas Duration® ofrecen:

- El gran desempeño de la tecnología SureNail®
- La gama de colores TruDefinition®
- Una garantía limitada de por vida*† mientras sea propietario de la vivienda
- La protección de una garantía contra vientos de hasta 210 km/h (130 mph)*
- Protección StreakGuard® con una garantía limitada de 25 años de resistencia a las algas^{3/5}
- Clasificación nominal 3 para resistencia a los impactos⁶ y puede ser aplicable a descuento por seguro del propietario⁷



Don't let black streaks lower the value or curb appeal of your home.

Owens Corning blends specialized copper-lined granules, developed by 3M, a leading producer of roofing granules, into our colorful shingles. This helps resist blue-green algae growth.

No deje que las manchas de algas afecten al valor o aspecto de su vivienda.

En sus coloridas tejas, Owens Corning añade gránulos especiales con recubrimiento de cobre, desarrollados por 3M, un productor líder de gránulos para techos. Esto ayuda a prevenir la proliferación de algas azul-verdosas.



THE FINISHING TOUCH

OWENS CORNING® HIP & RIDGE SHINGLES

Owens Corning® Hip & Ridge Shingles are uniquely color matched to TruDefinition® Duration® Shingles. The multiple color blends are only available from Owens Corning Roofing and offer a finished look for the roof.

EL TOQUE FINAL

TEJAS DE LIMATESA Y CUMBRERA DE OWENS CORNING®

Las tejas de limatesa y cumbrera de Owens Corning® se ofrecen en una exclusiva gama de colores para combinar con las tejas Duration® TruDefinition®. Esta gran variedad de combinaciones de colores es una exclusividad de Owens Corning Roofing para lograr techos con un acabado único.

⁶ Duration® Designer is tested in a laboratory setting and classified as a UL 2218 and FM 4473 Class 3 Impact-Resistant shingle. The results of this test do not guarantee that the shingle will resist all weather conditions. Hail damage is specifically excluded from coverage under the terms of its warranty.

⁷ Duration® Designer se prueba en un entorno de laboratorio y está clasificada como una teja resistente a impactos UL 2218 y FM 4473 Clase 3. Los resultados de esta prueba no garantizan que la teja resista a todas las condiciones climáticas. Los daños por granizo quedan expresamente excluidos de la cobertura conforme a los términos de su garantía.

TruDefinition®

DURATION®

Shingles with Patented SureNail® Technology | Tejas con tecnología patentada SureNail®



Amber¹



Antique Silver¹



Brownwood¹

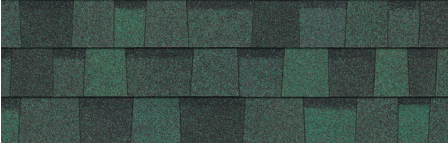

Chateau Green¹



Desert Rose¹



Driftwood¹



Estate Gray¹



Harbor Blue¹



Midnight Plum^{1/4}

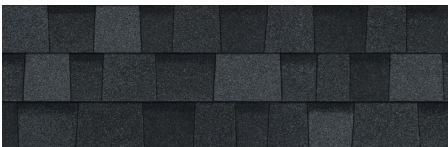

Onyx Black¹



Quarry Gray¹



Teak¹



Terra Cotta¹



Williamsburg Gray¹

COLOR DISCLAIMER

As color experts, we know getting the shingle color right is a big part of any roofing purchase. Due to printing color variations, in addition to viewing shingle literature, we suggest you request an actual shingle sample to see how it will appear on your home and with your home's exterior elements in various natural lighting conditions. Lastly, we recommend you verify your color choice by seeing it installed on an actual home; your roofing contractor or supplier can provide a sample and may be able to direct you to a local installation.

DESCARGO DE RESPONSABILIDAD SOBRE LOS COLORES

En tanto que especialistas en color, sabemos que obtener el color de teja perfecto es una parte importante en toda compra de techos. Debido a las variaciones en los colores impresos, además de mirar folletos de tejas, le sugerimos que solicite una muestra de la teja para ver como se verá en su hogar y con los elementos externos de la vivienda bajo distintas condiciones de luz natural. Finalmente, le recomendamos que para verificar su elección de colores, vea cómo lucen las tejas ya instaladas en una vivienda; su contratista de techos o su proveedor le pueden dar una muestra e incluso indicarle dónde ver un techo ya instalado.

THERE'S A LINE BETWEEN A GOOD SHINGLE AND A GREAT SHINGLE.®

It's the nailing line on your shingles. The difference between a good shingle and a great shingle is having Patented SureNail® Technology, only from Owens Corning.

HAY UNA GRAN DIFERENCIA ENTRE UNA BUENA TEJA Y UNA TEJA EXCELENTE™

Es la línea de clavado en su tejas. La diferencia entre una buena teja y una teja excelente es la tecnología patentada SureNail®, una exclusividad de Owens Corning.



Excellent Adhesive Power

Helps keep the shingle layers laminated.

Excelente poder adhesivo

Ayuda a conservar el laminado de las capas de las tejas.

Outstanding Grip

The SureNail® strip enhances the already amazing grip of our proprietary Tru-Bond®*** sealant for exceptional wind resistance of a 130-MPH wind warranty.

Agarre excepcional

La banda SureNail® mejora el excelente agarre de nuestro sellador patentado Tru-Bond®*** con una garantía de resistencia al viento excepcional de 210 km/h (130 mph).

Breakthrough Design

Patented SureNail® Technology is the first and only reinforced nailing zone on the face of the shingle.

Diseño innovador

La tecnología patentada SureNail® es la primera y la única que provee un área de clavado reforzada en la cara de la teja.

"No Guess" Wide Nailing Zone

This tough, engineered woven-fabric strip is embedded in the shingle to create an easy-to-see, strong, durable fastener zone.

Área de clavado ancha, sin cálculos "a ojo"

Esta banda resistente de tela mecánica tejida está incrustada en la teja para proveer un área de sujeción resistente, duradera y fácil de detectar.

Triple Layer Protection®*

A unique "triple layer" of reinforcement occurs when the fabric overlays the two shingle layers, providing increased protection against "nail pull" from the wind.

Triple Layer Protection®*

Cuando la tela cubre las dos capas de la teja, se forma una "triple capa" de refuerzo excepcional que ofrece una mayor protección ante el "arranque de clavos" debido al viento.

Double the Common Bond

SureNail® features up to a 200% wider bond between the shingle layers in the nailing zone over standard shingles.

Duplica la adherencia común

En comparación con las tejas comunes, SureNail® ofrece un área de unión hasta un 200 % más ancha entre las capas de la teja en el área de clavado.

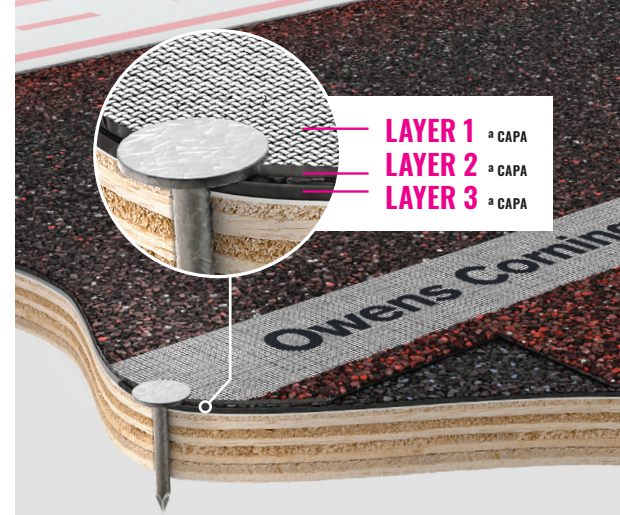

LAYER 1 CAPA
LAYER 2 CAPA
LAYER 3 CAPA

THE PROOF IS IN THE PERFORMANCE

LA PRUEBA ESTÁ EN EL DESEMPEÑO



Up to
2.5X
BETTER
NAIL PULL-THROUGH RESISTANCE

Hasta
2.5X
MEJOR
RESISTENCIA A LA TRACCIÓN DE LOS CLAVOS



Up to
9X
BETTER
NAIL BLOW-THROUGH RESISTANCE

Hasta
9X
MEJOR
RESISTENCIA AL DESPRENDIMIENTO DE LOS CLAVOS



Up to
2X
BETTER
DELAMINATION RESISTANCE

Hasta
2X
MEJOR
RESISTENCIA A LA DELAMINACIÓN



TOTAL PROTECTION SIMPLIFIED®

It takes more than just shingles to protect a home. It takes an integrated system of components and layers designed to perform in three critical areas. The Owens Corning® Total Protection Roofing System® gives you the assurance that all of your Owens Corning roofing components are working together to help increase the performance of your roof.

PROTECCIÓN TOTAL SIMPLIFICADA®

Se necesita más que simplemente tejas para proteger su vivienda. Se necesita un sistema integral de componentes y capas diseñadas para desempeñarse en tres áreas críticas. El Total Protection Roofing System® de Owens Corning® le garantiza que todos sus componentes para cubiertas de Owens Corning funcionan en conjunto para mejorar el desempeño de su techo.



Helps create a waterproof barrier
Ayuda a crear una barrera impermeable



Helps protect against nature's elements
Protege contra los elementos climáticos



For balanced attic ventilation
Para una ventilación equilibrada del ático

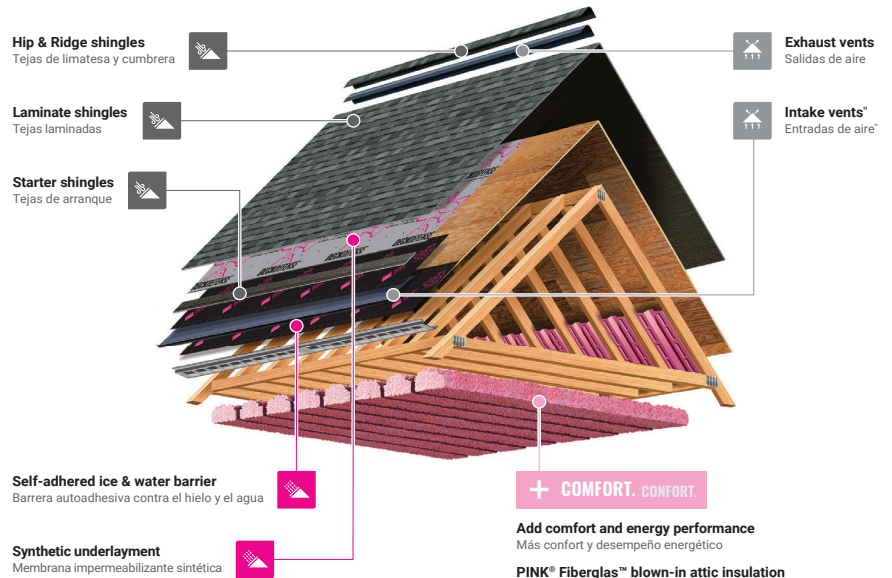

® For intake ventilation, use approved Owens Corning® Vent Sure® InFlow ventilation or soffit ventilation. Do not use both intake ventilation options in one roofing application. See install instructions for more details.
® Para la ventilación de entrada, utilice la ventilación aprobada por Owens Corning® Vent Sure® InFlow o ventilación de alero. No utilice ambas opciones de ventilación de entrada en una misma aplicación para techos. Consulte las instrucciones de instalación para obtener más detalles.

REGISTER YOUR WARRANTY

Registering your Owens Corning® limited warranty ensures it's easily referenced should you ever need to access it. The process is easy—just have your installation date, shingle type, shingle color and number of squares ready. Then go online to www.owenscorning.com/roofingstandardwarranty or call 1-800-ROOFING (1-800-766-3464) to finish the process.



REGISTRE SU GARANTÍA

El registro de su garantía limitada de Owens Corning® le garantiza que la pueda consultar fácilmente en caso de que necesite tener acceso a ella. El proceso es simple: tenga a mano la fecha de instalación, el tipo y color de tejas y la cantidad de cuadrados. Luego, visite www.owenscorning.com/roofingstandardwarranty o llame al 1-800-ROOFING (1-800-766-3464) para completar el proceso.



SCAN TO REGISTER YOUR WARRANTY

Escanee para registrar su garantía

Product Attributes

Warranty Length^{*†}

Limited Lifetime
(for as long as you own your home)

Wind Resistance Limited Warranty*

130-MPH

Algae Resistance Limited Warranty^{*§}

25 Years

TRU PROtection® Non-Prorated Limited Warranty* Period

10 Years



Características del producto

Período de garantía^{*†}

Garantía limitada de por vida
(mientras sea propietario de la vivienda)

Garantía limitada de resistencia al viento*

210 km/h (130 mph)

Garantía limitada de resistencia a las algas^{*§}

25 años

Período no prorrateado de garantía limitada TRU PROtection®*

10 años



TruDefinition® Duration® Shingles Product Specifications

Size	13¼" x 39¾"
Application Exposure	5%*
Shingles per Bundle	Not less than 20
Average Shingle Count per 3 Bundles	64
Average Coverage per 3 Bundles	98.4 sq. ft.

Especificaciones de las tejas Duration® TruDefinition®

Tamaño	33.65 × 100 cm (13¼ × 39¾ pulg)
Exposición de aplicación	14.3 cm (5% pulg)
Tejas por paquete	20 como mínimo
Cantidad promedio de tejas por 3 paquetes	64
Cobertura promedio por 3 paquetes	9.14 m ² (98.4 pies ²)

Applicable Standards and Codes

ASTM D3462

ASTM D228

ASTM D3018 (Type 1)

ICC-ES AC438[#]

ASTM D3161 (Class F Wind Resistance)

ASTM D7158 (Class H Wind Resistance)

ASTM E108/UL 790 (Class A Fire Resistance)

UL 2218 (Class 3 Impact Resistance)⁶

FM 4473 (Class 3 Impact Resistance)⁶

PRI ER 1378E01

Florida Product Approval

Miami-Dade County Product Approval²

Normas y códigos pertinentes

ASTM D3462

ASTM D228

ASTM D3018 (Tipo 1)

ICC-ES AC438[#]

ASTM D3161 (Resistencia al viento, Clase F)

ASTM D7158 (Resistencia al viento Clase H)

ASTM E108/UL 790 (Resistencia al fuego Clase A)

UL 2218 (Resistencia a impactos de clase 3)⁶

FM 4473 (Resistencia a impactos de clase 3)⁶

PRI ER 1378E01

Aprobación del producto en el estado de Florida

Producto aprobado por el condado de Miami-Dade²

* See actual warranty for complete details, limitations and requirements.

† 40-Year Limited Warranty on commercial projects.

+ Owens Corning testing against competing products with wide, single-layer nailing zones when following manufacturers' installation instructions and nailing in the middle of the allowable nailing zone.

** Tru-Bond® is a proprietary premium weathering-grade asphalt sealant that is blended by Owens Corning Roofing® and Asphalt, LLC.

+ The amount of Triple Layer Protection® may vary on shingle-to-shingle basis.

International Code Council Evaluation Services Acceptance Criteria for Alternative Asphalt Shingles.

^ Excludes non-Owens Corning® roofing products such as flashing, fasteners, pipe boots and wood decking.

1 See Color Disclaimer information on page 3 for additional details.

2 Applies to all areas that recognize Miami-Dade Notice of Acceptance (NOA).

3 Shingles are algae resistant to control the growth of algae and discoloration.

§ Installation must include use of an Owens Corning® Hip & Ridge product. See actual warranty for details.

4 Owens Corning® shingles include a patented design.

6 Duration® Designer is tested in a laboratory setting and classified as a UL 2218 and FM 4473 Class 3 Impact-Resistant shingle. The results of this test do not guarantee that the shingle will resist all weather conditions. Hair damage is specifically excluded from coverage under the terms of its warranty.

7 Homeowners should check with their insurance company to see if they qualify.

SureNail® Technology is not a guarantee of performance in all weather conditions.

For patent information, please visit owenscorning.com/patents.

* Consulte la garantía para obtener una lista completa de detalles, limitaciones y requisitos.

† Garantía limitada de 40 años para proyectos comerciales.

+ Ensayos comparativos de Owens Corning con productos de la competencia con zonas de clavado ancho de una sola capa cuando se siguen las instrucciones de instalación del fabricante y se clava en el medio de la zona de clavado permitida.

** Tru-Bond® es un sellador asfáltico patentado de calidad premium formulado por Owens Corning Roofing® and Asphalt, LLC.

+ La cantidad de Triple Layer Protection® puede variar entre una teja y otra.

Criterios de aceptación de los servicios de evaluación del Consejo Internacional de Códigos para tejas asfálticas alternativas.

^ Se excluyen productos para techos no fabricados por Owens Corning®, como tapajuntas, sujetadores, bases de tubos y estructuras de soporte de madera.

1 Para obtener más información, consulte el Descargo de responsabilidad sobre los colores, en la página 4.

2 Aplicable a todas las zonas que reconocen el Aviso de aceptación (NOA, Notice of Acceptance) del condado de Miami Dade.

3 Las tejas son resistentes a las algas para controlar su desarrollo y la decoloración.

§ La instalación debe incluir el uso de un producto para limatesa y cumbre de Owens Corning®.

4 Las tejas de Owens Corning® incluye un diseño patentado.

6 Duration® Designer se prueba en un entorno de laboratorio y está clasificada como una teja resistente a impactos UL 2218 y FM 4473 Clase 3. Los resultados de esta prueba no garantizan que la teja resista a todas las condiciones climáticas. Los daños por granizo quedan expresamente excluidos de la cobertura conforme a los términos de su garantía.

7 Los propietarios deben verificar con su aseguradora para saber si califican.

La tecnología SureNail® no es una garantía de desempeño en todos los tipos de condiciones climáticas.

Para información sobre la patente, visite www.owenscorning.com/patents.



OWENS CORNING ROOFING AND ASPHALT, LLC
ONE OWENS CORNING PARKWAY
TOLEDO, OH 43659 USA

1-800-GET-PINK® | 1-800-438-7465
www.owenscorning.com

Pub. No. 10024156-D. Printed in U.S.A. February 2026.
THE PINK PANTHER® & © 1964–2026 Metro-Goldwyn-Mayer Studios Inc.
All Rights Reserved. The color PINK is a registered trademark of Owens Corning.
© 2026 Owens Corning. All Rights Reserved.

(Jacksonville)

Pub. N.º 10024156-D. Impreso en EE.UU. Febrero de 2026.
THE PINK PANTHER™ y © 1964–2026 Metro-Goldwyn-Mayer Studios Inc.
Todos los derechos reservados. El color PINK es una marca registrada de Owens Corning. © 2026 Owens Corning. Todos los derechos reservados.