

FLORIDA MASTER SITE FILE
Site Inventory Form

FDAHRM 802 = =

Site No. (53952) 2836-002-002 809 = =
Survey Date 8303 820 = =

Site Name Drake, Trusten P., Jr. House 830 = =
Address of Site: 1226 S.E. 5th St. 905 = =

Instruction for locating 1226 S.E. 5th St.
Ocala, Fla. 32671 813 = =

Location: Oakleigh Park Lot 2, 3 ex. S. 48' of Lots 10 & 11. 868 = =

County: Marion BLK B LOT 2 INC 548' OF 3, 10, 11 808 = =

Owner of Site: Name: Wahle, J.P. & G.A. ;

Address: 1226 S.E. 5th St.

Ocala, Fla. 32671 902 = =

Type of Ownership PRIVATE 848 = = Recording Date 832 = =

Recorder: Name & Title: Tate, Suan (Preservation Architect) ;

Address: University of Florida - Collete of Architecture

Gainesville, Fla. 32611 818 = =

Condition of Site: Integrity of Site: Original Use Residence 838 = =

Check One	Check One or More	Present Use	Residence	850 = =
<input type="checkbox"/> Excellent 863 = =	<input checked="" type="checkbox"/> Altered 858 = =	Dates: Beginning C+ 1928 844 = =		
<input checked="" type="checkbox"/> Good 863 = =	<input type="checkbox"/> Unaltered 858 = =	Culture/Phase American 840 = =		
<input type="checkbox"/> Fair 863 = =	<input checked="" type="checkbox"/> Original Site 858 = =	Period 20th Century 845 = =		
<input type="checkbox"/> Deteriorated 863 = =	<input type="checkbox"/> Restored () (Date: X) 858 = =			
	<input type="checkbox"/> Moved () (Date: X) 858 = =			

NR Classification Category: Building 916 = =

Threats to Site:

Check One or More			
<input checked="" type="checkbox"/> Zoning (X) 878 = =	<input type="checkbox"/> Transportation (X) 878 = =		
<input checked="" type="checkbox"/> Development (X) 878 = =	<input type="checkbox"/> Fill (X) 878 = =		
<input type="checkbox"/> Deterioration (X) 878 = =	<input type="checkbox"/> Dredge (X) 878 = =		
<input type="checkbox"/> Borrowing (X) 878 = =			
<input type="checkbox"/> Other (See Remarks Below): 878 = =			

Areas of Significance: Architecture 910 = =

Significance:

This stucco residence is one of a block of excellent examples of Tudor Revival in this area. It is in Oakleigh Park Subdivision platted in 1929 and first appears on the Sanborn Map of 1930. Tursten Drake, Jr. was a member of the State Road Board and was instrumental in building highways throughout the County. His business holdings were in cattle and timber and he was a Director of the Monroe & Chambliss Bank.

911 = =

ARCHITECT _____ 872 = =
 BUILDER _____ 874 = =
 STYLE AND/OR PERIOD Tudor Revival 964 = =
 PLAN TYPE Rectangular, L shape 966 = =
 EXTERIOR FABRIC(S) Stucco/wood frame 854 = =
 STRUCTURAL SYSTEM(S) Wood frame 856 = =
 PORCHES _____ 942 = =
 FOUNDATION: Continuous wall 942 = =
 ROOF TYPE: Gable/hip 942 = =
 SECONDARY ROOF STRUCTURE(S): Flat dormer 942 = =
 CHIMNEY LOCATION: East end 942 = =
 WINDOW TYPE: 6/6 & 4/4 DHS 882 = =
 CHIMNEY: Brick 882 = =
 ROOF SURFACING: Asbestos shingle (simul shake) 882 = =
 ORNAMENT EXTERIOR: _____ 950 = =
 NO. OF CHIMNEYS One 952 = = NO. OF STORIES Two 954 = =
 NO. OF DORMERS Three _____
 Map Reference (incl. scale & date) _____ 809 = =
 Latitude and Longitude: _____ 800 = =
 _____ 833 = =
 Site Size (Approx. Acreage of Property): _____

LOCATION SKETCH OR MAP

N

Block 17

S.E. 5th Street

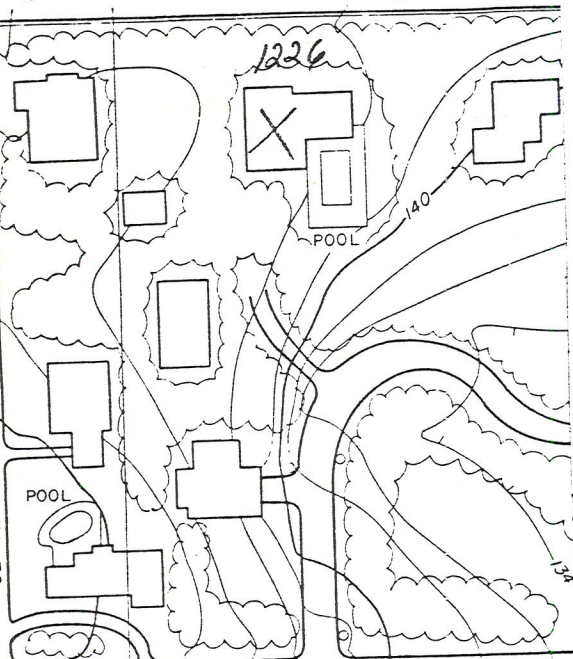

S.E. 7th Street

Township	Range	Section
15S	22E	SE1/4 17

812 = =

UTM Coordinates:

890 = =

Zone Easting Northing

photo - 83 N 41 # 7(4,5)

