

## imageRUNNER ADVANCE 4500 III Series

Black-and-White | Mid-Volume | Multifunction

Print up to 51 ppm (BW)

Scan up to 160 ipm (300 dpi) (BW/color, duplex)

Print up to 11" x 17"

6,350-sheet maximum paper capacity



Canon's comprehensive portfolio of imageRUNNER ADVANCE multifunction printers and integrated solutions can help **simplify** the end user experience and management of technology; better **control** sensitive information and print-related costs; and help ensure that technology investments proactively **evolve** with changing needs.



### WORKFLOW EFFICIENCY

- 10.1" intuitive touchscreen with smartphone-like usability.
- A unique, customized experience tailored to individual preferences using My ADVANCE.
- Supports mobile solutions and integration with many popular cloud services like Google Drive.<sup>1</sup>
- Scan and convert documents to searchable digital files in a variety of file formats.
- Integration with Canon and various third-party software with embedded application platform.



### SECURITY

- Advanced standard security feature set to help safeguard sensitive information and assist in regulatory compliance.
- Integrates with existing, third-party SIEM\* systems to help provide real-time, comprehensive insights into potential threats to the network and printers.
- Technology to verify that the device boot process, firmware, and applications initialize without alteration at startup. McAfee Embedded Control<sup>2</sup> utilizes a whitelist to protect against malware and tampering of firmware and applications.
- Security policy settings can be controlled with a dedicated password, configured from a central location, and exported to other supported devices.
- Control access to the device and specific features, using a host of flexible authentication methods—PIN code, user name/password, or card access.<sup>3</sup>



### QUALITY AND RELIABILITY

- Canon's signature reliability and engine technologies help keep productivity high and minimize the impact on support resources.
- Outstanding imaging technologies and toner allow for crisp text and consistent images in rich black-and-white tones.
- Designed to achieve maximum uptime with status notifications to help keep supplies replenished and intuitive maintenance videos for consumables replacement.

\* Security Information and Event Management





## DEVICE AND FLEET MANAGEMENT

- Designed for quick, easy deployment.
- Remote diagnostics and parts life management for proactive maintenance and rapid fixes.
- Easy and intuitive to monitor device status and consumable levels, turn off devices remotely, observe meter readings, manage settings, and implement security policies.
- Common firmware and regular updates with Unified Firmware Platform (UFP) for continuous improvements and consistency across a fleet.



## COST MANAGEMENT

- Track and assess print, copy, scan, and fax usage and allocate costs to departments or projects.
- Apply print policies and restrict usage by user to help reduce unnecessary printing and contribute to cost efficiency.
- Standard cloud-based solution provides a centralized dashboard with up-to-the-minute insights into printer activity.
- Upgrade to uniFLOW server or cloud-based solutions for full accounting and reporting for compatible Canon and third-party devices, pull printing, job routing, and powerful scan workflows.



## SUSTAINABILITY

- A combination of fusing technologies and low-melting-point toner minimizes power requirements and helps achieve low energy consumption.
- Encourage environmentally-conscious work practices by enabling multiple settings that can help save paper and energy.
- ENERGY STAR® certified and rated EPEAT® Gold.†

## CONFIGURATION OPTIONS

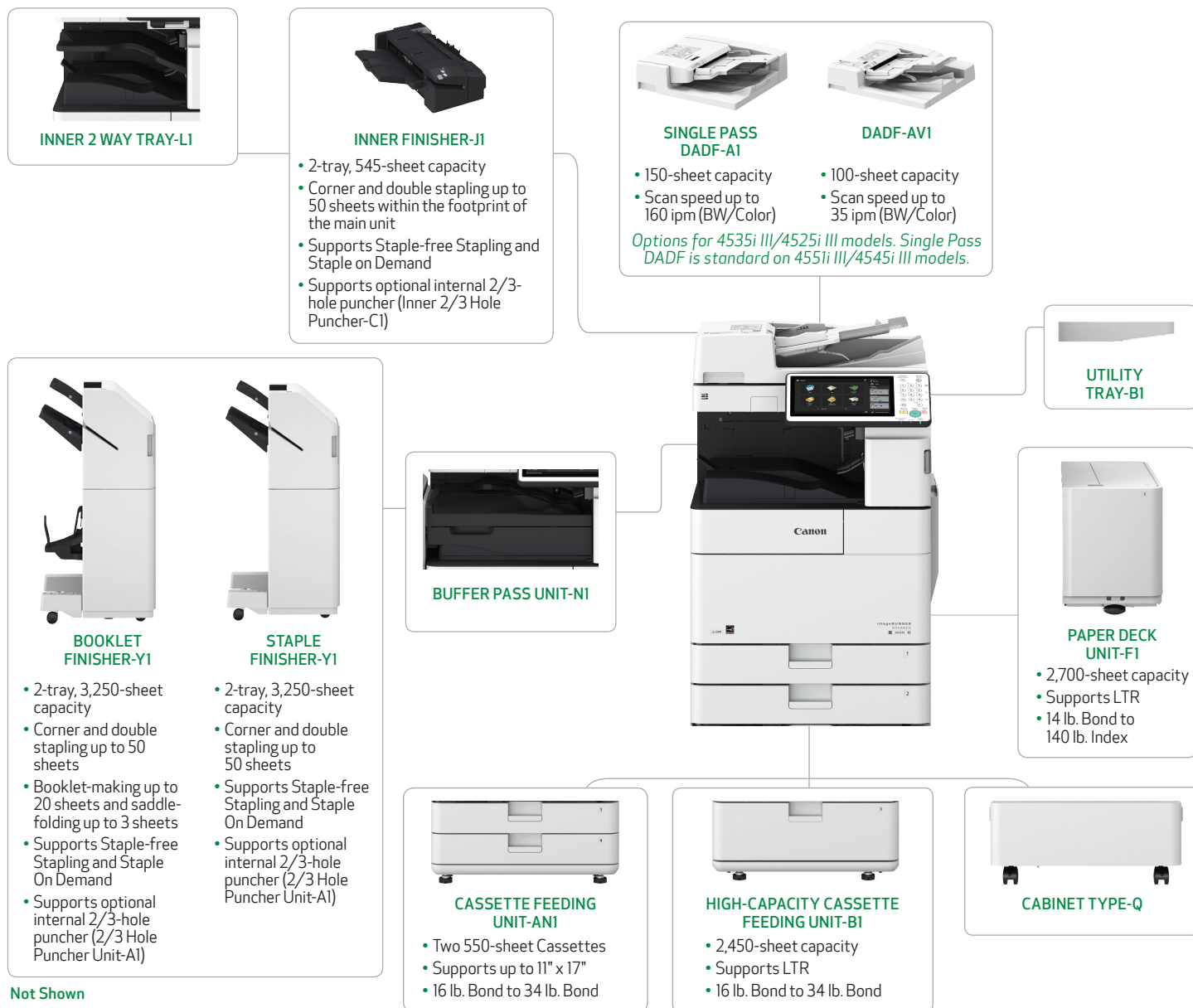

### Not Shown

- Inner 2/3 Hole Puncher-C1 (for Inner Finisher-JI)
- 2/3 Hole Puncher Unit-A1 (for External Finishers)
- Platen Cover Type-W

# SPECIFICATIONS

## Main Unit

### Type

Monochrome Laser Multifunctional

### Core Functions

Standard: Print, Copy, Scan, Send, Store  
Optional: Fax

### Processor

Canon Dual Custom Processor (Shared)

### Control Panel

10.1" TFT LCD WSVGA Color Touch-panel

### Memory

3.0 GB RAM

### Hard Disk Drive

Standard: 250 GB  
Maximum: 1 TB

### Print Resolution

1200 dpi x 1200 dpi

### Interface Connection

#### Network

Standard: 1000Base-T/100Base-TX/10Base-T,  
Wireless LAN (IEEE 802.11 b/g/n)

Optional: NFC, Bluetooth Low Energy

#### Others

Standard: USB 2.0 x2 (Host), USB 3.0 x1 (Host),  
USB 2.0 x1 (Device)

Optional: Serial Interface, Copy Control Interface

### Paper Capacity (LTR, 20 lb. Bond)

Standard: 1,200 Sheets  
Maximum: 6,350 Sheets

### Paper Sources (LTR, 20 lb. Bond)

Standard: Two 550-sheet Paper Cassettes,  
100-sheet Stack Bypass

Optional: Two 550-sheet Paper Cassettes (Cassette  
Feeding Unit-ANI), 2,450-sheet Paper Deck  
(High Capacity Cassette Feeding Unit-B1),  
2,700-sheet Paper Deck (Paper Deck  
Unit-F1)

### Paper Output Capacity (LTR, 20 lb. Bond)

Standard: 250 Sheets  
Maximum: 3,350 Sheets (with External Finishers)

### Finishing Capabilities

Standard: Collate, Group  
With Inner Collate, Group, Offset, Staple,  
Finisher: Hole Punch,<sup>5</sup> Staple-Free Staple,  
Staple On Demand

With External Collate, Group, Offset, Staple, Booklet,<sup>6</sup>  
Finisher: Staple-Free Staple, Staple On Demand,  
Hole Punch<sup>7</sup>

### Supported Media Types

Paper Thin, Plain, Recycled, Color, Heavy,  
Cassettes: Pre-punched  
Stack Bypass: Thin, Plain, Recycled, Color, Heavy,  
Pre-punched, Bond, Transparency,  
Label, Envelope

### Supported Media Sizes

Paper Legal, Letter, Letter-R, Executive,  
Cassette (1): Statement-R, Custom Size  
(5-1/2" x 7-1/8" to 11-3/4" x 15-3/8")

Paper 11" x 17", Legal, Letter, Letter-R, Executive,  
Cassette (2): Statement-R, Custom Size  
(5-1/2" x 7-1/8" to 11-3/4" x 17")

Stack Bypass: 11" x 17", Legal, Letter, Letter-R, Executive,  
Statement-R, Envelope [No.10 (COM10),  
Monarch, DL, ISO-C5], Custom Size (3-7/8" x  
5-7/8" to 11-3/4" x 17")

### Supported Media Weights

Paper Cassettes: 16 lb. Bond to 34 lb. Bond (60 to 128 g/m<sup>2</sup>)  
Stack Bypass: 14 lb. Bond to 80 lb. Cover (52 to 220 g/m<sup>2</sup>)  
Duplexing: 16 lb. Bond to 28 lb. Bond (60 to 105 g/m<sup>2</sup>)

### Warm-up Time

From Power On: Approx. 24 Seconds<sup>8</sup>

From Sleep

Mode: Approx. 10 Seconds<sup>9</sup>

Quick Startup

Mode: Approx. 4 Seconds<sup>10</sup>

### Dimensions (W x D x H)

23-1/8" x 29-1/8" x 47" (587 mm x 740 mm x 1,193 mm)<sup>11</sup>

### Installation Space (W x D)

Basic [With DADF (Stack Bypass and Cassette Drawers  
Open)]: 35" x 46-1/2" (889 mm x 1,182 mm)  
Fully Configured [With ADF+Paper Deck Unit-F1+  
Booklet Finisher-Y1 (Cassette Drawers Open)]:  
71-3/8" x 50-3/8" (1,811 mm x 1,280 mm)

### Weight

Approx. 240.3 lb. (109 kg)<sup>12</sup>

## Print Specifications

### Print Speed

4551i III: Up to 51 ppm (Letter); Up to 37 ppm  
(Letter-R); Up to 25 ppm (Legal);  
Up to 25 ppm (11" x 17")  
4545i III: Up to 45 ppm (Letter); Up to 32 ppm  
(Letter-R); Up to 25 ppm (Legal);  
Up to 22 ppm (11" x 17")  
4535i III: Up to 35 ppm (Letter); Up to 32 ppm  
(Letter-R); Up to 25 ppm (Legal);  
Up to 22 ppm (11" x 17")  
4525i III: Up to 25 ppm (Letter); Up to 17 ppm  
(Letter-R); Up to 13 ppm (Legal); Up to  
15 ppm (11" x 17")

### Standard Page Description Languages

UFR II, PCL<sup>®</sup>6, Adobe<sup>®</sup> PS<sup>®</sup>3

### Direct Print

Available from USB, Advanced Box, Remote UI,  
and Web Access<sup>13</sup>

### Supported File Types for Direct Print

PDF, TIFF, JPEG, EPS, XPS

### Fonts

PCL Fonts: 93 Roman, 10 Bitmap fonts, 2 OCR fonts,  
Andalé Mono WT J/K/S/T (Japanese,  
Korean, Simplified and Traditional Chinese),<sup>14</sup>  
Barcode Fonts<sup>15</sup>  
PS fonts: 136 Roman

### Operating System<sup>16</sup>

UFR II: Windows Server 2008/Windows<sup>®</sup> 7/Server  
2008 R2/Server 2012/Windows 8.1/Server  
2012 R2/Windows 10/Server 2016, MAC OS  
X (10.9 or later)  
PCL: Windows Server 2008/Windows 7/Server  
2008 R2/Server 2012/Server 2012 R2/  
Windows 10/Server 2016  
PS: Windows Server 2008/Windows 7/Server  
2008 R2/Server 2012/Windows 8.1/Server  
2012 R2/Windows 10/Server 2016, MAC OS  
X (10.9 or later)  
PPD: MAC OS X (10.3.9 or later), Windows 7/  
Windows 8/Windows 8.1/Windows 10

## Copy Specifications

### Copy Speed

4551i III: Up to 51 ppm (Letter); Up to 37 ppm  
(Letter-R); Up to 25 ppm (Legal);  
Up to 25 ppm (11" x 17")  
4545i III: Up to 45 ppm (Letter); Up to 32 ppm  
(Letter-R); Up to 25 ppm (Legal);  
Up to 22 ppm (11" x 17")  
4535i III: Up to 35 ppm (Letter); Up to 32 ppm  
(Letter-R); Up to 25 ppm (Legal);  
Up to 22 ppm (11" x 17")  
4525i III: Up to 25 ppm (Letter); Up to 17 ppm  
(Letter-R); Up to 13 ppm (Legal); Up to  
15 ppm (11" x 17")

### First-Copy-Out Time (Letter)

4551i III: As fast as 3.7 seconds  
4545i III: As fast as 3.8 seconds  
4535i III: As fast as 3.8 seconds  
4525i III: As fast as 5.2 seconds

### Copy Resolution (dpi)

Reading: Up to 600 x 600  
Printing: 1200 x 1200

### Multiple Copies

Up to 9,999 Copies

### Copy Exposure

Automatic or Manual (9 Levels)

### Magnification

25%-400% (1% Increments)

### Preset Reductions

25%, 50%, 64%, 73%, 78%

### Preset Enlargements

121%, 129%, 200%, 400%

### Basic Copy Features

Preset Reduction/Enlargement Ratios by Area, Paper  
Setting, Previous Settings, Favorite Settings, Finishing,  
Two-Sided, Density Adjustment, Original Type Selection,  
Interrupt Mode, Setting Confirmation/Cancel

### Special Copy Features

Book to Two Pages, Two-sided Original, Finishing, Booklet,  
Job Build, N on 1, Add Cover, Insert Sheets, Different-size  
Originals, Density Adjustment, Original Type Selection,  
Transparency Cover Sheets, Page Numbering, Copy Set  
Numbering, Sharpness, Erase Frame, Secure Watermark,  
Print Date, Shift, Gutter, Print & Check, Negative/Positive,  
Repeat Images, Merge Job Blocks, Job Done Notice, Mirror  
Image, Store in Mail Box, Superimpose Image, Cascade  
Copy, Copy ID Card, Detect Feeder Multi Sheet Feed,  
Free Size Original

## Scan Specifications

### Type

4551i III/4545i III: Standard Single Pass Duplexing Automatic  
Document Feeder  
4535i III/4525i III: Optional Single Pass Duplexing Automatic  
Document Feeder or Duplexing Automatic  
Document Feeder or Platen Cover

### Document Feeder Paper Capacity

Single Pass DADF-A1: 150 Sheets (20 lb. Bond)  
DADF-AV1: 100 Sheets (20 lb. Bond)

### Document Feeder Supported Media Sizes

11" x 17", Legal, Letter, Letter-R, Statement, Statement-R

### Document Feeder Supported Media Weights

Single Pass DADF-A1  
BW Original: 13 lb. Bond to 58 lb. Cover  
(50 to 157 g/m<sup>2</sup>)  
CL Original: 17 lb. Bond to 58 lb. Cover  
(64 to 157 g/m<sup>2</sup>)

### DADF-AV1

BW Original: 13 lb. Bond to 34 lb. Bond  
(50 to 128 g/m<sup>2</sup>)  
CL Original: 17 lb. Bond to 34 lb. Bond  
(64 to 128 g/m<sup>2</sup>)

### Platen Acceptable Originals

Sheet, Book, 3-Dimensional Objects [Height: Up to 2"  
(50mm); Up to 4.4 lb. (2 kg)]

### Platen Supported Media Size

Max. scanning size: 11-3/4" x 17" (297 mm x 431.8 mm)

### Pull Scan

Color Network ScanGear2 for both Twain and WIA  
Supported OS: Windows 7/8.1/10  
Windows Server 2008/Server 2008 R2/  
Server 2012/Server 2012 R2/Server 2016

### Scan Resolution (dpi)

600 x 600, 400 x 400, 300 x 300, 200 x 400, 200 x 200,  
200 x 100, 150 x 150, 100 x 100

### Scan Speed (Letter)

Single Pass DADF-A1  
Single-sided Scanning  
BW: 80 ipm (300 dpi)/80 ipm (600 dpi)  
Color: 80 ipm (300 dpi)  
Double-sided Scanning  
BW: 160 ipm (300 dpi)/150 ipm (600 dpi)  
Color: 160 ipm (300 dpi)

### DADF-AV1

Single-sided Scanning  
BW: 70 ipm (300 dpi)/51 ipm (600 dpi)  
Color: 70 ipm (300 dpi)  
Double-sided Scanning  
BW: 35 ipm (300 dpi)/25.5 ipm (600 dpi)  
Color: 35 ipm (300 dpi)

## Send Specifications

### Destination

Email/Internet Fax (SMTP), SMB v3.0, FTP, WebDAV,  
Mail Box, Super G3 Fax (Optional), IP Fax (Optional)

### Address Book

LDAP (2,000)/Local (1,600)/Speed dial (200)

## Send Resolution (dpi)

600 x 600, 400 x 400, 300 x 300, 200 x 400, 200 x 200,  
200 x 100, 150 x 150, 100 x 100

## Communication Protocol

File: FTP (TCP/IP), SMB v3.0, WebDAV  
Email: SMTP, POP3

## File Format

Standard: TIFF, JPEG, PDF Device Signature  
(Encrypted, Compact, Searchable,  
Apply Policy, Optimize for Web, PDF A/1-b,  
Device Signature), XPS (Device Signature,  
Compact, Searchable), Office Open XML  
(PowerPoint®, Word)  
Optional: PDF (User Signature, Trace & Smooth), XPS  
(User Signature)

## Universal Send Features

Original Type Selection, Two-sided Original, Book to Two Pages,  
Different-size Originals, Density Adjustment, Sharpness, Copy  
Ratio, Erase Frame, Job Build, Delayed Send, Preview, Job Done  
Notice, File Name, Subject/Message, Reply-to, Email Priority,  
TX Report, Original Content Orientation, Skip Blank Originals,  
Detect Feeder Multi Sheet Feed

## Fax Specifications (Optional)

### Maximum Number of Connection Lines

4

### Modem Speed

Super G3: 33.6 Kbps  
G3: 14.4 Kbps

### Compression Method

MH, MR, MMR, JBIG

### Resolution (dpi)

400 x 400, 200 x 400, 200 x 200, 200 x 100

### Sending/Recording Size

Statement-R to 11" x 17"

### Fax Memory

Up to 30,000 Pages

### Speed Dials

Max. 200

### Group Dials/Destinations

Max. 199 Dials

### Sequential Broadcast

Max. 256 Addresses

### Memory Backup

Yes

### Fax Features

Original Type Selection, Two-sided Original, Book to Two  
Pages, Different-size Originals, Density for Scanning,  
Sharpness, Copy Ratio, Erase Frame, Job Build, Sender's  
Name (TTI), Select Line, Selecting the Telephone Line, Direct  
Send, Delayed Send, Preview, Job Done Notice, TX Report,  
Detect Feeder Multi Sheet Feed

## Store Specifications

### Mail Box (Number Supported)

100 User In-boxes, 1 Memory RX In-box, 50 Confidential  
Fax In-boxes, 30,000 Maximum Pages Stored

### Advanced Box

Communication Protocol: SMB or WebDAV  
Supported  
Client PC: Windows (Windows 7/8.1/10)  
Concurrent Connections (Max.)  
SMB: 64  
WebDAV: 3 (Active Sessions)

### Advanced Box Available Disk Space

Approx. 16 GB (Standard HDD)  
Approx. 480 GB (With Optional 1 TB HDD)

### Advanced Box Features

Authentication for Advanced Box Log-in, Sort Function,  
Printing a PDF File with a Password, imageWARE Secure  
Audit Manager Support

### Memory Media

Standard: USB

## Security Specifications

### Authentication

Standard: Universal Login Manager, uniFLOW  
Online Express,<sup>17</sup> User Authentication,  
Department ID Authentication,  
Access Management System,  
Device and Function Level Log-in  
Optional: uniFLOW

### Data

Standard: Trusted Platform Module (TPM),  
Hard Disk Password Lock, Hard Disk  
Drive Erase, Mail Box Password Protection,  
Hard Disk Drive Encryption (FIPS140-2  
Validated), Verify System at Startup,  
McAfee Embedded Control<sup>2</sup>  
Optional: Hard Disk Drive Mirroring, Hard Disk Drive  
removal, IEEE 2600.2 Common Criteria  
Certification, Data Loss Prevention  
(Requires uniFLOW)

### Network

Standard: Encrypted Secure Print, IP/Mac  
Address Filtering, IPsec, TLS Encrypted  
Communication, SNMP V3.0, IEEE  
802.1X, IPv6, SMTP Authentication, POP  
Authentication before SMTP, S/MIME,  
SIEM Integration

### Document

Standard: Secure Watermark, Secure Print,  
Forced Hold Printing, Adobe LiveCycle®  
Rights Management ES2.5 Integration,  
Encrypted PDF, Encrypted Secure  
Print, Device Signatures  
Optional: User Signatures, Document Scan Lock

## Environmental Specifications

### Operating Environment

Temperature: 50 to 86°F  
Humidity: 20 to 80% RH (Relative Humidity)

### Power Requirements

455i III: 120-127 V AC, 60 Hz, 10.4 A  
4545i III/4535i III: 120-127 V AC, 60 Hz, 9.3 A  
4525i III: 120-127 V AC, 60 Hz, 7 A

### Plug (Main Unit)

NEMA 5-15P

### Power Consumption

Maximum: Approx. 1,500 W  
Standby: Approx. 38 W<sup>18</sup>  
Sleep Mode: Approx. 0.9 W<sup>19</sup>  
Typical Electricity Consumption (TEC) Rating<sup>20</sup>  
455i III: 0.70 kWh  
4545i III: 0.62 kWh  
4535i III: 0.52 kWh  
4525i III: 0.32 kWh

### Standards

ENERGY STAR® Certified  
Rated EPEAT® Gold<sup>4</sup>

## Consumables

### Toner

GPR-57 Toner BK

### Toner Yield (Estimated @ 6% Coverage)

Black: 42,100 Images

- <sup>1</sup> Subscription to a third-party cloud service required. Subject to third-party cloud service provider's terms and conditions.
- <sup>2</sup> Requires Unified Firmware Platform v3.9.
- <sup>3</sup> Requires additional option.
- <sup>4</sup> For current EPEAT rating (Gold/Silver/Bronze), please visit [www.epeat.net](http://www.epeat.net).
- <sup>5</sup> Requires the optional Inner 2/3 Hole Puncher-C1.
- <sup>6</sup> Booklet Finisher-Y1 only.
- <sup>7</sup> Requires the optional 2/3 Hole Puncher Unit-A1.
- <sup>8</sup> Time from device power-on, until copy ready (not print reservation).
- <sup>9</sup> Time from exiting Sleep Mode to when printings is operational.
- <sup>10</sup> Time from device power-on to when key orientations can be performed on the touch panel display.
- <sup>11</sup> Includes Main Unit, Single Pass DADF-A1, and Cassette Feeding Unit-A1.
- <sup>12</sup> Includes Main Unit, Single Pass DADF-A1, Cassette Feeding Unit-A1, and consumables.
- <sup>13</sup> PDF print from Web sites is supported.
- <sup>14</sup> Requires the optional PCL International Font Set-A1.
- <sup>15</sup> Requires the optional Barcode Printer Kit-D1.
- <sup>16</sup> Other operating systems and environments including AS/400, UNIX, Linux and Citrix may be supported. Some of these solutions are chargeable. SAP Device Types are available via the SAP Market Place. For more information, contact your sales representative.
- <sup>17</sup> No charge for this solution; however activation is required.
- <sup>18</sup> Reference Value (measured one unit).
- <sup>19</sup> 0.9 W sleep mode not available in all circumstances due to certain settings.
- <sup>20</sup> Based on ENERGY STAR Product Specification for Imaging Equipment Version 3.0.

For detailed specifications and a comprehensive list of optional accessories, see the imageRUNNER ADVANCE 4500i III Series Specifications document.

**Canon**  
CANON SOLUTIONS AMERICA

For more information, call or visit  
1.800.815.4000 CSA.CANON.COM



As an ENERGY STAR® Partner, Canon U.S.A., Inc. has certified these models as meeting the ENERGY STAR energy efficiency criteria through an EPA recognized certification body. ENERGY STAR and the ENERGY STAR mark are registered U.S. marks. AirPrint and the AirPrint logo are trademarks of Apple Inc. Canon, imageRUNNER, imageWARE, imagePASS, and the GENUINE logo are registered trademarks or trademarks of Canon Inc. in the United States and may also be registered trademarks or trademarks in other countries. McAfee and the McAfee logo are trademarks of McAfee LLC in the US and/or other countries. Canon products offer certain security features, yet many variables can impact the security of your devices and data. Canon does not warrant that use of its features will prevent security issues. Nothing herein should be construed as legal or regulatory advice concerning applicable laws; customers must have their own qualified counsel determine the feasibility of a solution as it relates to regulatory and statutory compliance. All other referenced product names and marks are trademarks of their respective owners. All printer output images are simulated. All features presented in this brochure may not apply to all Series and/or products and may be optional; please check with your Canon Solutions America Sales Representative for details. Products shown with optional accessories. Canon U.S.A. and Canon Solutions America do not provide legal counsel or regulatory compliance consultancy, including without limitation, Sarbanes-Oxley, HIPAA, GLBA, Check 21 or the USA Patriot Act. Each customer must have its own qualified counsel determine the advisability of a particular solution as it relates to regulatory and statutory compliance. Specifications and availability subject to change without notice. Not responsible for typographical errors.  
©2019 Canon U.S.A., Inc. All rights reserved.

**McAfee**  
McAfee Embedded Control

**CANON**  
GENUINE  
TONER, CARTRIDGE  
& PARTS

**epeat**  
GOLD

**ENERGY STAR**

To learn about Canon's many awards, visit  
[ess.csa.canon.com/awards](http://ess.csa.canon.com/awards).