

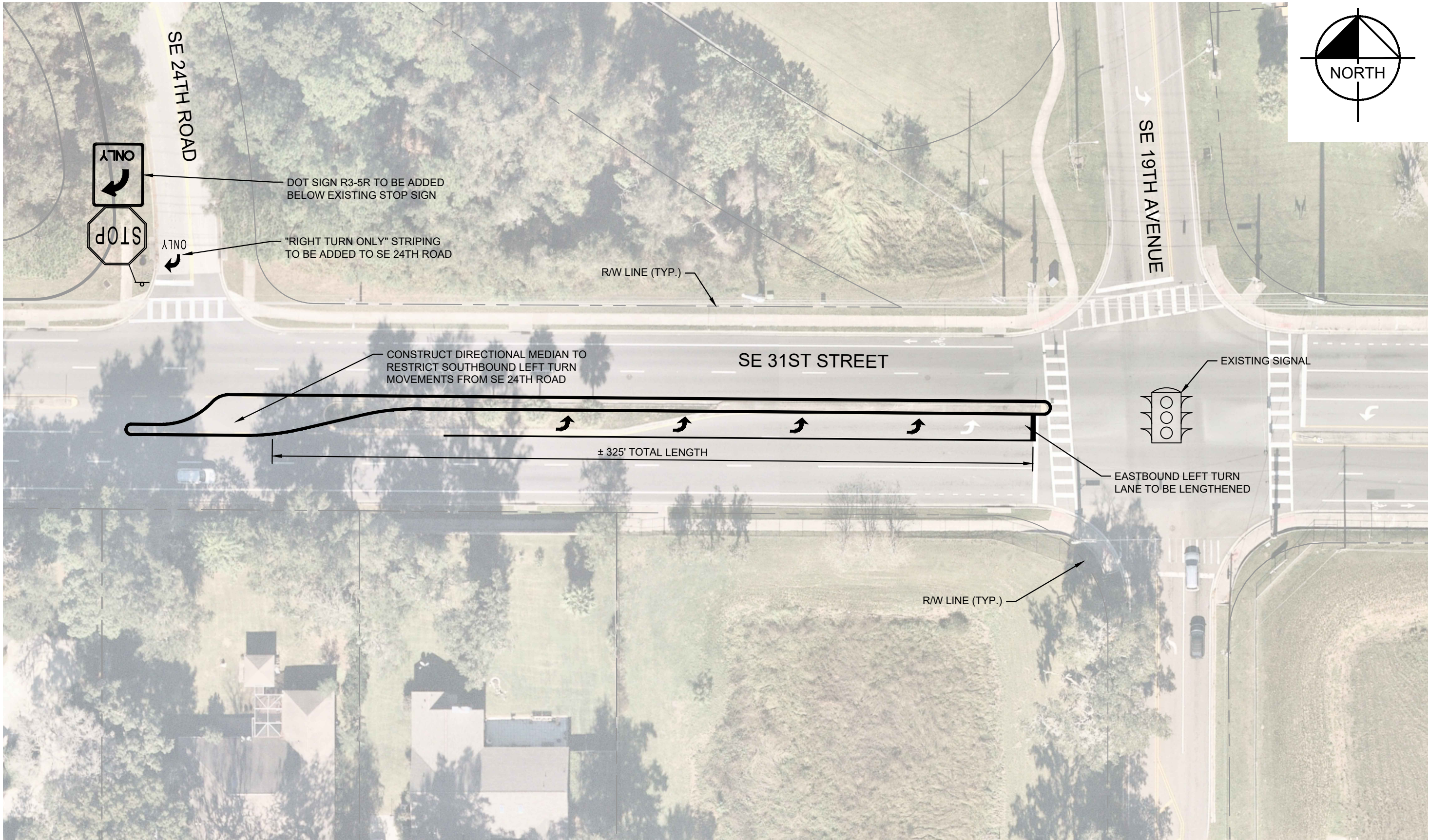

Kimley-Horn and Associates, Inc. 1700 SE 17th Street, Suite 200, Ocala, Florida 34471
This document, together with the concepts and designs presented herein, is intended only for the specific purpose and client for which it was prepared. Reuse of and improper reliance on this document without written authorization and adaptation by Kimley-Horn and Associates, Inc. shall be without liability to Kimley-Horn and Associates, Inc.
KHA PROJECT 242197000 DATE DECEMBER 2023 SCALE 1" = 40' DESIGNED BY KHA DRAWN BY KHA CHECKED BY KHA CITY OF OCALA FLORIDA



No.	REVISIONS	DATE	BY



© 2023 KIMLEY-HORN AND ASSOCIATES, INC.
1700 SE 17TH STREET, SUITE 200, OCALA, FLORIDA 34471
PHONE: 352-438-3000
WWW.KIMLEY-HORN.COM REGISTRY NO. 35106

KHA PROJECT 242197000
DATE DECEMBER 2023
SCALE 1" = 40'
DESIGNED BY KHA
DRAWN BY KHA
CHECKED BY KHA

SE 31ST STREET MULTI-FAMILY
SE 31ST STREET IMPROVEMENTS
CONCEPTUAL SKETCH

CITY OF OCALA

FLORIDA

TRAFFIC IMPROVEMENTS
EXHIBIT

SHEET NUMBER
EX-B