

CASE MAP

P&Z Meeting: November 13, 2024

Case Number: ANX24-45820
Parcel: 21537-002-00

Location Map

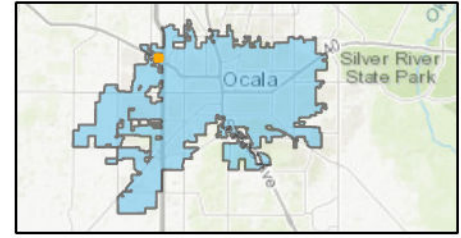

Property Size: Approximately 1.29 acres
Land Use Designation: Commercial (County)
Zoning: B-2, Community Business (County)
Proposal: A request to annex parcel 21537-002-00 (approximately 1.29 acres) from Marion County.

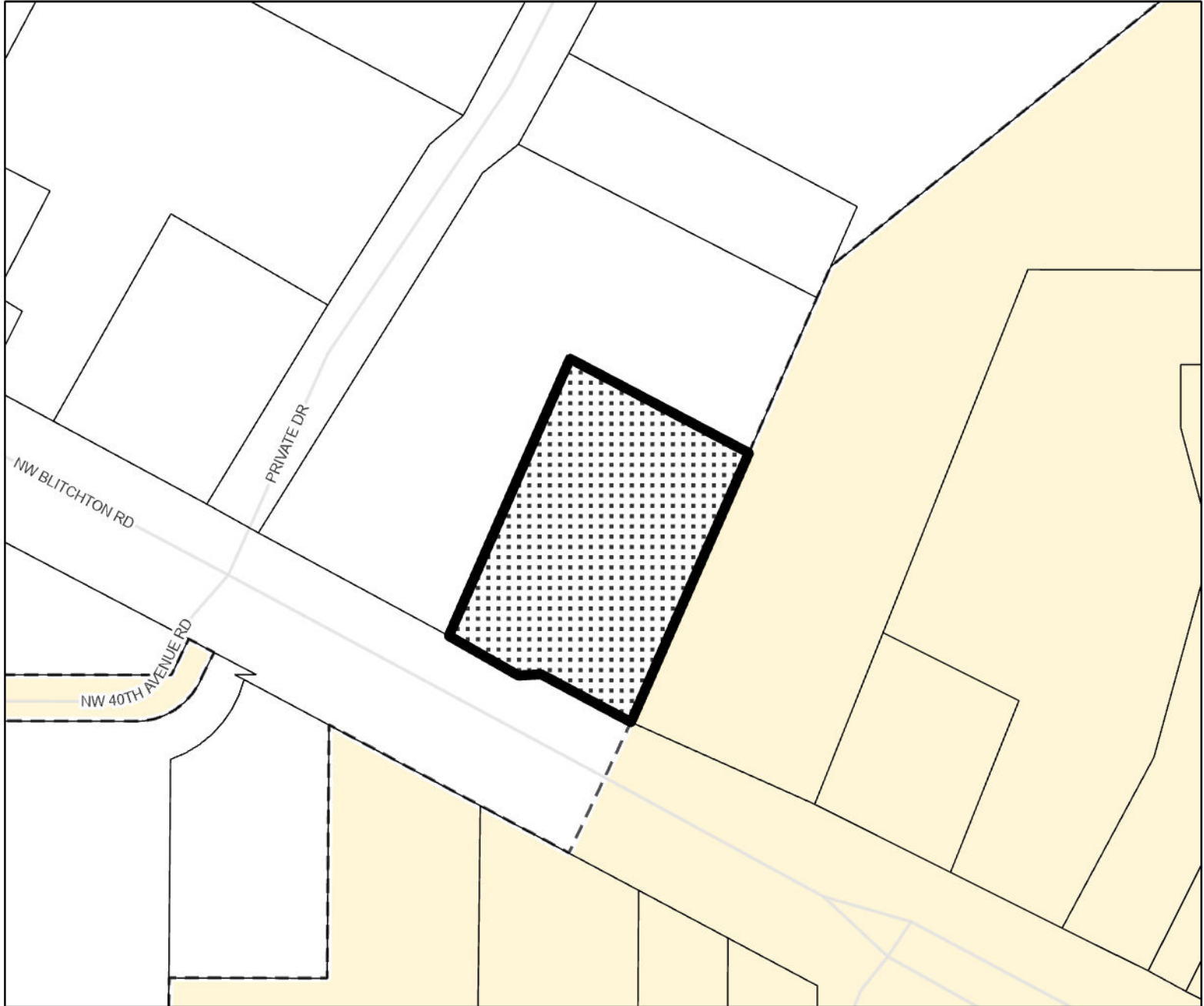

-  Parcels
-  Subject Property



Prepared by the City of Ocala
Growth Management Department
by ewjohnson on 10/23/2024