

CA. 23 extn activation

✓ 12/88 (old parcel #)
new parcel # 7/89

STATE OF FLORIDA
DEPARTMENT OF STATE
Division of Archives, History
and Records Management
DS-HSP-3AAA Rev. 3-79

FLORIDA MASTER SITE FILE Site Inventory Form

FDAHRM 802 = =
1009 = =
2820-029-004

Site Name Phillips, Mary W. House 830 = = Site No. 69-51813 1981
Address of Site: 726 S.E. 3rd St. Survey Date 1981
Instruction for locating Fourth house east of S.E. Sanchez Ave. on the south side
of S.E. 3rd St. 813 = =
Location: Caldwells AD Ocala Com 210 Ft E & 70 Ft N of SW Cor Lot 29 868 = =
County: Marion - Thence E 70 Ft N 140 Ft W 70 Ft S 140 Ft 808 = =
Owner of Site: Name: Hunt, Joyce J
Address: 726 SE 3rd St. 902 = =
Ocala, FL 32670 832 = =
Type of Ownership Private 848 = = Recording Date

Recorder:

Name & Title: Withlacoochee Regional Planning Council, Joyce Cusick, Assoc.
Address: 1241 S.W. 10th St. Planner
Ocala, FL 32670 818 = =

Condition of Site: Integrity of Site: Original Use Residence 838 = =

Check One: Check One or More
☒ Excellent 863 = = ☐ Altered 858 = =
☐ Good 863 = = ☒ Unaltered 858 = =
☐ Fair 863 = = ☒ Original Site 858 = =
☐ Deteriorated 863 = = ☐ Restored () (Date:) 858 = =
☐ Moved () (Date:) 858 = =

Present Use Residence 850 = =
Dates: Beginning CA: 1895 844 = =
Culture/Phase American 840 = =
Period 845 = =

NR Classification Category: 916 = =

Threats to Site:

Check One or More
☐ Zoning () 878 = = ☐ Transportation () 878 = =
☒ Development () 878 = = ☐ Fill () 878 = =
☐ Deterioration () 878 = = ☐ Dredge () 878 = =
☐ Borrowing () 878 = =
☐ Other (See Remarks Below): 878 = =

Areas of Significance: Architecture 910 = =

Significance:

An example of a Victorian frame vernacular carpenter style house exhibiting Gothic (details) architectural influences. The house is in scale and character with its surroundings, a residential Victorian neighborhood which has evolved from the 1880's through the early 1900's.

911 = =

ARCHITECT _____ 872 = =
 BUILDER _____ 874 = =
 STYLE AND/OR PERIOD frame vernacular carpenter style Gothic infl. 964 = =
 PLAN TYPE central 966 = =
 EXTERIOR FABRIC(S) shiplap 854 = =
 STRUCTURAL SYSTEM(S) frame 856 = =
 PORCHES front
 Balcony 2nd story - shed roof 942 = =
 FOUNDATION: brick pier 942 = =
 ROOF TYPE: gable 942 = =
 SECONDARY ROOF STRUCTURE(S): shed over porch/modified hip over back 942 = =
 CHIMNEY LOCATION: east side interior bay 942 = =
 WINDOW TYPE: double hung 942 = =
 CHIMNEY: brick 882 = =
 ROOF SURFACING: asbestos shingle 882 = =
 ORNAMENT EXTERIOR: fish scale shingle, rafter brackets, ginger- 882 = =
 NO. OF CHIMNEYS 1 952 = = NO. OF STORIES 2 bread. 950 = =
 NO. OF DORMERS double bay element west face 954 = =
 Map Reference (Incl. scale & date) USGS Ocala West - #447 - 7.5 Min. - 1964
 809 = =
 Latitude and Longitude: _____ 800 = =
 Site Size (Approx. Acreage of Property): _____ 833 = =

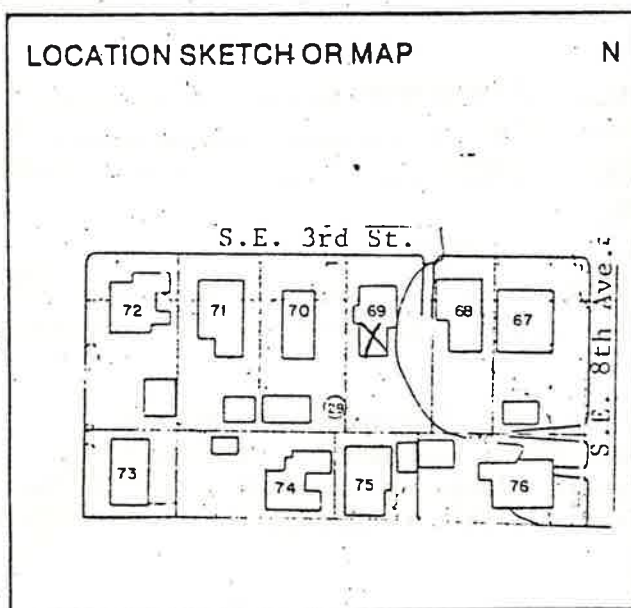

Photographic Records Numbers _____

81N70#8 (1920)

84N 312 #22 (34)

Contact Print

