

APPLICATION PACKAGE

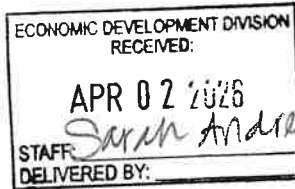

City of Ocala
 Growth Management Department
 201 S.E. 3rd Street, 2nd Floor
 352-629-8421 | www.ocalafl.gov



DATE SUBMITTED: 3/30/26
 GRANT ID: CRA26-0010
 (STAFF ONLY)

RESIDENTIAL
 COMMERCIAL

CRA GRANT APPLICATION

1. PROPERTY OWNER INFORMATION

Property Owner Name The Forge at Madison Commons, LLC
 Property Owner Mailing Address 343 NE 1st Avenue, Unit 5, Ocala, FL 34470 (28234-010-00)
 E-mail sheila.gibson88@yahoo.com Phone No. 352-581-9911
 Authorized Representative (If different from property owner) Joel Gibson
 E-mail joelgibson88@gmail.com Phone No. 352-581-9911

2. BUSINESS INFORMATION

REQUIRED FOR COMMERCIAL GRANTS PROGRAMS ONLY

Business Name The Forge
 Type of Business 343 NE 1st Ave., Unit 5, Ocala FL
 Business Address 343 NE 1st Ave., Unit 5, Ocala FL
 Business E-mail hello@theforgeocala.com Business Phone No. 352-230-9600
 Primary Contact (If different from applicant) Joel or Sheila Gibson
 How long has the business been at its current location? 3 Years
 If the business is a tenant, what are the start and end date of the lease? N/A

3. CRA SUBAREA

West Ocala East Ocala North Magnolia Downtown

4. PROGRAM TYPE

Residential Commercial Historic Building
 New Construction Incentive

APPLICANT MUST REVIEW PROGRAM GUIDE AND GRANT FRAMEWORK BEFORE SELECTING THE APPLICABLE PROGRAM TYPE

5. PROJECT DESCRIPTION

Project Site Address 343 NE 1st Ave, Unit 5, Ocala FL 34470 Parcel ID 28234-010-00
 Current Use of Property Restaurant/Retail/Entertainment Proposed Use Same
 Proposed Scope of Work (Attach additional sheets if needed)

Please make reference to the document attach titled: Community Redevelopment Agency (CRA Grant Application for The Forge

Explain your need for grant assistance and the expected benefits of your project (Attach additional sheets if needed)

See note above

RESIDENTIAL PROPERTIES ONLY

Rental Property Yes No Is this your primary residence? Yes No
 How long have your resided at the home? _____ What is the size of your household? _____

GRANT ID: _____

6. PROJECT COSTS

APPLICANT MUST SUBMIT TWO QUOTES FOR EACH WORK ITEM

Work Item 1 Kitchen Improvements-See Attached
Work Item 2 Interior and Exterior Restoration
Work Item 3 See Attached

High Quote 1: _____
High Quote 2: _____
High Quote 3: _____
Total: 0 _____

Low Quote 1: _____
Low Quote 2: _____
Low Quote 3: _____
Total: 0 _____

*IF MORE THAN 3 WORK ITEMS, ATTACH
ADDITIONAL SHEET

7. SCHEDULE

Start Date: 5/1/26

Estimated Time For Completion (Weeks/Months): 2 Months

8. APPLICATION CHECKLIST

- REVIEW OF APPROPRIATE GRANT PROGRAM FRAMEWORK (SEE PROGRAM GUIDE)
- COMPLETED APPLICATION
- APPLICANT/PROPERTY OWNER SIGNATURE AFFIXED
- PROOF OF PROPERTY OWNERSHIP
- PROOF OF CURRENT PROPERTY TAXES
- IMAGES OR SKETCHES OF PROPOSED DESIGNS, COLORS OR GRAPHICAL REPRESENTATIONS
- AT LEAST TWO QUOTES PROVIDED WITH AN ITEMIZED LIST OF COST ESTIMATES FROM VENDORS
- COLOR IMAGES OF EXISTING CONDITIONS OF THE BUILDING/PROJECT AREA

9. SUPPLEMENTAL INFORMATION

USE THIS SECTION TO PROVIDE ANY ADDITIONAL INFORMATION THAT MAY ASSIST IN THE REVIEW OF YOUR APPLICATION

We attached the following documents to the application:

- 1- 40' Container Shell (Anchorage) Blueprints
- 2- Pictures of the Containers (Permanent Structures)
- 3- Design of Heating and A/C for Containers
- 4-Property Tax Card

GENERAL TERMS AND CONDITIONS

It is expressly understood and agreed that the applicant shall be solely responsible for all safety conditions and compliance with all safety regulations, building codes, ordinances, and other applicable regulations.

It is expressly understood and agreed that the applicant will not seek to hold the City of Ocala, the Grant Review Committee (Committee) and/or its agents, employees, board members, officers and/or directors liable for any property damage, personal injury, or other loss relating in any way to the Program.

It is expressly understood and agreed that the applicant will hold harmless the City, its agents, officers, employees and attorneys for all costs incurred in additional investigation or study of, or for supplementing, redrafting, revising, or amending any document (such as an Environmental Impact Report, specific plan, or general plan amendment) if made necessary by said proceeding and if the applicant desires to pursue such approvals and/or clearances, after initiation of the proceeding, which are conditioned on the approval of these documents.

The applicant authorizes the City of Ocala to promote any approved project including but not limited to displaying a sign at the site, during and after construction, and using photographs and descriptions of the project in City of Ocala materials and press releases.

If the applicant fails to perform the work approved by the Community Redevelopment Agency Board, the City reserves the right to cancel the grant. The applicant also understands that any work started/completed before the application is approved by the Committee is done at their own risk, and that such work will jeopardize their grant award.

Completion of this application by the applicant DOES NOT guarantee that grant monies will be awarded to the applicant.

I certify that all of the foregoing information is accurate and that the work will be performed in accordance with the Program Guide and all applicable construction and zoning laws.

<p align="center">APPLICANT (PROPERTY OWNER/AUTHORIZED REPRESENTATIVE)</p>	<p align="center">OWNER APPROVAL FOR TENANT APPLICANT</p>
<p>I, <u>JOEL GIBSON</u>, property owner/authorized representative of the property at <u>343 NE 1ST AVE OCALA FL</u>, have read and understand the terms and conditions of the Program and agree to the general conditions and terms outlined in the application process and guidelines of the Program.</p> <p>SIGNATURE: <u></u> DATE: <u>3/29/26</u></p>	<p>I, _____, owner of the property at _____ have read and understand the terms and conditions of the Program and agree to the general conditions and terms outlined in the application process and guidelines of the Program. I give my consent to the applicant to move forward with improvements on the property as outlined in the Project Description section of this application.</p> <p>SIGNATURE _____ DATE _____</p>

FOR STAFF USE ONLY

- Is the property fully exempt from Marion County property taxes? Yes No
- Are property taxes paid and up to date? Yes No
- Is the property currently in condemnation or receivership? Yes No
- Is there an active City code enforcement case on the property? Yes No
- Is the building listed on the National Register of Historic Places? Yes No N/A
- Is this the first application submitted for the Fiscal Year? Yes No
- Is the property within the CRA subarea boundary? (Downtown) Yes No
- Was the proof of ownership verified? Yes No
- Is the applicant applying for the first time? Yes No
- Is the property zoned correctly? Yes No
- Does the business have an active business license? Yes No N/A
- Is the business/property owner registered in the State of Florida? Yes No N/A

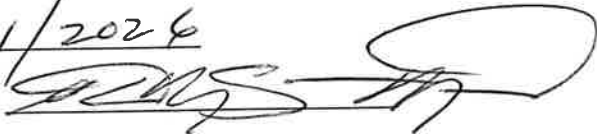
Date Received: 3/31/2024
Signature (Staff Member): 

Community Redevelopment Agency (CRA) Grant Application for The Forge

Project Site Address: 343 NE 1st Ave. Ocala, FL, 34470

Parcel ID: 28234-010-00

Current and Proposed Use of The Property: Restaurant/Retail/Entertainment for Midtown Ocala

Proposed Scope of Work and Need for Grant Assistance:

At The Forge we have plans to create additional restaurants through offering three 40 foot long shipping containers (Conex's) to create up to five separate, permanently fixed locations for food offerings (four 20'X8' units and one unit that is 40'X8'). By doing this, we hope to enhance the overall appeal of the facility and the midtown area, provide additional venues, and create opportunities for small businesses and start-ups to open in a cost-effective manner, thereby providing a stronger pathway to their success. This application is for three units that are currently leased and build out permits are being applied for. These units will be called 1) Slider Shack, 2) Ramen Noodles, and 3) Pastry Planet. These units are each 20'x8' and have specific buildout parameters as you will see when you review their plans.

The Conex units were engineered to be a permanent part of the site as they have been welded to footer plates embedded in large concrete footings. The design by Miles Christian Anderson is attached for you to review. Of course, one of the main goals of this project has been to bring the buildings into compliance with current building and fire codes.

Currently, the Conex's are in their permanent locations and the exterior has been painted. No further work has been done up to this point. We are in the process of submitting the drawings for the build out permits to the City and hope to begin creating the "cargo cuisine" area beginning in May 2026.

We are seeking this grant to help offset the costs of construction of this phase of our project. We are submitting for the buildout of two of the three containers, as we currently have these leased and drawings mostly completed. The third container will be built out after the drawings are completed later this summer. The entirety of The Forge project has almost tripled from the original cost estimates. To help bring this project to completion, we are seeking financial assistance through the CRA grant.

When completed, The Forge will be a multi-venue food and entertainment complex that will provide economic stimulation, community congregation, and a linkage between downtown Ocala and Tusawilla Park. We already have many start up, locally owned businesses leasing space from The Forge. We expect the facility will be a major asset for the City of Ocala, the community, and our business partners. Your consideration of our project as a candidate for this Grant is greatly appreciated.

ROMEN NODDLE & ETHAN SLIDER SHACK

FORGE - 40' CONTAINER - UNITS 304 & 305

BUILDING CODES CRITERIA

BUILDING CODE: 2003 FLORIDA BUILDING CODE, ALL EDITIONS
 ELECTRICAL CODE: 2003 FLORIDA BUILDING CODE, ALL EDITIONS
 PLUMBING CODE: 2003 FLORIDA BUILDING CODE-PLUMBING, ALL EDITIONS
 MECHANICAL CODE: 2003 FLORIDA BUILDING CODE-MECHANICAL, ALL EDITIONS
 GAS CODE: 2003 FLORIDA BUILDING CODE-GAS, ALL EDITIONS

NFPA 99-11 INSTALLATION OF STEELER REVIEW, LATEST EDITION OR ALL LOCAL ENVIRONMENTAL REGULATIONS AND 919-10 BUILDING REQUIREMENTS FOR HAZARDOUS CHEMICAL STORAGE
 STANDARDS LISTED AS CODES RESPECTIVE SECTION OF SPECIFICATIONS
 AISC CODE OF STANDARD PRACTICE, MANUAL OF STEEL CONSTRUCTION PART 10-14
 SPECIFICATIONS FOR THE DESIGN FABRICATION AND ERECTION OF STEEL FOR BUILDINGS INCLUSIVE
 ENVIRONMENT
 SPECIFICATIONS FOR THE STRUCTURAL DESIGN UNDER AREA A-200 BOLTS STRUCTURAL WELDED CONNECTIONS
 AND D-1.1
 AISC SPECIFICATIONS FOR THE DESIGN OF LIGHT GAUGE COLD FORMED STEEL STRUCTURAL MEMBERS
 AND D-1.1

GENERAL CONSTRUCTION NOTES

NO-1 THE GENERAL CONTRACTOR SHALL VERIFY ALL DIMENSIONS PRIOR TO PURCHASE OR START OF CONSTRUCTION.
 NO-2 THE GENERAL CONTRACTOR SHALL PROVIDE ALL MEASURES NECESSARY TO PROTECT THE STRUCTURE FROM DAMAGE, AND OTHER TRADES DURING CONSTRUCTION BY MEANS OF BRACING AND PROTECT THE WIRE AND BE RESPONSIBLE FOR ALL CONNECTIONS.
 NO-3 THE GENERAL CONTRACTOR SHALL ENSURE ARCHITECTURAL, MECHANICAL, AND ELECTRICAL WORKERS FOR THE DESIGN, APPROVE AND SIGNATURE ON ANY OTHER ITEMS WHICH AFFECT THE STRUCTURAL DRAWING.

STRUCTURAL STEEL

NO-4 STEEL PIPE SHALL CONFORM TO THE AISC SPECIFICATIONS FOR THE DESIGN, FABRICATION, AND
 CONNECTION OF STRUCTURAL STEEL FOR BUILDING LATEST EDITION.
 NO-5 STRUCTURAL STEEL SHALL CONFORM TO AISC-360 FLORIDA BUILDING CODE, ALL EDITIONS EXCEPT OTHERWISE NOTED.

TYPICAL DEMISING WALL

SCALE: N.T.S.

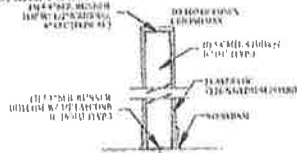

CONTRACTOR MAY USE 2X4 FRAMING IN PLACE OF LIGHTWEIGHT STEEL MATERIAL (SHOWN AT 10\"/>

SOUTH ELEVATION
SCALE: 1/4\"/>

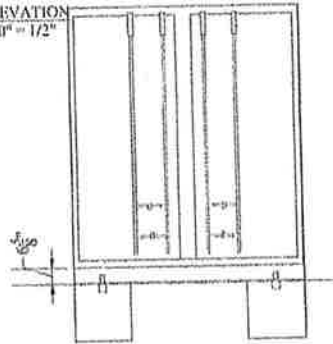

NORTH ELEVATION
SCALE: 1/4\"/>

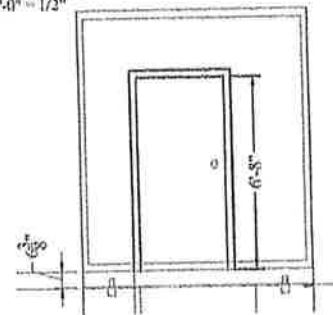

FRONT ELEVATION
SCALE: 1/4\"/>

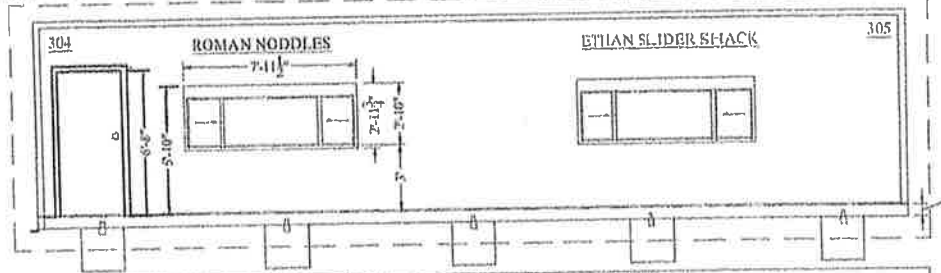

ITEM NO.	QTY	EQUIPMENT/LOAD/TYPE	MANUFACTURER	MODEL NUMBER	AMPS	V	PH	ELECTRICAL		REMARKS
								TRADE	CONCAT	
E-1	1	POWER CHUTE	BY OWNER	BY OWNER	8.4	120V	1	100'	1/2"	NEW EQUIPMENT
E-2	1	STRENGTHY FLEXER	BY OWNER	BY OWNER	6.8	120V	1	100'	1/2"	NEW EQUIPMENT
E-3	1	FRESH AIR FAN	BY OWNER	BY OWNER	1.0	120V	1	100'	1/2"	NEW EQUIPMENT
E-4	1	FLAT TOP FAN	BY OWNER	BY OWNER	1.0	120V	1	100'	1/2"	NEW EQUIPMENT
E-5	1	HAND THERMOS	BY OWNER	BY OWNER	1.0	120V	1	100'	1/2"	NEW EQUIPMENT
E-6	1	PREP SLIDER W/ SH	VEVOR	VEVOR	8.4	120V	1	100'	1/2"	NEW EQUIPMENT
E-7	2	FRY COOKER W/ TABLE	VEVOR	VEVOR	8.4	120V	1	100'	1/2"	NEW EQUIPMENT
E-8	1	TABLE & COOLER	VEVOR	VEVOR	1.0	120V	1	100'	1/2"	NEW EQUIPMENT
E-9	2	ICE MACHINE	VEVOR/COMMERCIAL	VEVOR	2.0	120V	1	100'	1/2"	NEW EQUIPMENT
E-10	1	CASE LIGHTING	VEVOR	VEVOR	0.5	120V	1	100'	1/2"	NEW EQUIPMENT
E-11	1	VENDOR	BY OWNER	BY OWNER	0	120V	1	100'	1/2"	NEW EQUIPMENT

WINDOW & DOOR FRAMING DETAIL
SCALE: 1/4\"/>

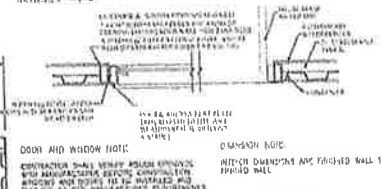

LIFE SAFETY PLAN DISTANCES
TABLE 1
TABLE 2

ITEM	DISTANCE
LS-1	20'
LS-2	20'

ENGINEER'S NOTES

1. ALL WORK SHALL BE IN ACCORDANCE WITH THE LATEST EDITIONS OF THE FLORIDA BUILDING CODE, ALL EDITIONS EXCEPT OTHERWISE NOTED.
 2. THE CONTRACTOR SHALL VERIFY ALL DIMENSIONS PRIOR TO PURCHASE OR START OF CONSTRUCTION.
 3. THE CONTRACTOR SHALL BE RESPONSIBLE FOR OBTAINING ALL NECESSARY PERMITS FROM THE LOCAL JURISDICTION.
 4. THE CONTRACTOR SHALL BE RESPONSIBLE FOR PROTECTING ALL EXISTING UTILITIES AND STRUCTURES.
 5. THE CONTRACTOR SHALL BE RESPONSIBLE FOR THE PROTECTION OF ALL ADJACENT PROPERTIES.
 6. THE CONTRACTOR SHALL BE RESPONSIBLE FOR THE PROTECTION OF ALL ADJACENT UTILITIES.
 7. THE CONTRACTOR SHALL BE RESPONSIBLE FOR THE PROTECTION OF ALL ADJACENT STRUCTURES.
 8. THE CONTRACTOR SHALL BE RESPONSIBLE FOR THE PROTECTION OF ALL ADJACENT UTILITIES.
 9. THE CONTRACTOR SHALL BE RESPONSIBLE FOR THE PROTECTION OF ALL ADJACENT STRUCTURES.
 10. THE CONTRACTOR SHALL BE RESPONSIBLE FOR THE PROTECTION OF ALL ADJACENT UTILITIES.

FBC CHAPTER 15

SECTION	REVISION	DATE
15.01	1	03/19/2026

Miles C Anderson
 Digitally signed by Miles C Anderson
 Date: 2026.03.19 11:04:27 -0400'

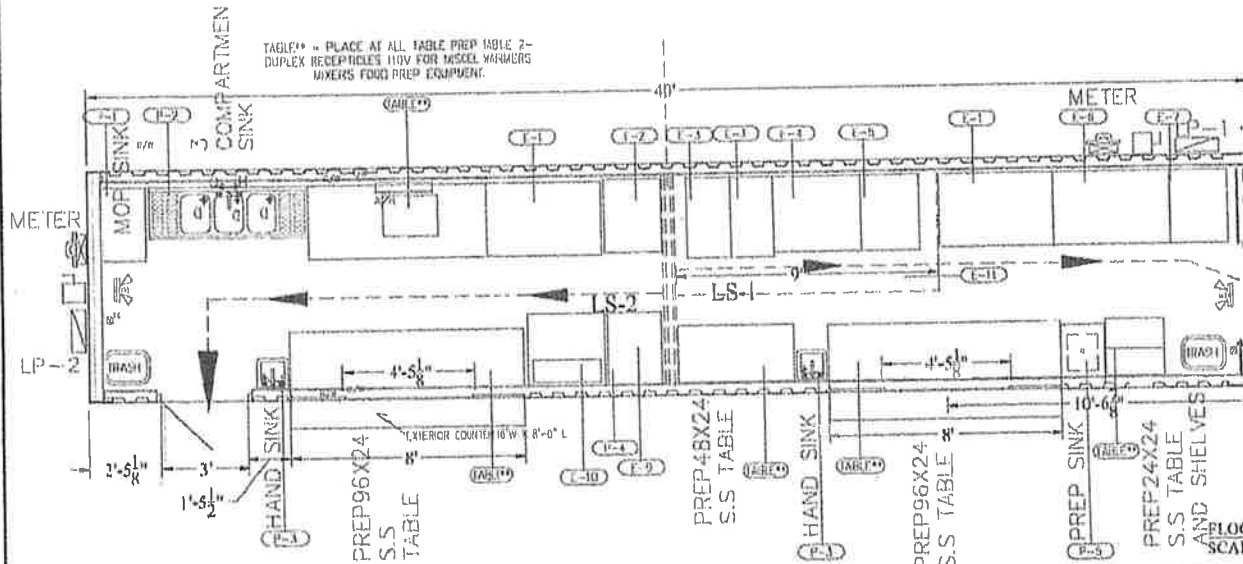

SECTION SCALE: 1/4\"/>

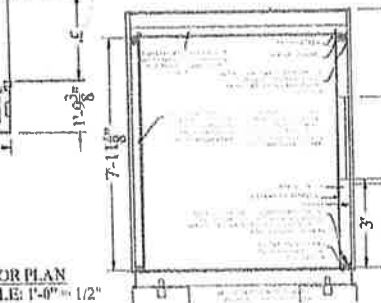

FLOOR PLAN SCALE: 1/4\"/>

MILES CHRISTIAN ANDERSON CONSULTING ENGINEERS, INC.
 1515 E. PALM BLVD., SUITE 100
 GAITHERSBURG, MD 20878
 TEL: (301) 251-1000
 FAX: (301) 251-1002



DATE: 3-19-25
 DRAWN BY: MCA
 CHECKED BY: MCA
 JOB NO.: 24-024(20) FILE: R-101

FORGE CONTAINER BUILD OUT COVER

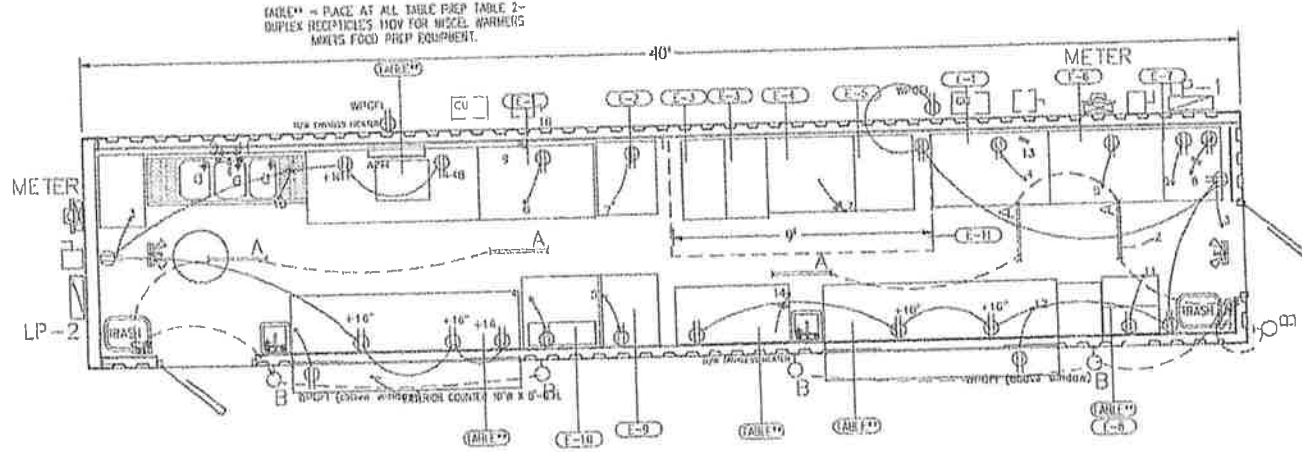

(TABLE** = PLACE AT ALL TABLE PREP TABLE 2-DUPLEX RECEPTICLES 110V FOR WIGGLER WARMERS MIXERS FOOD PREP EQUIPMENT.

POWER AND LIGHTING PLAN
SCALE: 1/4" = 1/2"

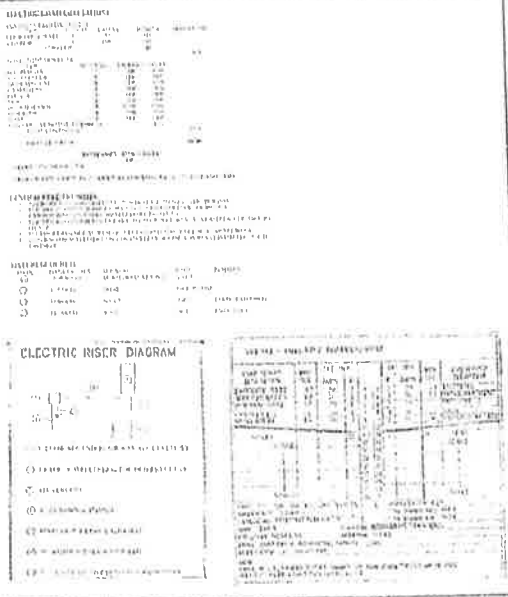

ROMEN NODDLES - ELECTRIC

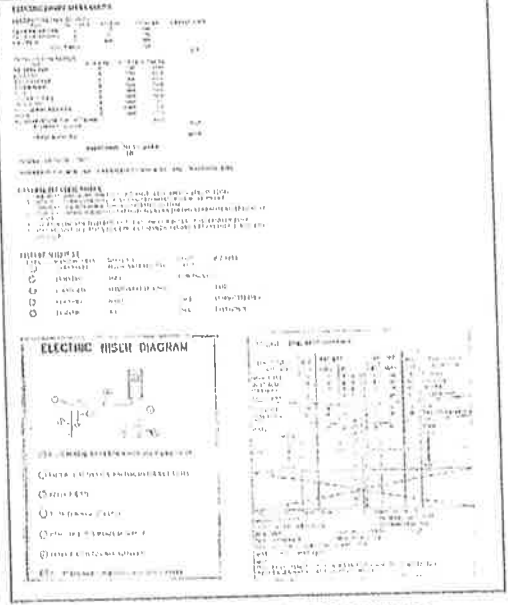

ETHAN'S SLIDER SHACK - ELECTRIC

Robert J Brady
 Robert J Brady
 10/21/2020 10:19

Robert J Brady
 10/21/2020 10:19
 10/21/2020 10:19

MOLES CHRISTY ANDERSON CONSULTING ENGINEERS, INC.
 STRUCTURAL AND PLUMBING
 1015 E. THIRD STREET, SUITE 102
 DENVER, COLORADO 80202
 TEL: (303) 533-4100
 FAX: (303) 533-4105



DATE: 5-12-26
 DRAWING NO: 24-024(00) FILE: RAO.0
 CHECKED: MCA
 REVISION:

FORGE CONTAINER BUILD OUT
 ELECTRIC

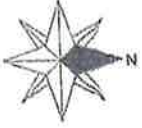

Level 1

Condensing Unit



Cassette 1

Cassette 2

Room 1

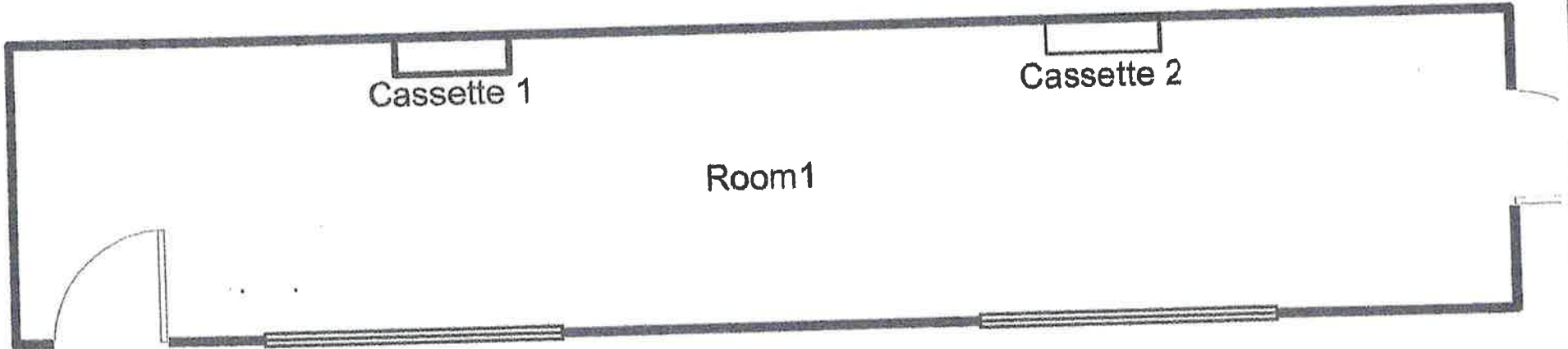

Job #:
Performed by Air Design for:
Roman Noddle & Elhan Slider Shack
Ocala, FL

Air Design Heating & A/C Inc.
PO Box 729
Ocala, FL 34478
Phone: 352-629-2626 Fax: 352-368-6788 license: ...
www.AirDesignAC.com sales@airdesignac.com

Scale: 1 : 50
Page 1
Right-Suite@ Universal 2025
25.0.03 RSU59051
2025-Mar-24 15:05:26
Project2.rup

PASTRY PLANET

FORGE - 40' CONTAINER - UNIT 300

BUILDING CODES CRITERIA
 BUILDING CODE: 2018 FLORIDA BUILDING CODE, WITH ADDITION
 ELECTRICAL CODE: 2017 FLORIDA ELECTRICAL CODE, WITH ADDITION
 MECHANICAL CODE: 2017 FLORIDA MECHANICAL CODE, WITH ADDITION
 MECHANICAL CODE: 2017 FLORIDA MECHANICAL CODE, WITH ADDITION
 MECHANICAL CODE: 2017 FLORIDA MECHANICAL CODE, WITH ADDITION

NOTE: IN THE INSTALLATION OF MECHANICAL SYSTEMS, LATEST EDITION LOCAL ENVIRONMENTAL
 REQUIREMENTS AND 2018 FLORIDA MECHANICAL CODE, WITH ADDITION
 MECHANICAL CODE: 2017 FLORIDA MECHANICAL CODE, WITH ADDITION
 MECHANICAL CODE: 2017 FLORIDA MECHANICAL CODE, WITH ADDITION
 MECHANICAL CODE: 2017 FLORIDA MECHANICAL CODE, WITH ADDITION

GENERAL CONSTRUCTION NOTES
GENERAL

1. THE GENERAL CONTRACTOR SHALL VERIFY ALL DIMENSIONS PRIOR TO FABRICATION OR START
 OF CONSTRUCTION.
 2. THE GENERAL CONTRACTOR SHALL PROVIDE ALL MEASUREMENTS NECESSARY TO PROTECT THE
 STRUCTURE, THE WORK PERSONS, AND OTHER PEOPLE DURING CONSTRUCTION. HE SHALL INSURE AND
 INDENTIFY THE WORK AND BE RESPONSIBLE FOR ALL CONSTRUCTION.
 3. THE GENERAL CONTRACTOR SHALL COORDINATE ARCHITECTURAL, MECHANICAL, AND ELECTRICAL
 WORKING FOR ALL ITEMS, WORKS AND SUPPORTS ON ANY OTHER TRADE WHICH EFFECT THE STRUCTURAL
 WORKING.

STRUCTURAL STEEL

1. ALL STEEL WORK SHALL CONFORM TO THE AISC SPECIFICATIONS FOR THE DESIGN,
 FABRICATION, AND
 ERECTION OF STRUCTURAL STEEL FOR BUILDING LATEST EDITION.
 2. ALL STRUCTURAL STEEL SHALL CONFORM TO ASTM-A36 FLORIDA BUILDING CODE, WITH
 ADDITION UNLESS OTHERWISE NOTED.

TYPICAL DEMISING FIRE RATED

WALL
 SCALE: N.T.S.

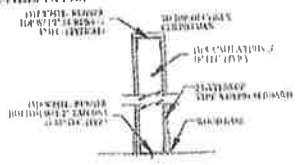

CONSTRUCTION MAY USE FRAMING IN PLACE OF
 (SHEATHING STEEL MATERIAL) (SHEATHING AT 16" O.C.)
 DOUBLE TOP PLATE, SILE PLATE AND ANCHORS TO SLAB
 WITH 3" TAPCON AT 16" O.C.

SOUTH ELEVATION
 SCALE: 1/4" = 1/2"

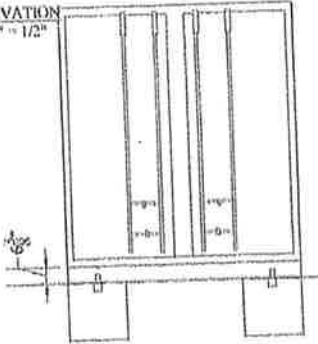

SECTION
 SCALE: 1/4" = 1/2"

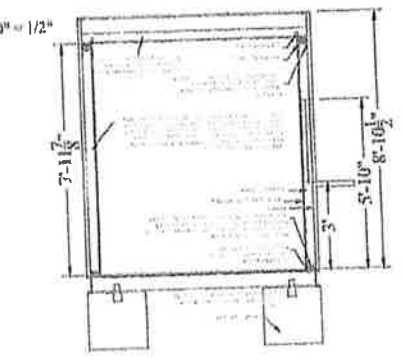

FRONT ELEVATION
 SCALE: 1/4" = 3/8"

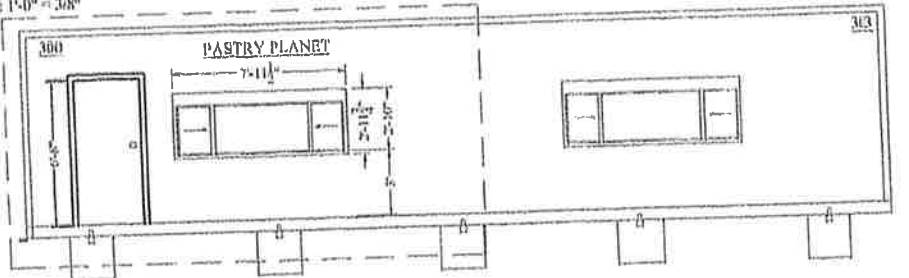

"PASTRY PLANET" ELECTRICAL SCHEDULE

ITEM NO.	QTY	DESCRIPTION CATEGORY	MANUFACTURER	MODEL NUMBER	AMP	VOLTS	PHASE	WIRE SIZE	TERMINAL	CONDUIT	WIRE MGT	BOX	REMARKS
1	1	THREE COMPARTMENT BOX	BY OWNER	BY OWNER									NEW/REPLACE
2	1	DISCHARGE LIGHTING FIXTURE	XXXXXX	XXXXXX	115	0.8	1	200V	1-PH				NEW/REPLACE
3	2	RECESSED FLEXIBLE PENDANT	XXXXXX	XXXXXX	0.7	110	1-PH	140V	1-PH				NEW/REPLACE
4	1	RECESSED PENDANT	XXXXXX	XXXXXX	0.8	110V	1-PH	140V	1-PH				NEW/REPLACE
5	1	RECESSED PENDANT	XXXXXX	XXXXXX	0.8	110V	1-PH	140V	1-PH				NEW/REPLACE
6	1	RECESSED PENDANT	XXXXXX	XXXXXX	0.8	110V	1-PH	140V	1-PH				NEW/REPLACE
7	1	RECESSED PENDANT	XXXXXX	XXXXXX	0.8	110V	1-PH	140V	1-PH				NEW/REPLACE
8	1	RECESSED PENDANT	XXXXXX	XXXXXX	0.8	110V	1-PH	140V	1-PH				NEW/REPLACE
9	1	RECESSED PENDANT	XXXXXX	XXXXXX	0.8	110V	1-PH	140V	1-PH				NEW/REPLACE
10	1	RECESSED PENDANT	XXXXXX	XXXXXX	0.8	110V	1-PH	140V	1-PH				NEW/REPLACE
11	1	RECESSED PENDANT	XXXXXX	XXXXXX	0.8	110V	1-PH	140V	1-PH				NEW/REPLACE
12	1	RECESSED PENDANT	XXXXXX	XXXXXX	0.8	110V	1-PH	140V	1-PH				NEW/REPLACE

THE STANDARD SHALL HAVE THESE NOTES FOR THE UNIT AREA AND THE UNIT
 AREA FOR NOTES AND NOTES.
 ** STANDARD BUILDING IS 12" x 12" HOLE FOR WIRE.
 *** Unit only with for a 1-hour Fire-Rated Wall (MINIMUM 1/2" O.C. 16" TAPCON) (MINIMUM
 wall is 1/2" thick with 1/2" deep, 1/2" hole 16" O.C.)

NOTE:

1. THE GENERAL CONTRACTOR SHALL VERIFY ALL DIMENSIONS PRIOR TO FABRICATION OR START
 OF CONSTRUCTION.
 2. THE GENERAL CONTRACTOR SHALL PROVIDE ALL MEASUREMENTS NECESSARY TO PROTECT THE
 STRUCTURE, THE WORK PERSONS, AND OTHER PEOPLE DURING CONSTRUCTION. HE SHALL INSURE AND
 INDENTIFY THE WORK AND BE RESPONSIBLE FOR ALL CONSTRUCTION.
 3. THE GENERAL CONTRACTOR SHALL COORDINATE ARCHITECTURAL, MECHANICAL, AND ELECTRICAL
 WORKING FOR ALL ITEMS, WORKS AND SUPPORTS ON ANY OTHER TRADE WHICH EFFECT THE STRUCTURAL
 WORKING.

WINDOW & DOOR FRAMING DETAIL
 SCALE: 1" = 1'-0"



CONSTRUCTION SHALL VERIFY WORKS IDENTIFIED
 WITH MECHANICAL WORKS. CONSTRUCTION
 SHALL VERIFY WORKS IDENTIFIED WITH MECHANICAL
 WORKS. CONSTRUCTION SHALL VERIFY WORKS
 IDENTIFIED WITH MECHANICAL WORKS.

FLOOR PLAN
 SCALE: 1/4" = 3/4"

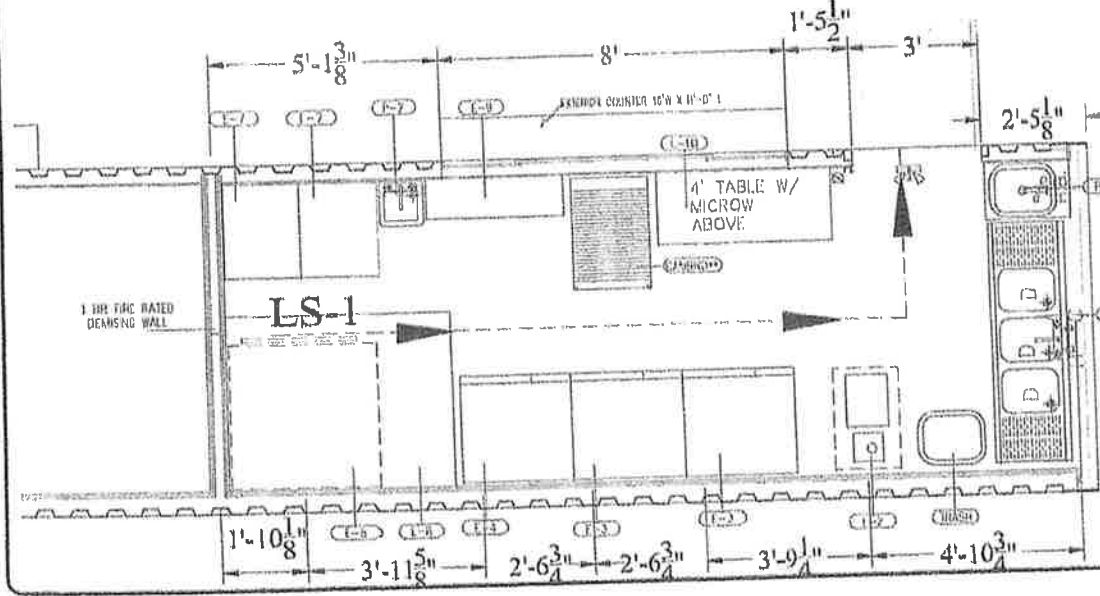

LIFE SAFETY PLAN DISTANCES

TYPE	MINIMUM DISTANCE
EXIT	20'

ENGINEER'S NOTES

1. THE GENERAL CONTRACTOR SHALL VERIFY ALL DIMENSIONS PRIOR TO FABRICATION OR START OF CONSTRUCTION.
2. THE GENERAL CONTRACTOR SHALL PROVIDE ALL MEASUREMENTS NECESSARY TO PROTECT THE STRUCTURE, THE WORK PERSONS, AND OTHER PEOPLE DURING CONSTRUCTION.
3. THE GENERAL CONTRACTOR SHALL COORDINATE ARCHITECTURAL, MECHANICAL, AND ELECTRICAL WORKING FOR ALL ITEMS, WORKS AND SUPPORTS ON ANY OTHER TRADE WHICH EFFECT THE STRUCTURAL WORKING.

FIG. CHAPTER 14

NO.	DESCRIPTION	DATE
1	REVISION	

Digitally signed by
Miles C Anderson
 Date: 2024.03.28 12:48:01 -0400

DATE: 3-15-24
 DRAWN: MS
 CHECKED: MCA
 SCALE: 1/4" = 3/4" (1" = 3'-0")
 SHEET: 1 of 1

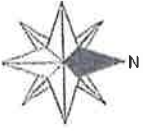

Level 1

Condensing Unit



Cassette

Room 1

N/A

Job #:
Performed by Air Design for:
Pastry Planet
Ocala, FL

Air Design Heating & A/C Inc.
PO Box 729
Ocala, FL 34478
Phone: 352-629-2626 Fax: 352-368-6788 License: ...
www.AirDesignAC.com sales@airdesignac.com

Scale: 1 : 50
Page 1
Right-Suite® Universal 2025
25.0.03 RSU59051
2025-Mar-24 15:38:20
...y - Food Truck\Pastry Planet.rup















Right-Suite® Universal 2025 Short Form

Mini Split

Air Design Heating & A/C Inc.

Job:
Date: Mar 24, 2026
By: Air Design

PO Box 729, Ocala, FL 34478 Phone: 352-629-2626 Fax: 352-368-6788 Email: sales@airdesignac.com Web: www.AirDesignAC.com License: CAC1814997

Project Information

For: Romen Noddle & Ethan Slider Shack
Ocala, FL

		Htg	Clg		Htg	Clg	
Outside db	(°F)	34	93	Inside db	(°F)	70	75
Outside RH	(%)	-	49	Inside RH	(%)	-	50
Outside wb	(°F)	-	77	Inside wb	(°F)	-	63
Daily range	(°F)	-	18	Design TD	(°F)	36	18
Moisture diff.	(gr/lb)	-	50				

Heating Equipment

Make Samsung Electronics Co., LTD.
Model AJ048BXJ5CH

AHRI ref. 207698738
Type Split ASHP
Efficiency 8.65 HSPF2

Heating Input
Heating Output 47.5 MBtuh @47°F
Humidifier 4.1 gpd
Leaving Air Temp 97.9 °F
Actual Heating Fan 1550 cfm

Backup:
Input = 13 kW, Output = 44491 Btuh, 100 AFUE

Cooling Equipment

Make Samsung Electronics Co., LTD.
Cond AJ048BXJ5CH
Coil 2 - AR24DXFAMWKNVCV
AHRI ref. 207698738
Type Split ASHP
Efficiency 9.6 EER2, 18.75 SEER2

Sensible Cooling 32.5 MBtuh
Latent Cooling 13.9 MBtuh
Total Cooling 46.5 MBtuh
Leaving Air Temp 55.0 °F
Actual Cooling Fan 1550 cfm

System Type
Fan Motor Heat Type
Fan & Motor Combined Efficiency
Static Pressure Across Fan

PEAKCV
PACKAGE
0 %
0 in H2O

NAME	Area ft²	Heat Loss	Sensible Gain	Latent Gain	Htg cfm	Clg cfm	Time
Room1	320	13481	33827	3494	1550	1550	Jul 1700 LDT
Mini Split	320	13481	33827	3494	1550	1550	Jul 1700 LDT



Project Information

For: Romen Noddle & Ethan Slider Shack
Ocala, FL

Zone: Mini Split

COOLING LOAD

1. DESIGN CONDITIONS		at Jul 1700 LDT		Peak load at Jul 1700 LDT		
Inside:	75 °F	Outside:	93 °F	TD:	18 °F	
OutRH:	49 %	MoistDiff:	50.1 gr/lb	Mult:	1.0	Ins.wb 63 °F
					Sensible	Latent
2. SOLAR RADIATION THROUGH GLASS					2440	-
3. TRANSMISSION GAINS		Sensible			3741	-
Walls:			1913		-	-
Glass:			530		-	-
Doors:			59		-	-
Partitions:			0		-	-
Floors:			0		-	-
Ceilings:			1239		-	-
4. INTERNAL HEAT GAIN		Sensible		Latent	26035	720
Occupants:			816	720	-	-
Lights:			1719	-	-	-
Motors:			0	-	-	-
Appliances:			23500	0	-	-
5. INFILTRATION:		Outside air cfm:		0	0	0
6. SUBTOTAL:		Space load		Latent	32216	720
Envelope			32216	720	-	-
Less external			0	-	-	-
Redistribution			0	0	-	-
7. SUPPLY DUCT					32216	-
8. SUBTOTAL:		Space load + supply duct			-	-
Actual cfm:			1550 at supply TD:	20	-	-
9. VENTILATION:		Make-up air cfm:		82	1611	2774
10. RETURN AIR LOAD:		Lighting + plenum (net)			0	-
11. RETURN DUCT					0	-
12. TOTAL LOADS ON EQUIPMENT					33827	3494

HEATING LOAD

13. DESIGN CONDITIONS		Outside:		Mult:		
Inside:	70 °F	34 °F		1.0		
				TD:	36 °F	
14. TRANSMISSION LOSSES					8208	
Walls:			2907		-	-
Glass:			1192		-	-
Doors:			133		-	-
Partitions:			0		-	-
Floors:			3418		-	-
Ceilings:			558		-	-
15. INFILTRATION:		Outside air cfm:		13	506	
16. SUBTOTAL:		Space load			8713	
Envelope			8713		-	-
Less external			0		-	-
Less transfer			0		-	-
Redistribution			0		-	-
17. SUPPLY DUCT:					0	
18. VENTILATION:		Make-up air cfm:		82	3223	
19. HUMIDIFICATION					1545	
Piping					0	
20. RETURN DUCT					0	
21. TOTAL HEATING LOAD ON EQUIPMENT					13481	



Right-Suite® Universal 2025 Short Form

Mini Split

Air Design Heating & A/C Inc.

Job:
Date: Mar 24, 2026
By: Air Design

PO Box 729, Ocala, FL 34478 Phone: 352-620-2926 Fax: 352-388-6788 Email: sales@airdesignac.com Web: www.AirDesignAC.com License: CAC1814987

Project Information

For: Pastry Planet
Ocala, FL

	Htg	Clg		Htg	Clg
Outside db (°F)	34	93	Inside db (°F)	70	75
Outside RH (%)	-	49	Inside RH (%)	-	50
Outside wb (°F)	-	77	Inside wb (°F)	-	63
Daily range (°F)	-	18	Design TD (°F)	36	18
Moisture diff. (gr/lb)	-	50			

Heating Equipment

Make Samsung Electronics Co., LTD.
Model AR18CSFCMWKX
AHRI ref. 210445765
Type Split ASHP
Efficiency 8 HSPF2
Heating Input 21.0 MBtuh @47°F
Heating Output 2.1 gpd
Humidifier 101.9 °F
Leaving Air Temp 600 cfm
Actual Heating Fan
Backup:
Input = 13 kW, Output = 44491 Btuh, 100 AFUE

System Type
Fan Motor Heat Type
Fan & Motor Combined Efficiency
Static Pressure Across Fan

Cooling Equipment

Make Samsung Electronics Co., LTD.
Cond AR18CSFCMWKX
Coil AR18CSFCMWKN
AHRI ref. 210445765
Type Split ASHP
Efficiency 11.0 EER2, 18.7 SEER2
Sensible Cooling 12.6 MBtuh
Latent Cooling 5.4 MBtuh
Total Cooling 18.0 MBtuh
Leaving Air Temp 55.0 °F
Actual Cooling Fan 600 cfm

PEAKCV
PACKAGE
0 %
0 in H2O

NAME	Area ft²	Heat Loss	Sensible Gain	Latent Gain	Htg cfm	Clg cfm	Time
Room1	160	7261	12889	1747	600	600	Jul 1700 LDT
Mini Split	160	7261	12889	1747	600	600	Jul 1700 LDT



Right-Suite® Universal 2025 Load Summary
Mini Split
Air Design Heating & A/C Inc.

Job:
 Date: Mar 24, 2026
 By: Air Design

PO Box 729, Ocala, FL 34478 Phone: 352-629-2626 Fax: 352-368-6788 Email: sales@airdesignac.com Web: www.AirDesignAC.com License: CAC1814997

Project Information

For: Pastry Planet
 Ocala, FL

Zone: Mini Split

COOLING LOAD

1. DESIGN CONDITIONS		at Jul 1700 LDT		Peak load at Jul 1700 LDT			
Inside:	75 °F	Outside:	93 °F	TD:	18 °F		
OutRH:	49 %	MoistDiff:	50.1 gr/lb	Mult:	1.0	Ins.wb	63 °F
						Sensible	Latent
2. SOLAR RADIATION THROUGH GLASS		Sensible				1220	-
3. TRANSMISSION GAINS		Sensible				1996	-
Walls:	1082					-	-
Glass:	265					-	-
Doors:	30					-	-
Partitions:	0					-	-
Floors:	0					-	-
Ceilings:	620					-	-
4. INTERNAL HEAT GAIN		Sensible		Latent		8867	360
Occupants:	408			360		-	-
Lights:	859			-		-	-
Motors:	0			-		-	-
Appliances:	7600			0		-	-
5. INFILTRATION:		Outside air cfm:		0		0	0
6. SUBTOTAL:		Space load		Latent		12083	360
Envelope	12083			360		-	-
Less external	0			-		-	-
Redistribution	0			0		-	-
7. SUPPLY DUCT						0	-
8. SUBTOTAL:		Space load + supply duct				12083	-
Actual cfm:	600	at supply TD:		20		-	-
9. VENTILATION:		Make-up air cfm:		41		806	1387
10. RETURN AIR LOAD:		Lighting + plenum (net)				0	-
11. RETURN DUCT						0	-
12. TOTAL LOADS ON EQUIPMENT						12889	1747

HEATING LOAD

13. DESIGN CONDITIONS		Outside:		Mult:		1.0	
Inside:	70 °F	34 °F		TD:	36 °F		
14. TRANSMISSION LOSSES						4624	
Walls:	1689					-	-
Glass:	596					-	-
Doors:	67					-	-
Partitions:	0					-	-
Floors:	1994					-	-
Ceilings:	279					-	-
15. INFILTRATION:		Outside air cfm:		6		253	
16. SUBTOTAL:		Space load				4877	
Envelope	4877					-	-
Less external	0					-	-
Less transfer	0					-	-
Redistribution	0					-	-
17. SUPPLY DUCT:						0	
18. VENTILATION:		Make-up air cfm:		41		1611	
19. HUMIDIFICATION						773	
Piping						0	
20. RETURN DUCT						0	
21. TOTAL HEATING LOAD ON EQUIPMENT						7261	

George Albright
REAL ESTATE

Marion County

Ad Valorem Taxes

ACCOUNT NUMBER: R28234-010-00 2025
 ASSESSED VALUE: 810,781
 TAXING AUTHORITY
 COUNTY GENERAL COUNTY
 FINE & FORFEITURE
 COUNTY HEALTH
 SCHOOL SCHOOL R.I.E.
 SCHOOL VOTE
 SCHOOL DISCRETIONARY
 SCHOOL CAPITAL IMPR
 WATER ST JOHNS MANAGEMENT DIST
 MUNIC Ocala BASIC
 EXEMPTION:NONE

EXEMPTIONS: *	NONE	*	EXEMPTIONS	TAXABLE VALUE:	TAXES
MILLAGE		ASSESSED		810,781	810,781
3.0900		810,781	0	810,781	2,505.31
.8300		810,781	0	810,781	672.95
.1000		810,781	0	810,781	81.08
3.0720		810,781	0	810,781	2,490.72
1.0000		810,781	0	810,781	810.78
.7480		810,781	0	810,781	606.46
1.5000		810,781	0	810,781	1,216.17
.1793		810,781	0	810,781	145.37
6.6177		810,781	0	810,781	5,365.51
					13,894.35

Non-Ad Valorem Assessments

LEVYING AUTHORITY
X902 Ocala FIRE

PURPOSE	RATES/BASIS	AMOUNT
COMMERCIAL FIRE	PER ASMT UNIT	7,150.00
NON AD VALOREM ASSESSMENTS:		7,150.00
COMBINED TAXES & ASSESSMENTS TOTAL:		21,044.35

R28234-010-00 2025
 FORGE AT MADISON COMMONS LLC
 101 E SILVER SPRINGS BLVD STE #301
 Ocala FL 34470

*** PAID *** PAID *** PAID ***
 03/15/26 PERIOD 05

MAR 31 2026	APR 30 2026	MAY 31 2026	CERTIFIED	FUNDS	PAST DUE ON
21,044.35	21,675.68	21,681.58	AFTER	APRIL 30 2026	APR 1 2026
Marion County					

George Albright
REAL ESTATE

MAR 31 2026	APR 30 2026	MAY 31 2026	CERTIFIED	FUNDS	PAST DUE ON
21,044.35	21,675.68	21,681.58	AFTER	APRIL 30 2026	APR 1 2026
REMIT PAYMENT IN U.S. FUNDS TO:					

EX-TYPE	ESCROW	MILLAGE	TAXES LEVIED
		1001	
VALUES AND EXEMPTIONS	TAXES		13,894.35
ASSESSMENT	810,781	SP. ASMT	7,150.00
TAXABLE	810,781		

George Albright
503 SE 25TH AVENUE
Ocala Fl 34471

17 15 22

SEC 17 TWP 15 RGE 22 PLAT BOOK A
 PAGE 114 WESTON CENTRAL CITY
 LOTS 10 THRU 19 & UNNUMBERED LOT
 LYING E OF & ADJ TO LOT 10 ALL
 OF THE ABOVE ALSO BEING DESC AS
 SEE TAX ROLL FOR MORE LEGAL

R28234-010-00 2025
 FORGE AT MADISON COMMONS LLC
 101 E SILVER SPRINGS BLVD STE #301
 Ocala FL 34470

*** PAID *** PAID *** PAID ***
 03/15/26 PERIOD 05
 995-2025-0051406.0001
 \$21,044.35 CH



**PO Box 1074, Belleview, FL 34420
352-286-0396**

FloridasFinestRestorations@gmail.com

ESTIMATE #1295

***HONORED FOR 60 DAYS
PRICING SUBJECT TO CHANGE
DUE TO INFLATION**

DATE: MARCH 26, 2026

CLIENT:

Romen Noodle & Ethan Slider Shack
The Forge / Joel Gibson
Ocala, FL

DESCRIPTION	Materials	Labor	TOTAL
- Metal Framing			\$5,700
- Welding to include window boxes			\$4,000
- Electrical			\$27,400
- Plumbing			\$11,200
- HVAC			\$4,000
- Drywall			\$3,800
- FRP			\$6,000
SUBTOTAL			
TOTAL			\$62,100

Additional Information/Comments:

Sun Shade	\$6000	<u>Total: 95,357</u>
Kitchen Equip Installed	\$8619	
Ventilation/Exhaust	\$18608	



PO Box 1074, Belleview, FL 34420
352-286-0396

FloridasFinestRestorations@gmail.com

ESTIMATE #1295
*HONORED FOR 60 DAYS
PRICING SUBJECT TO CHANGE
DUE TO INFLATION

DATE: MARCH 26, 2026

CLIENT:

Planet Pastries
The Forge / Joel Gibson
Ocala, FL

DESCRIPTION	Materials	Labor	TOTAL
- Metal Framing			\$4,500
- Welding to include window boxes			\$4,000
- Electrical			\$18,800
- Plumbing			\$5,500
- HVAC			\$4,000
- Drywall			\$2,700
- FRP			\$4,500
SUBTOTAL			
TOTAL			\$44,000

Additional Information/Comments:

Sunshade \$3,000
Kitchen Equipment installed \$2,500
Ventilation Exhaust \$11,948

Total:
61,448

Hutchinson Development, Inc.

6347 S. Magnolia Avenue, Ocala FL 34474

The Forge at Madison Commons at 343 NE 1st Ave. Ocala FL 34470

Construction costs for Conex's (Pastry Planet, Slider Shack and Ramen Noodles)

	Pastry Planet	Slider Shack	Ramen Noodles
Windows	\$5,090	\$5,090	\$5,090
Doors	\$2,037	\$2,037	\$2,037
Plumbing	\$7,000	\$7,100	\$6,100
HVAC	\$4,000	\$4,000	\$4,000
Framing	\$507	\$507	\$507
Insulation	\$1,750	\$1,750	\$1,750
Floors	\$1,700	\$1,700	\$1,700
Walls	\$3,250	\$3,250	\$3,250
Electrical	\$17,500	\$15,000	\$16,000
Ventilation/Exhaust	\$11,948	\$18,608	
Kitchen Equipment Installed	\$2,500	\$8,649	
Sun Shading	\$3,000	\$3,000	\$3,000
Total	\$60,282	\$70,691	\$43,434
Grand Total		\$174,407	

W B H

WILLIAM B. HUTCHINSON
HUTCHINSON DEVELOPMENT
352-266-6843
3-31-26

Shipping & Billing

Review & Payment

Order Confirmation

Review & Payment

Important Information about your Delivery!

Your order will be delivered curbside on a full size 18 wheeler.

[View Details & Options](#)

You are responsible for: Bringing the shipment into your location and noting damaged or missing items on the carrier's delivery receipt

Use Our Live Chat

Mon-Thurs 8AM-8PM EST
Fri 8AM-6PM EST
Sat 9AM-4PM EST



[Chat Now](#)

[Help Center](#) Your Cart ID: Q1Q03Q

Enter payment info to complete your order

[Enter Card](#)

Billing Address

Sheila Gibson
Just Desserts Ice Cream &
1430 sw 43rd pl Ocala
FL
Ocala, FL 34471
United States
1 352 615 6294

Shipping Address

Sheila Gibson
Just Desserts Ice Cream &
343 NE First Ave.,
Ocala FL
Ocala, FL 34470
United States
1 352 615 6294



Earn 3% Back
per \$1 spent at WebstaurantStore!

50% Off a Plus membership

[Learn More](#)

Must apply here for this offer. Offer varies elsewhere.

ITEM

QTY:

QTY

PRICE

Estimated Tax 

\$1,284.35

\$1,284.35

Total (USD)

\$19,038.88

\$19,038.88

Payment

Credit Card

Sheila Gibson 7080

 Default 

Apple Pay



LEAF Financing

Finance your purchase with up to 60 month terms



Pay Over Time

As low as \$1,657.58 per month



Alternate Payment

Pay by check, wire transfer, or ACH



By placing your order, you agree to our [terms of sale](#) and [privacy policy](#)

© 2026 The WEBrestaurant Store, LLC - All Rights Reserved.

Halfax P710440 2' x 40" Type 1
Corrosion Trailer / Food Truck Hood
System with Integrated Fan

#21P710440 - EACH

Qty:

1

\$3,799.00

~~\$4,298.00~~

\$ 4,298.00

plus Discounted Shipping

Usually Ships in 3 - 5 Bus. Days

Ships via Common Carriers

Wall Panels (2) 48" x 84" uninsulated stainless
steel panels

Qty:

\$569.00

Hanging Brackets Loose

Qty:

\$0.00

Light Configuration: Installed

Qty:

\$0.00

Halfax CHD448 Package Type 2
Condensate Hood System - 4' x 48"

#25CHD448 - EACH

Qty:

1

\$2,799.00

~~\$1,088.00~~

\$ 3,088.00

plus Discounted Shipping

Usually Ships in 5 - 7 Bus. Days

Ships via Common Carriers

Exhaust Fan Mounting Curb Type: Roof (Flat)

Qty:

\$0.00

How Many Stories is Your Building? 1 story

Qty:

\$0.00

What is Your Ceiling Height? Less than 10' (Low
Ceiling Hood Needed)

Qty:

\$0.00

Wall Panels (1) 48" x 84" uninsulated stainless
steel panel

Qty:

\$289.00

1&S HG-4B-4BK Safe-T-Link 4B"
Quick Disconnect Gas Appliance
Connector 1" NPT with Installation
Kit

#510H04E4BK - EACH

Qty:

1

\$132.99

~~\$132.99~~

\$ 132.99

plus Free Shipping

Usually Ships in 1 - 2 Bus. Days



Steelton 20" x 16" x 12" 18 Gauge
304 Stainless Steel One
Compartment Floor Mount Sink
Arrives in 2 - 4 business days
#227840 - EACH

Qty: 1

\$278.40

\$278.40

\$278.49

plus Free Shipping



Regency 17" x 15" Wall Mounted
Hand Sink with Gooseneck Faucet
and Wrist Blades
Arrives in 2 - 4 business days
#200117WKR - EACH

Qty: 1

\$169.99

\$169.99

\$169.99

plus Free Shipping



Regency 66" 16-Gauge Stainless
Steel Three Compartment
Commercial Sink with Stainless Steel
Legs, Cross Bracing, and 2
Drainboards - 10" x 14" x 12" Bowls
Arrives in 2 - 4 business days
#200231011R - EACH

Qty: 1

\$579.00

\$579.00

\$579.00

plus Discounted Shipping

Ships via Common Carrier



Garland G60-4G36RR Natural Gas 4
Burner 60" Range with 36" Griddle
and 2 Standard Ovens - 262,000
BTU
Arrives in 2 - 4 business days
#372000430HRN - EACH

Qty: 1

\$8,149.00

\$8,149.00

\$8,149.00

plus Free Shipping

Subtotal

\$16,695.47

\$16,695.47

Shipping & Handling

\$1,059.00: Common Carrier w/ Liftgate

FREE Call Before Delivery

Search The Restaurant Store 🔍

Orlando, FL
 Deliver to 34471

My Cart

	<p>Garland G60-4G36RR Natural Gas 4 Burner 60" Range with 36" Griddle and 2 Standard Ovens - 262,000 BTU #372G60436RRN FREE shipping</p>	<p>\$8,697.49</p>	<p>1</p>	<p>\$8,697.49</p>
<p>① Item ships via Common Carrier</p> <p>5 Year Extended Warranty Powered by Safeware PWI:421140 Change Extended Warranty.</p>				
	<p>Advance Tabco FE-3-1416-12RL Spacesaver Stainless Steel 3 Compartment Commercial Sink with 2 Drainboards - 66" #109FE3141612</p>	<p>\$769.00</p>	<p>1</p>	<p>\$769.00</p>
<p>① Item ships via Common Carrier ① Usually ships in 5-6 business days</p>				
	<p>Regency 17" x 15" Wall Mounted Hand Sink with Gooseneck Faucet and Wrist Blades #600HS17WBK FREE shipping</p>	<p>\$159.99</p>	<p>1</p>	<p>\$159.99</p>
	<p>Steelton PQ828 20" x 16" x 12" 18 Gauge 304 Stainless Steel One Compartment Floor Mop Sink #522MS162012</p>	<p>\$278.99</p>	<p>1</p>	<p>\$278.99</p>
	<p>Halifax FTH1940 9' x 40" Type 1 Concession Trailer / Food Truck Hood System with Integrated Fan #421FTH1940</p>	<p>\$4,108.00</p>	<p>1</p>	<p>\$4,108.00</p>
<p>① Item ships via Common Carrier ① Usually ships in 3-5 business days</p>				
<p>Hanging Brackets: Loose</p>				
<p>Light Configuration: Installed</p>				
<p>Wall Panels: (2) 48" x 84" un-insulated stainless steel panels Remove Accessory.</p>				
	<p>T&S HG-4E-48K Safe-T-Link 48" Quick Disconnect Gas Appliance Connector 1" NPT with Installation Kit #510HG4E48K</p>	<p>\$133.99</p>	<p>1</p>	<p>\$133.99</p>
<p>① Usually ships in 1-2 business days</p>				
	<p>Halifax CH0448 Package Type 2 Condensate Hood System - 4' x 48" #421CHP448</p>	<p>\$2,948.00</p>	<p>1</p>	<p>\$2,948.00</p>
<p>① Item ships via Common Carrier ① Usually ships in 5-7 business days</p>				

Exhaust Fan Mounting Curb Type: Roof (Flat)

How Many Stories Is Your Building?: 1 story

Wall Panels: (1) 48" x 84" uninsulated stainless steel panel [Remove Accessory](#)

What is Your Ceiling Height?: Less than 10' (Low Ceiling Hood Needed)

Subtotal

\$17,095.46

Leasing available for as low as \$392.04/mo. ?

You're saving \$2,357.00 because you have membership!

Ship to: 34470 - Commercial

Shipping

Common Carrier + Liftgate ?

\$970.97

Common Carrier ?

\$915.97

Next & Second Day orders received after 2:00 PM Eastern Time will be processed on the following business day.

Add a Coupon Code

We accept



As low as \$1697/month
Select Credit Key at checkout

Other ways to pay

Sign up for our emails

Don't miss out on exclusive offers & more!

First name *

Last name *

Email *

Subscribe

717-392-7261

Email Us

Quick Picks

Chat Online

Track Order



Information

Customer Service

My Account

Webstraunt (bid) OK

Kitchen Equipment

The Restaurant Store (bid) OK

Equipment

Halifax FTHI940 9'x40" Type 1
concession trailer / food truck
hood system with integrated fan
Regency 66" 16 gauge stainless
steel three compartment
commercial sink with stainless
steel legs, cross bracing, and two
drainboards
Skeelton PQ828 20"x16"x12" 18
gauge 304 stainless steel one
compartment floor mop sink
Regency 17"x15" wall mounted
hand sin with gooseneck faucet
and wrist blades
T&S HG-4E-48K Safe T Link 48"
quick disconnect gas appliance
connector 1" NPT with installation
kit
Garland G60-4G36RR Natural Gas
4 burner 60" Range with 36"
griddle and 2 standard ovens
262,000 BTU
Halifax CHO448 Package type 2
condensate hood system 4'x48"
Shipping

Price

Equipment

Halifax FTHI940 9'x40" Type 1
concession trailer / food truck
4,108 hood system with integrated fan
Advance Tabco FE-3-1416-12RL
Space saver stainless steel 3
compartment sink with two
579 drainboards 66"
Skeelton PQ828 20"x16"x12" 18
gauge 304 stainless steel one
278 compartment floor mop sink
Regency 17"x15" wall mounted
hand sin with gooseneck faucet
159 and wrist blades
T&S HG-4E-48K Safe T Link 48"
quick disconnect gas appliance
connector 1" NPT with installation
132 kit
Garland G60-4G36RR Natural Gas
4 burner 60" Range with 36"
griddle and 2 standard ovens
8,149 262,000 BTU
Halifax CHO448 Package type 2
2,948 condensate hood system 4'x48"
16,353
1047
17,400

Price

4,108

769

279

160

134

8,697

2,948

17,095

970

18,065