

✓ 12/88

(old parcel#)
new parcel # 7/89 (A)

STATE OF FLORIDA
DEPARTMENT OF STATE
Division of Archives, History
and Records Management
DS-HSP-3AAA Rev. 3-79

FLORIDA MASTER SITE FILE Site Inventory Form

FDAHRM 802 ==
1009 ==

Site No. (51836) 2820-031-008
Survey Date 8303 820 ==
905 ==

Site Name _____
Address of Site: 520 S.E. Wenona Ave.
Instruction for locating 520 S.E. Wenona Ave. 813 ==
Ocala, Fla. 32671 868 ==

Location: Caldwells Ad Ocala E. 150' of S. 107' of Lot 31
subdivision name block no. lot no. 808 ==

County: Marion

Owner of Site: Name: Leist, Kenneth + AIA
Address: 520 S.E. Wenona Ave. 902 ==
Ocala, Fla. 32671 832 ==

Type of Ownership Private 848 == Recording Date _____

Recorder: Tate, Susan (Preservation Architect)

Name & Title: _____
Address: University of Florida, College of Architecture 818 ==
Gainesville, Fla. 32611 838 ==

Condition of Site: Integrity of Site: Original Use Residence 850 ==

<p>Check One</p> <p><input type="checkbox"/> Excellent 863 ==</p> <p><input checked="" type="checkbox"/> Good 863 ==</p> <p><input type="checkbox"/> Fair 863 ==</p> <p><input type="checkbox"/> Deteriorated 863 ==</p>	<p>Check One or More</p> <p><input checked="" type="checkbox"/> Altered 858 ==</p> <p><input type="checkbox"/> Unaltered 858 ==</p> <p><input checked="" type="checkbox"/> Original Site 858 ==</p> <p><input type="checkbox"/> Restored () (Date: X) 858 ==</p> <p><input type="checkbox"/> Moved () (Date: X) 858 ==</p>	<p>Present Use <u>Residence</u> 850 ==</p> <p>Dates: Beginning <u>C+ 1943</u> 844 ==</p> <p>Culture/Phase <u>American</u> 840 ==</p> <p>Period <u>20th Century</u> 845 ==</p>
--	--	---

NR Classification Category: Building 916 ==

Threats to Site:

Check One or More

<input checked="" type="checkbox"/> Zoning (X) 878 ==	<input type="checkbox"/> Transportation (X) 878 ==
<input checked="" type="checkbox"/> Development (X) 878 ==	<input type="checkbox"/> Fill (X) 878 ==
<input type="checkbox"/> Deterioration (X) 878 ==	<input type="checkbox"/> Dredge (X) 878 ==
<input type="checkbox"/> Borrowing (X) 878 ==	
<input type="checkbox"/> Other (See Remarks Below): _____ 878 ==	

910 ==

Areas of Significance: _____

Significance:

This is a typical small frame residence. It is in Caldwell's Ad Ocala platted in 1880 and was built in 1943 according to the Property Record Cards at the Tax Assessor's Office.

911 ==

ARCHITECT _____ 872 = =
 BUILDER _____ 874 = =
 STYLE AND/OR PERIOD Frame vernacular 964 = =
 PLAN TYPE Rectangular 966 = =
 EXTERIOR FABRIC(S) Wood siding 854 = =
 STRUCTURAL SYSTEM(S) Wood frame 856 = =
 PORCHES _____ 942 = =
 FOUNDATION: Masonry 942 = =
 ROOF TYPE: Gable 942 = =
 SECONDARY ROOF STRUCTURE(S): Gable 942 = =
 CHIMNEY LOCATION: Center ridge 942 = =
 WINDOW TYPE: 6/6 DHS 942 = =
 CHIMNEY: Brick 882 = =
 ROOF SURFACING: Hexagonal composition 882 = =
 ORNAMENT EXTERIOR: _____ 882 = =
 NO. OF CHIMNEYS One 952 = = NO. OF STORIES One 950 = =
 NO. OF DORMERS _____ 954 = =
 Map Reference (incl. scale & date) _____ 809 = =
 Latitude and Longitude: _____ 800 = =
 Site Size (Approx. Acreage of Property): _____ 833 = =

LOCATION SKETCH OR MAP

S.E. 5th Street

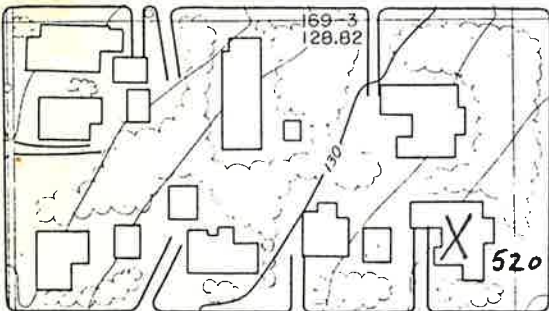

S.E. 6th Street

Township	Range	Section
15S	22E	SW1/4 17

812 = =

UTM Coordinates:

Zone Easting Northing

890 = =

Photographic Records Numbers

83 N 418 #14 (17,18)

Contact Print

