

CASE MAP

P&Z Meeting: September 9, 2024

Case Number:

Parcel:

Property Size:

Land Use Designation:

Zoning:

Proposal:

ZON24-45752

2920-010-008

Approximately 4.63 acres

Low Intensity Institutional

A request to rezone from Institutional to B-2A Limited Community Business

Location Map

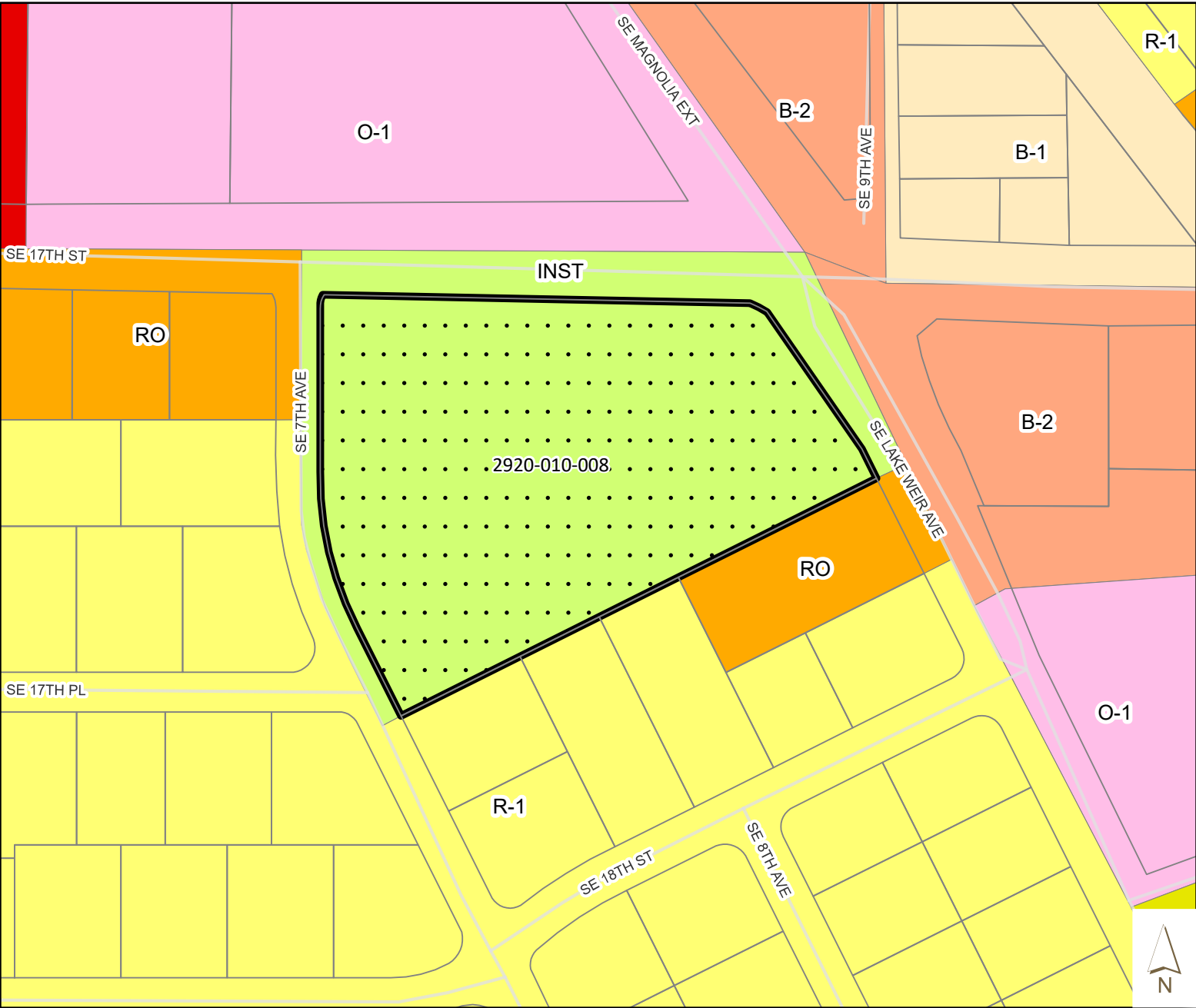
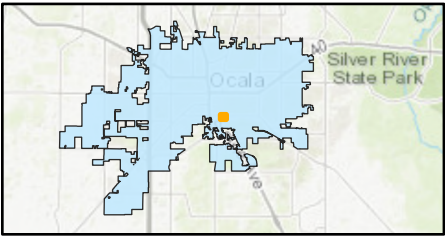

- Subject Property
- Parcels
- B-1:Neighborhood Business
- B-2:Community Business
- INST:Institutional
- O-1:Office
- R-1:Single Family Residential
- R-3:Multi-Family Residential
- RO:Residential Office
- SC:Shopping Center



Prepared by the City of Ocala  
Growth Management Department  
by kwirthin on 8/5/2024